



Chipsmall Limited consists of a professional team with an average of over 10 year of expertise in the distribution of electronic components. Based in Hongkong, we have already established firm and mutual-benefit business relationships with customers from,Europe,America and south Asia,supplying obsolete and hard-to-find components to meet their specific needs.

With the principle of “Quality Parts,Customers Priority,Honest Operation,and Considerate Service”,our business mainly focus on the distribution of electronic components. Line cards we deal with include Microchip,ALPS,ROHM,Xilinx,Pulse,ON,Everlight and Freescale. Main products comprise IC,Modules,Potentiometer,IC Socket,Relay,Connector.Our parts cover such applications as commercial,industrial, and automotives areas.

We are looking forward to setting up business relationship with you and hope to provide you with the best service and solution. Let us make a better world for our industry!



Contact us

Tel: +86-755-8981 8866 Fax: +86-755-8427 6832

Email & Skype: info@chipsmall.com Web: www.chipsmall.com

Address: A1208, Overseas Decoration Building, #122 Zhenhua RD., Futian, Shenzhen, China



NOTES:

REFERENCE STANDARD IEC60169-11

I. ELECTRICAL PERFORMANCE -

NOMINAL IMPEDANCE : 50±2 Ω
FREQUENCY RANGE : DC-3.0 GHz
VSWR : 1.150 MAX.
PIM : -160 dBc MAX. (2x43dBm)
INSERTION LOSS : 0.050 dB MAX. (@ 3.0 GHz)
INSULATION RESISTANCE : 5000 MΩ MIN.
D.W.V : 2500 VRMS
CONDUCTOR RESISTANCE : OUTER CONDUCTOR 1.0 mΩ MAX.
INNER CONDUCTOR 0.5 mΩ MAX.

II. MECHANICAL PERFORMANCE -

(NUT) TORQUE : 10-12 N.m
(NUT) WHORL PULL : 500 N
TENSILE FORCE(CABLE-CONNECTOR) : 500 N
TORSION(CABLE-CONNECTOR) : 4 N-m

III. MATERIAL AND PLATING -

INNER CONDUCTOR : SPRING BRONZE ALLOY, PLATING = Ag (5µm MIN.)
OUTER CONDUCTOR : BRASS, PLATING = COPPER-TIN-ZINC (2µm MIN.)
NUT : BRASS, PLATING = NI (5µm MIN.)
GASKET : SILICONE RUBBER
INSULATOR : PTFE

IV. ENVIRONMENTAL -

TEMP RANGE : -40°C TO +85°C
WEATHER STANDARD : IEC 60068 40/ 085/ 21
THERMAL SHOCK : IEC 60068-2-14-NA
VIBRATION : IEC 60068-2-6-FC
SHOCK : IEC 60068-2-27
WATERPROOFING STANDARD : IP67

V. ASSEMBLY : INNER AND OUTER CONDUCTOR INSTALLED

VI. ROHS COMPLIANT

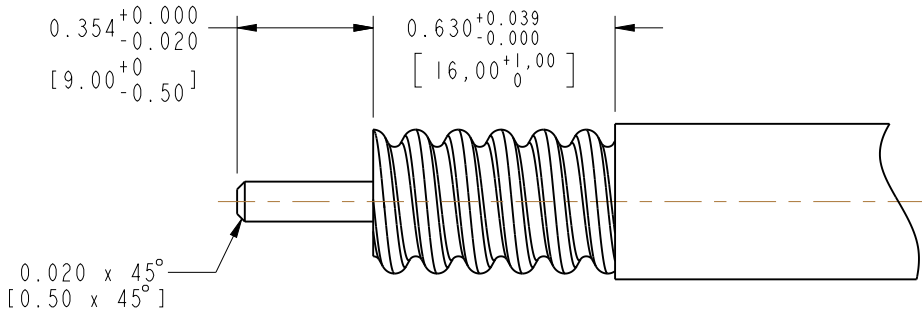

RECOMMENDED CABLE STRIPPING DIMENSIONS

332113		REVISIONS			
DRAWING NO.	REV	DESCRIPTION	DATE	ECO	APPR
THIRD ANGLE PROJ.	A	RELEASE TO MFG.	03-Jan-14	--	AAP/BG

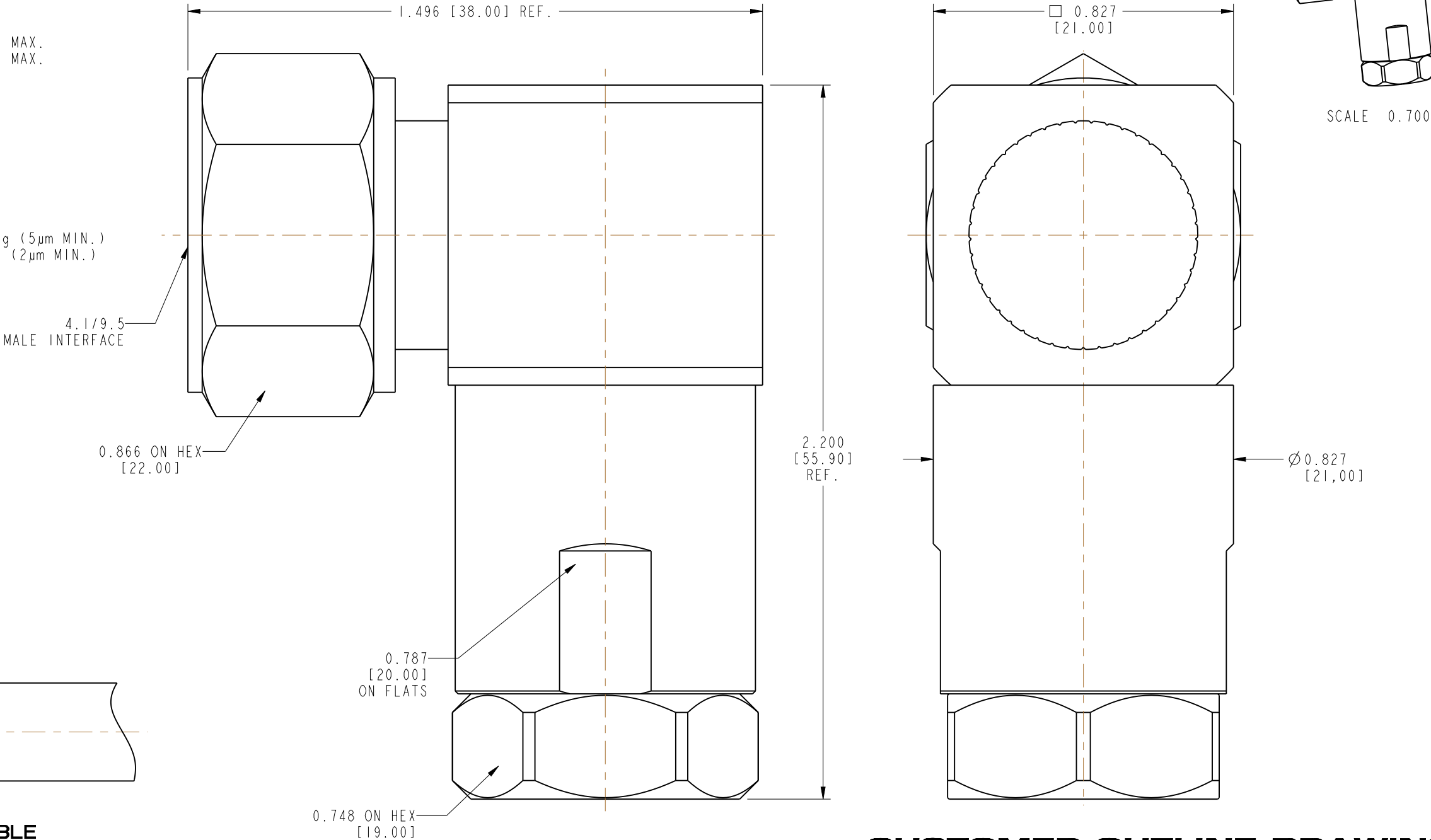

CUSTOMER OUTLINE DRAWING
ALL OTHER SHEETS ARE FOR INTERNAL USE ONLY

UNLESS OTHERWISE SPECIFIED, DIMENSIONS ARE IN INCHES AND TOLERANCES ARE: 2 PLACE DECIMAL ±.015 (0,381 mm) 3 PLACE DECIMAL ±.005 (0,127 mm) ANGLES ± 1°	MATERIAL	DRAWN	DATE	TITLE 4.1/9.5 MALE RIGHT ANGLE FOR 1/2" H CABLE	Amphenol Connex		
	SEE NOTES	ENGINEER	DATE				
	REFERENCE	APPROVED	DATE				
		B.C. GLEISSNER	03-Jan-14	SCALE: 3.0:1		SHEET	1 OF 1
NOTICE - These drawings, specifications, or other data (1) are, and remain the property of Amphenol Corp. (2) must be returned upon request; and (3) are confidential and not to be disclosed to any person other than those to whom they are given by Amphenol Corp. The furnishing of these drawings, specifications, or other data by Amphenol Corp., or to any other person to anyone for any purpose is not to be regarded by implication or otherwise in any manner licensing, granting rights or permitting such holder or any other person to manufacture, use or sell any product, process or design, patented or otherwise, that may in any way be related to or disclosed by said drawings, specifications, or other data.		CAD FILE		DWG SIZE	DRAWING NO.	REV	
				B	332113	A	