



Chipsmall Limited consists of a professional team with an average of over 10 year of expertise in the distribution of electronic components. Based in Hongkong, we have already established firm and mutual-benefit business relationships with customers from,Europe,America and south Asia,supplying obsolete and hard-to-find components to meet their specific needs.

With the principle of “Quality Parts,Customers Priority,Honest Operation,and Considerate Service”,our business mainly focus on the distribution of electronic components. Line cards we deal with include Microchip,ALPS,ROHM,Xilinx,Pulse,ON,Everlight and Freescale. Main products comprise IC,Modules,Potentiometer,IC Socket,Relay,Connector.Our parts cover such applications as commercial,industrial, and automotives areas.

We are looking forward to setting up business relationship with you and hope to provide you with the best service and solution. Let us make a better world for our industry!



Contact us

Tel: +86-755-8981 8866 Fax: +86-755-8427 6832

Email & Skype: info@chipsmall.com Web: www.chipsmall.com

Address: A1208, Overseas Decoration Building, #122 Zhenhua RD., Futian, Shenzhen, China





Made in the United States of America



Conductive C-Type Connector Cover Features:

Conductive Composite

Permanently volume conductive and free of carbon black particulate. The connector covers do not leave black marks and are more suited to clean situations. Meets the requirements of NASM5501 31/32.

Noncorrosive

Connector covers are noncorrosive and produce no visible corrosion when tested to Federal Test Method 101C using Kovar test plates.

Conformability

The material used in the covers was selected for its resilience. Properly sized, the covers provide a snug, secure fit. This helps keep connectors clean and prevents the cover from accidentally falling off.

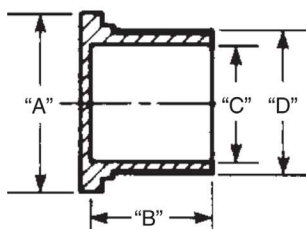
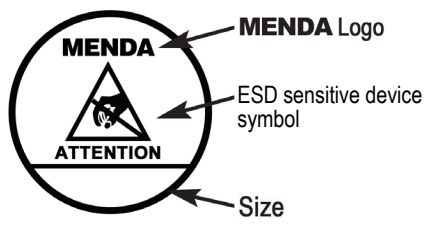

Unless otherwise noted, tolerance ± 10%
Specifications and procedures subject to change without notice.

"It should be understood that any object, item, material or person could be a source of static electricity in the work environment. Removal of unnecessary nonconductors, replacing nonconductive materials with dissipative or conductive materials and grounding all conductors are the principle methods of controlling static electricity in the workplace, regardless of the activity." [ESD Handbook ESD TR20.20; section 2.4 Sources of Static Electricity]

Item No.	Size	"A"	"B"	"C"	"D"
Packaged 50/pack; 10 packs/case					
34216	20R	1.465	0.562	1.231	1.301
34217	20Y	1.406	0.625	1.15	1.215
34218	22R	1.59	0.562	1.34	1.41
34219	22Y	1.5	0.625	1.27	1.34
34220	24R	1.7	0.562	1.463	1.533
34221	24Y	1.64	0.625	1.39	1.46
34222	25Y	1.81	0.625	1.54	1.58
34223	28R	1.95	0.562	1.715	1.79
34224	28Y	1.875	0.625	1.645	1.718

Item No.	Size	"A"	"B"	"C"	"D"
Packaged 25/pack; 10 packs/case					
34225	32R	2.22	0.562	1.965	2.04
34226	32Y	2.125	0.625	1.89	1.97
34227	36R	2.435	0.6	2.215	2.29
34228	36Y	2.34	0.625	2.14	2.21

Chemical Susceptibility*	Reactions
Dilute Acids	Slight Attack
Dilute Alkalines	Slight Attack
Concentrated Acids	Slight Attack
Concentrated Alkalines	Slight Attack
Methanol, Ethanol, Isopropanol	Resistant
Hydrocarbons	Slight Attack
Ketones	Slight Attack
Oil and Gasoline	Slight Attack

*ASTM F925

Item No.	Size	"A"	"B"	"C"	"D"
Packaged 100/ pack; 10 packs/case					
34205	10R	0.84	0.5	0.605	0.665
34206	10Y	0.75	0.625	0.53	0.595
34207	12R	0.97	0.5	0.72	0.755
34208	12Y	0.86	0.625	0.655	0.715
34209	14R	1.125	0.5	0.85	0.905
34210	14Y	1.031	0.625	0.785	0.845
34211	16R	1.22	0.5	0.973	1.035
34212	16Y	1.125	0.625	0.893	0.963
34213	18R	1.33	0.562	1.093	1.155
34214	18Y	1.25	0.625	1.28	1.088
31215	19R	1.4	0.562	1.125	1.213
34229	4R	0.67	0.5	0.25	0.336
34230	5R	0.67	0.5	0.313	0.399
34231	6R	0.67	0.5	0.375	0.461
34232	8R	0.74	0.5	0.48	0.54
34233	8Y	0.67	0.625	0.413	0.483
34234	9R	0.75	0.5	0.5	0.586

Material Properties	Test Method	Typical Value
Resistance	ASTM D991	<10 ⁵ ohms
Contact Corrosivity	FTM 101C Method 3005 (Kovar plate)	Pass
Elongation	ASTM D638	24%
Tensile	ASTM D638	2700 psi
Vicat Softening	ASTM MD 1525	85° C
Outgassing	ASTM E595	Pass

CONDUCTIVE C-TYPE CONNECTOR COVERS

3651 WALNUT AVE., CHINO, CA 91710
PHONE: (909) 627-2453
WEBSITE: MendaPump.com

DRAWING NUMBER
34205

DATE:
Jan.
2016

