



Chipsmall Limited consists of a professional team with an average of over 10 year of expertise in the distribution of electronic components. Based in Hongkong, we have already established firm and mutual-benefit business relationships with customers from,Europe,America and south Asia,supplying obsolete and hard-to-find components to meet their specific needs.

With the principle of “Quality Parts,Customers Priority,Honest Operation,and Considerate Service”,our business mainly focus on the distribution of electronic components. Line cards we deal with include Microchip,ALPS,ROHM,Xilinx,Pulse,ON,Everlight and Freescale. Main products comprise IC,Modules,Potentiometer,IC Socket,Relay,Connector.Our parts cover such applications as commercial,industrial, and automotives areas.

We are looking forward to setting up business relationship with you and hope to provide you with the best service and solution. Let us make a better world for our industry!



## Contact us

Tel: +86-755-8981 8866 Fax: +86-755-8427 6832

Email & Skype: [info@chipsmall.com](mailto:info@chipsmall.com) Web: [www.chipsmall.com](http://www.chipsmall.com)

Address: A1208, Overseas Decoration Building, #122 Zhenhua RD., Futian, Shenzhen, China



DRAWING MADE IN THIRD ANGLE PROJECTION

THIS DRAWING IS UNPUBLISHED.

RELEASED FOR PUBLICATION

, 19

© COPYRIGHT 19

BY AMP INCORPORATED.

ALL INTERNATIONAL RIGHTS RESERVED.

AMP PART NUMBER	PACKAGE TYPE	QTY
8-35185-3	LOOSE PIECE, BOX	25
8-35185-5	LOOSE PIECE, BAG	10

LOC	DIST	P	F	ZONE	LTR	DESCRIPTION	DATE	APPD
G	14				F	REVISED PER 0L20-0045-97	24MAR97	OKS CHK

<b>AMP</b> WIRE RANGE	E13288 Listed
2 AWG SOLID OR STRANDED	2 AWG STRANDED
LR7189 Certified	MILITARY P/N AND CLASS
2 AWG SOLID OR STRANDED	NOT APPLICABLE

- 1 STAMP AMP 2W\* APPROX AS SHOWN
- 2 STAMP 60-75 APPROX AS SHOWN
- 3 SEE RESTRICTED CUSTOMER DRAWING 2-35185-3

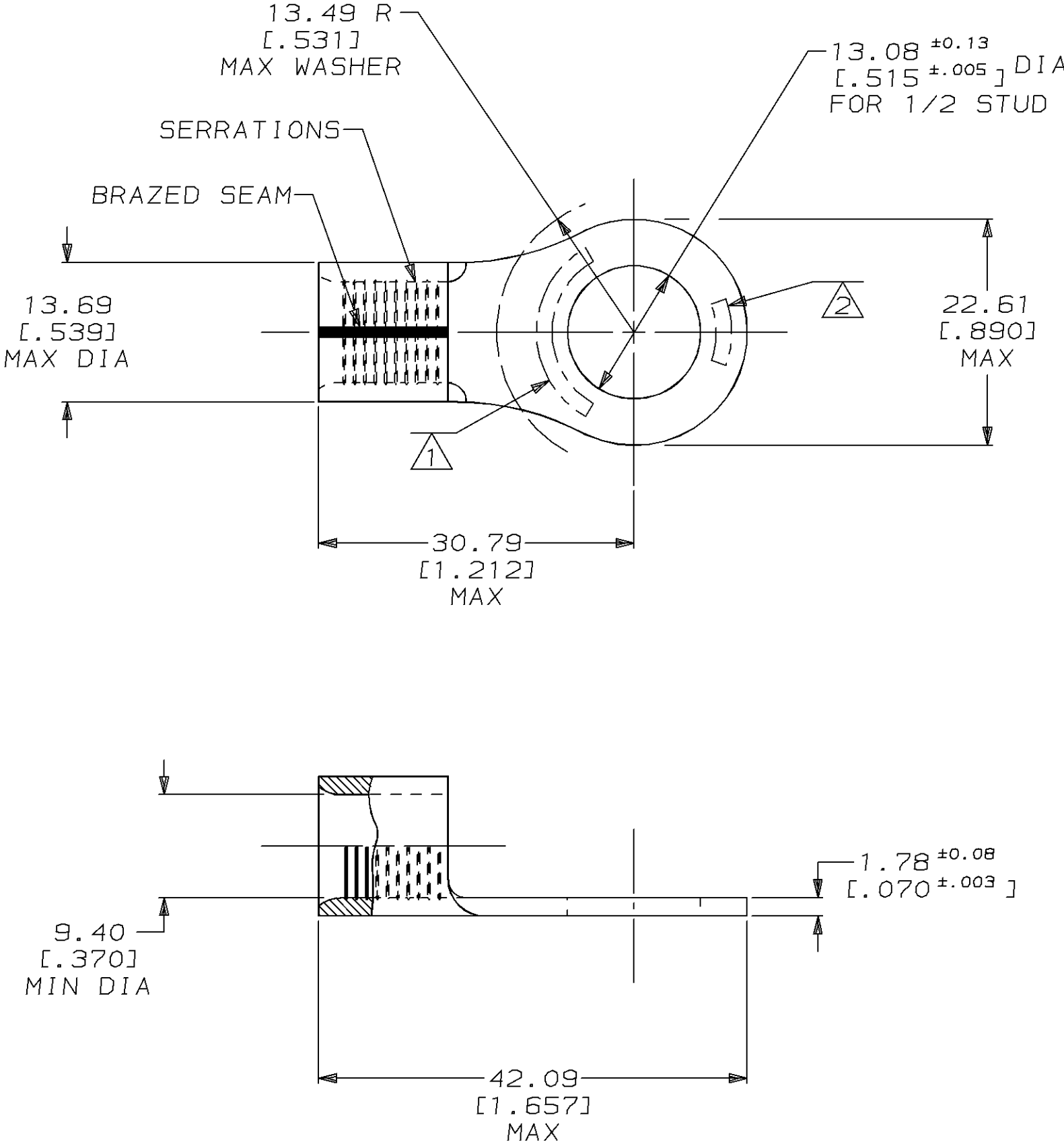

AMP INCORPORATED  
CUSTOMER SERVICE SYSTEMS

FOR ADDITIONAL PRODUCT INFORMATION OR COPIES OF DRAWINGS AND TECHNICAL DOCUMENTS	PRODUCT INFORMATION CENTER 1-800-522-6752
FOR APPLICATION TOOLING INFORMATION	TOOLING ASSISTANCE CENTER 1-800-722-1111
FOR ORDER ENTRY	1-800-526-5142

MAX RECOMMENDED OPERATING  
TEMPERATURE:  
170°C MAX

VOLTAGE RATING:  
NOT APPLICABLE

CIRCULAR MIL AREA:  
26.7-42.4mm² [52,600-83,700] CIR MILS  
SOLID OR STRANDED

THIS DRAWING IS A CONTROLLED DOCUMENT FOR  
AMP INCORPORATED. IT IS SUBJECT TO CHANGE  
AND THE CONTROLLING ENGINEERING ORGANIZATION  
SHOULD BE CONTACTED FOR THE LATEST REVISION.

DO NOT SCALE PRINT.  
UNLESS SPECIFIED  
DIMENSIONS IN mm [INCHES]  
TOLERANCES ON :  
2 PLC DEC ± 0.20[.008]  
3 PLC DEC ± -  
ANGLES ± -

MATERIAL  
COPPER ASTM B-152  
ANNEALED

FINISH  
TIN PLATE  
0.00254[.000100] MIN  
THK PER MIL-T-10727

DR 5/18/93  
DK SCHRUM

CHK 1/27/94  
RD HEIM

APPD 1/27/94  
RE ROSER

APPD 1/27/94  
JL MECKLEY

PRODUCT SPEC  
-

APPLICATION SPEC  
-

WEIGHT -

3	-	2-35185-3
	2	35185
	FINISH	PART NO
<div><div>AMP</div><div>AMP Incorporated Harrisburg, PA 17105-3608</div></div>		
NAME TERMINAL, RING TONGUE, SOLISTRAND™		
SIZE C	CAGE CODE 00779	DRAWING NO C-35185
SCALE 2:1		SHEET 1 OF 1