



Chipsmall Limited consists of a professional team with an average of over 10 year of expertise in the distribution of electronic components. Based in Hongkong, we have already established firm and mutual-benefit business relationships with customers from,Europe,America and south Asia,supplying obsolete and hard-to-find components to meet their specific needs.

With the principle of “Quality Parts,Customers Priority,Honest Operation,and Considerate Service”,our business mainly focus on the distribution of electronic components. Line cards we deal with include Microchip,ALPS,ROHM,Xilinx,Pulse,ON,Everlight and Freescale. Main products comprise IC,Modules,Potentiometer,IC Socket,Relay,Connector.Our parts cover such applications as commercial,industrial, and automotives areas.

We are looking forward to setting up business relationship with you and hope to provide you with the best service and solution. Let us make a better world for our industry!



Contact us

Tel: +86-755-8981 8866 Fax: +86-755-8427 6832

Email & Skype: info@chipsmall.com Web: www.chipsmall.com

Address: A1208, Overseas Decoration Building, #122 Zhenhua RD., Futian, Shenzhen, China



inspired LED 8mm iDea Series Panels on Demand



The **iDea Series LED System** offers a variety of quick convenient solutions for designing, installing, and modifying LED systems in field. Simply cut LED flex strips to length, add connectors, lay the LEDs along an aluminum channel, and snap your choice of covers in to place. Creating custom LED fixtures has never been easier than with the innovative iDea Series LED system from Inspired LED.

Product Features:

- CSA listed, sleek, lightweight design
 - Compatible with range of flexible LED colors & brightness levels
 - Simple connectors allow flex to be cut & built to custom lengths
 - Frosted white or clear lens covers
 - Clip, screw, or adhesive mounting options
 - Can be weatherproofed in-field with addition of GE Lifetime Rated Silicone
- To be installed in accordance with NEC, using Class 2 power supply only**

Step 1: Cut

Select Inspired LED flex strips in the brightness level and color of your choosing, then cut to length on copper solder pads!

Normal Bright (120 LED/m) 12V-NB-XX
best for subtle accent or task lighting

Super Bright (120 LED/m) 12V-SB-XX
best value accent or task lighting

Ultra Bright (120 LED/m) 12V-UB-XX
perfect for task lighting

Mega Bright (120 LED/m) 12V-MB-XX
for areas where too much light is just right!



Step 2: Connect

Attach iDea series **end-connectors** to connect to wire

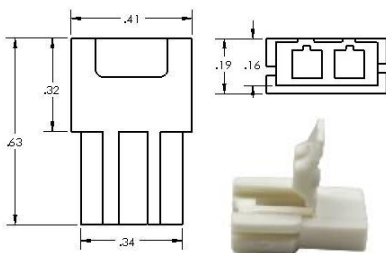

Size: 0.42" x 0.63" x 0.19"
Screw Terminal Size: Fits 18-22 AWG
SKU#: 3587 (single) 3563 (bag of 25)
Compatible with Inspired LED 12V Flex Only

1 Open connector locking cap and peel adhesive liner from flexible LED strip.



2 Insert flexible LED strip into LED input channel of connector.



3 Close locking cap until the snap of the connector is heard. The snapping sound indicates the locking cap has been properly terminated.



4 Identify polarity on LED strip. Polarity is marked throughout the length of the flexible LED strip. Use a red sharpie to mark polarity on connector.



5 Strip 18-22AWG cable and match polarity between LED connector and cable.



6 Poke cable leads into wire holes of connector making sure the positive polarity matches the positive input hole of connector.



NOTE: Connectors are not assigned polarity. Polarity must be defined by user. Look throughout the length of the strip to identify polarity, it may not be indicated exactly at each cut point. Check termination by tugging on the cable leads and LED flex to insure tight connections. Cable should be difficult to remove when properly terminated.



inspiredled.com



orders@inspiredled.com



(480) 941-4286

Step 2: Connect (Part II)

Attach iDea series flex-extenders to connect LED flex strips end to end

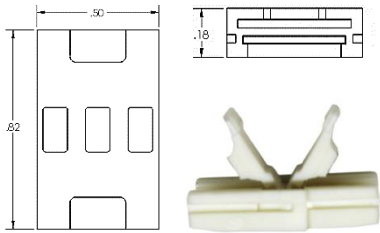

Size: 0.82" x 0.5" x 0.18"

Screw Terminal Size: Fits 18-22 AWG

SKU#: 3588 (single) 3564 (bag of 5)

Compatible with Inspired LED 12V Flex Only

- 1 To connect LED flex strips end-to-end, begin by matching polarity between joining LED strips



- 3 Assign polarity on flex-extender using a red pen



- 2 Open locking caps on each side of flex-extender



- 4 Insert LED flex into either side of flex-extender, matching polarity, then firmly snap each end shut, using pliers if needed



Step 3: Panelize

Create an on-demand fixture in just minutes using aluminum extrusion and snap-on lenses



- 1 Aluminum Channel (6'): 3565

Lay flex along aluminum channel with end connectors hanging over edge & cut to length

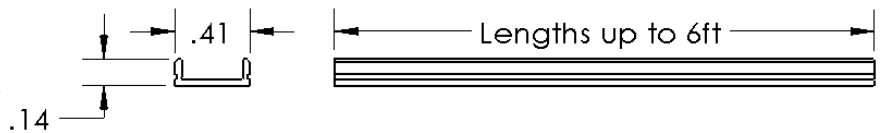

- 2 Polycarbonate Covers (6'): 3566

Snap cover over aluminum & end connectors, cut to length



White 3566-W



Clear 3566-C

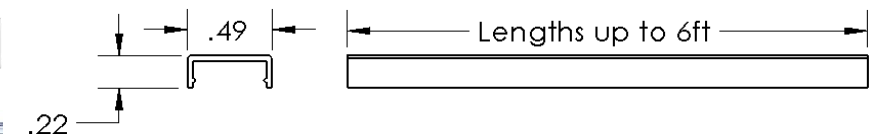

- 3 Mounting Clips/Screws (10/bag): 3567

Screw into desired location, then secure iDea series panel in place

