



Chipsmall Limited consists of a professional team with an average of over 10 year of expertise in the distribution of electronic components. Based in Hongkong, we have already established firm and mutual-benefit business relationships with customers from,Europe,America and south Asia,supplying obsolete and hard-to-find components to meet their specific needs.

With the principle of “Quality Parts,Customers Priority,Honest Operation,and Considerate Service”,our business mainly focus on the distribution of electronic components. Line cards we deal with include Microchip,ALPS,ROHM,Xilinx,Pulse,ON,Everlight and Freescale. Main products comprise IC,Modules,Potentiometer,IC Socket,Relay,Connector.Our parts cover such applications as commercial,industrial, and automotives areas.

We are looking forward to setting up business relationship with you and hope to provide you with the best service and solution. Let us make a better world for our industry!



Contact us

Tel: +86-755-8981 8866 Fax: +86-755-8427 6832

Email & Skype: info@chipsmall.com Web: www.chipsmall.com

Address: A1208, Overseas Decoration Building, #122 Zhenhua RD., Futian, Shenzhen, China



Rear horizontal rail, centre (E)



When subdividing 6 U into 2 x 3 U, the adaptor rail accommodates the guide rails when fastened to the centre horizontal rail.

- HP pitch pattern of holes for the precise installation of guide rails
- M4 and M2.5 thread on the end face
- Straight-through core hole
- Horizontal rail 192 HP without machining on the end faces. Suitable for cutting to length

Material:

Extruded aluminum section

Surface finish:

Clear-chromated or anodized

Usable width (HP)	Packs of	Order No.
12	1	3684.587
16	1	3684.588
20	1	3684.589
40	1	3684.964
42	1	3684.590
63	1	3686.005
84	1	3684.591
84	1	3685.272¹⁾
858.5 mm	1	3684.584
192	1	3688.004²⁾

¹⁾ Including 2 assembly screws

²⁾ Anodized

! Also required:

Assembly screws M4 x 12, packs of 100, order no. 3654.300, see page 164

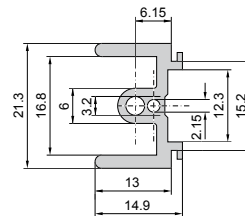
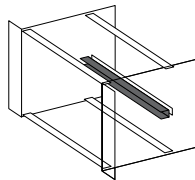

Rear horizontal rail, with channel for Ripac ECO (C7)



To accommodate guide rails and for the attachment of Z rails, insulating strips or conductive strips.

- HP pitch pattern of holes for the precise installation of guide rails
- Channel for slide-in covers
- For mounting backplanes/Z rails, threaded inserts (3684.610) are additionally required
- M4 thread on end face
- Straight-through core hole
- Not suitable for mounting under covers

Material: Extruded aluminum section

Surface finish: Clear-chromated

Usable width (HP)	Packs of	Order No.
84	1	3688.104

! Also required:

Assembly screw M4 x 12

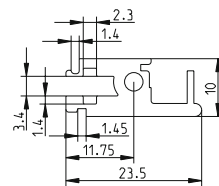

Rear horizontal rail, with integral Z rail for Ripac ECO (C8)



To accommodate guide rails. Integral Z rail for mounting connectors to DIN 41612.

- HP pitch pattern of holes for the precise installation of guide rails
- 84 tapped holes M2.5 for connector mounting
- M4 thread on end face
- Straight-through core hole

Material:

Extruded aluminum section

Surface finish:

Clear-chromated

Usable width (HP)	Packs of	Order No.
84	1	9901.991

! Also required:

Assembly screws

	Packs of	Order No.
M4 x 12	100	3654.300

