



Chipsmall Limited consists of a professional team with an average of over 10 year of expertise in the distribution of electronic components. Based in Hongkong, we have already established firm and mutual-benefit business relationships with customers from,Europe,America and south Asia,supplying obsolete and hard-to-find components to meet their specific needs.

With the principle of “Quality Parts,Customers Priority,Honest Operation,and Considerate Service”,our business mainly focus on the distribution of electronic components. Line cards we deal with include Microchip,ALPS,ROHM,Xilinx,Pulse,ON,Everlight and Freescale. Main products comprise IC,Modules,Potentiometer,IC Socket,Relay,Connector.Our parts cover such applications as commercial,industrial, and automotives areas.

We are looking forward to setting up business relationship with you and hope to provide you with the best service and solution. Let us make a better world for our industry!



Contact us

Tel: +86-755-8981 8866 Fax: +86-755-8427 6832

Email & Skype: info@chipsmall.com Web: www.chipsmall.com

Address: A1208, Overseas Decoration Building, #122 Zhenhua RD., Futian, Shenzhen, China



Injector/extractor handle type VII

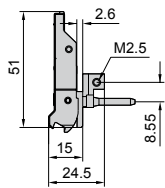

Plastic (telecom)

For inserting and removing connectors with a large number of pins. This handle was specifically designed for use in telecom applications.

- Insertion/removal function
- Optionally with ½ HP offset PCB attachment, e. g. for component mounting on both sides
- Minimum front space requirements, due to foldup handle
- Keyable
- Optional integral micro-switch for "live insertion" applications
- ESD pin to dissipate static charges prior to making contact with the connectors and for precise positioning of the board type plug-in unit
- Large labelling area on the front

Material:

Plastic

Supply includes:

Assembly parts.

Note:

Insertion only when used with front horizontal rails, with 10 mm extension (B, B1, B2), see page 109-110

Handles without offset

Installation	Packs of	Order No.
top	1	3688.784
bottom	1	3688.785

Handles with ½ HP offset

Installation	Packs of	Order No.
top	1	3688.780
bottom	1	3688.781

+ Accessories:

Keys, see page 124
 Keyable guide rails, see page 120
 Keyable guide rails with ½ HP offset, see page 121
 Micro-switches, see page 141
 Connector pin for buying, see page 139

Injector/extractor handle type VII

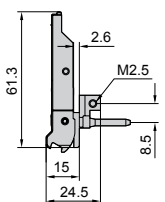

Metal (telecom)

For inserting and removing PCBs with a high connector pin-count (up to 815 N). This handle was specifically designed for use in telecom applications.

- Insertion/removal function
- Optionally with ½ HP offset PCB attachment, e. g. for component mounting on both sides
- Minimum front space requirements due to foldup handle
- Keyable
- Optional integral micro-switch for "live insertion" applications
- ESD pin to dissipate static charges prior to making contact with the connectors and for precise positioning of the board type plug-in unit
- Metal design for use in aggressive atmospheres

Material:

Die-cast zinc

Supply includes:

Assembly parts.

Note:

Insertion only when used with front horizontal rails, with 10 mm extension (B, B1, B2), see page 109-110

Handles without offset

Installation	Packs of	Order No.
top	1	3688.790
bottom	1	3688.791

Handles with ½ HP offset

Installation	Packs of	Order No.
top	1	3688.786
bottom	1	3688.787

+ Accessories:

Keys, see page 124
 Keyable guide rails, see page 120
 Keyable guide rails with ½ HP offset, see page 121
 Micro-switches, see page 141
 Connector pin for buying, see page 139

Micro-switch



For "live insertion" applications. Installation in injector/extractor handles, types IV, IVs and VII. May also be retrofitted.

Technical specifications:

Switching load: 50 mA 30 V DC
 Service life:
 At nominal load: 30.000
 mechanical: 50.000

Packs of	Order No.
10	3684.410

+ Also required:

Micro-switch mounting clip, see page 141