



Chipsmall Limited consists of a professional team with an average of over 10 year of expertise in the distribution of electronic components. Based in Hongkong, we have already established firm and mutual-benefit business relationships with customers from,Europe,America and south Asia,supplying obsolete and hard-to-find components to meet their specific needs.

With the principle of “Quality Parts,Customers Priority,Honest Operation,and Considerate Service”,our business mainly focus on the distribution of electronic components. Line cards we deal with include Microchip,ALPS,ROHM,Xilinx,Pulse,ON,Everlight and Freescale. Main products comprise IC,Modules,Potentiometer,IC Socket,Relay,Connector.Our parts cover such applications as commercial,industrial, and automotives areas.

We are looking forward to setting up business relationship with you and hope to provide you with the best service and solution. Let us make a better world for our industry!



## Contact us

Tel: +86-755-8981 8866 Fax: +86-755-8427 6832

Email & Skype: info@chipsmall.com Web: www.chipsmall.com

Address: A1208, Overseas Decoration Building, #122 Zhenhua RD., Futian, Shenzhen, China



# COMPONENTS / ACCESSORIES

## HORIZONTAL RAILS



### Rear horizontal rail, centre (D1)



When using 6 U PCBs or box-type plug-in units. Facility for the attachment of Z rails, insulating strips or conductive strips.

- 84 tapped holes M2.5
- M4 thread on end face
- Straight-through core hole
- Horizontal rail 192 HP for cutting to the required length

**Material:**  
Extruded aluminum section

**Surface finish:**  
Clear-chromated or anodized

Usable width (HP)	Packs of	Order No.
40	1	<b>3684.963</b>
42	1	<b>3684.580</b>
63	1	<b>3684.581</b>
84	1	<b>3684.582</b>
84	1	<b>3685.270<sup>1)</sup></b>
858.5 mm	1	<b>3684.579</b>
192	1	<b>3688.003<sup>2)</sup></b>

<sup>1)</sup> Including 2 assembly screws  
<sup>2)</sup> Anodized

#### ! Also required:

Assembly screws M4 x 12, packs of 100, order no. 3654.300, see page 164

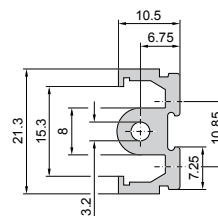
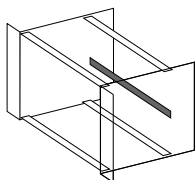

### Rear horizontal rail, centre, with integral Z rail (D2)



When using 6 U PCBs or box-type plug-in units. Integral Z rail for mounting connectors to IEC 60 603-2.

- 84 tapped holes M2.5
- M4 thread on end face
- Straight-through core hole

**Material:**  
Extruded aluminum section

**Surface finish:**  
Clear-chromated

Usable width (HP)	Packs of	Order No.
42	1	<b>3687.600</b>
63	1	<b>3687.601</b>
84	1	<b>3687.602</b>
858.5 mm	1	<b>3687.603</b>

#### ! Also required:

Assembly screws M4 x 12, packs of 100, order no. 3654.300, see page 164

