



Chipsmall Limited consists of a professional team with an average of over 10 year of expertise in the distribution of electronic components. Based in Hongkong, we have already established firm and mutual-benefit business relationships with customers from,Europe,America and south Asia,supplying obsolete and hard-to-find components to meet their specific needs.

With the principle of "Quality Parts,Customers Priority,Honest Operation,and Considerate Service",our business mainly focus on the distribution of electronic components. Line cards we deal with include Microchip,ALPS,ROHM,Xilinx,Pulse,ON,Everlight and Freescale. Main products comprise IC,Modules,Potentiometer,IC Socket,Relay,Connector.Our parts cover such applications as commercial,industrial, and automotives areas.

We are looking forward to setting up business relationship with you and hope to provide you with the best service and solution. Let us make a better world for our industry!



Contact us

Tel: +86-755-8981 8866 Fax: +86-755-8427 6832

Email & Skype: info@chipsmall.com Web: www.chipsmall.com

Address: A1208, Overseas Decoration Building, #122 Zhenhua RD., Futian, Shenzhen, China



Flange, 482.6 mm (19")

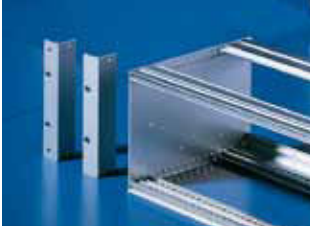

To fit all Ripac Vario, Ripac Vario EMC, Ripac Compact and Ripac Vario Mobile subracks. With integral channel to accommodate EMC gaskets.

Material:
Extruded aluminum section

Surface finish:
Clear-chromated

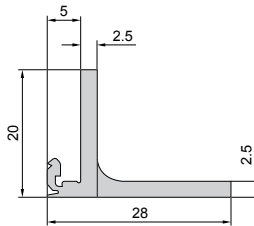
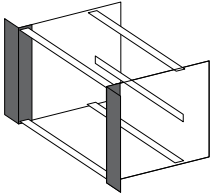

U	Packs of	Order No.	
		with handle holes	without handle holes
2	1	–	3684.614
3	1	3684.622	3684.615
4	1	3684.623	3684.616
6	1	3684.624	3684.617
7	1	3684.625	3684.618
9	1	–	3684.619
10	1	–	3684.620
11	1	–	3684.621

+ Accessories:

Handles for subrack,
see page 104
EMC gaskets, vertical,
see page 116

Flange, 482.6 mm (19")



Set-back
To fit all Ripac Vario, Ripac Vario EMC and Ripac Vario Mobile subracks.

Material:
Extruded aluminum section

Surface finish:
Clear-chromated

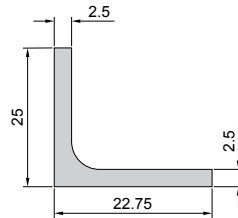
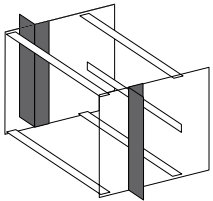

U	Packs of	Order No.
3	1	3684.626
4	1	3684.627
6	1	3684.628
7	1	3684.629
9	1	3684.630
10	1	3684.631
11	1	3684.632

! Also required:

Assembly screws, nuts and washers,
packs of 4 sets, order no. 3687.015,
see page 165

Side panels



For Ripac EASY

- Mounting holes on a 60 mm pitch pattern as long holes
- Drill holes for mounting telescopic slides

Material:

1.5 mm aluminum, noncorrosive

D mm	L2	n	n1	Packs of	Max. board depth mm	Order No.	
						3 U	6 U
175	–	–	–	2	160	3634.695	3634.720
235	60	–	–	2	220	3634.700	3634.725
295	60	2	2	2	280	3634.705	3634.730
355	60	3	3	2	340	3634.710	3634.735
415	60	4	3	2	400	3634.715	3634.740

+ Accessories:

Flanges for Ripac EASY
see page 104

- 1** Mounting holes suitable for threaded insert PEM-FM4-1

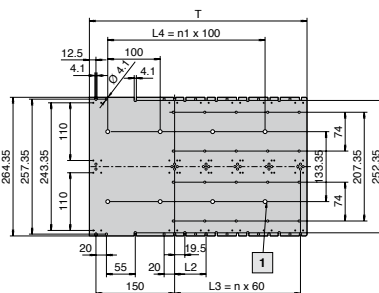
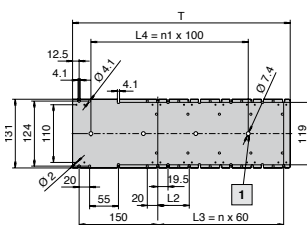

T = Depth