



Chipsmall Limited consists of a professional team with an average of over 10 year of expertise in the distribution of electronic components. Based in Hongkong, we have already established firm and mutual-benefit business relationships with customers from,Europe,America and south Asia,supplying obsolete and hard-to-find components to meet their specific needs.

With the principle of "Quality Parts,Customers Priority,Honest Operation,and Considerate Service",our business mainly focus on the distribution of electronic components. Line cards we deal with include Microchip,ALPS,ROHM,Xilinx,Pulse,ON,Everlight and Freescale. Main products comprise IC,Modules,Potentiometer,IC Socket,Relay,Connector.Our parts cover such applications as commercial,industrial, and automotives areas.

We are looking forward to setting up business relationship with you and hope to provide you with the best service and solution. Let us make a better world for our industry!



## Contact us

Tel: +86-755-8981 8866 Fax: +86-755-8427 6832

Email & Skype: info@chipsmall.com Web: www.chipsmall.com

Address: A1208, Overseas Decoration Building, #122 Zhenhua RD., Futian, Shenzhen, China



### Front horizontal rail (A)



To accommodate guide rails and for the attachment of front panels.

- Front projection 2.5 mm corresponding to IEC 60 297-3
- HP pitch pattern of holes for the precise installation of guide rails
- M4 thread on end face
- Straight-through core hole
- Horizontal rail 192 HP without machining on the end faces. Suitable for cutting to length

**Material:**

Extruded aluminum section

**Surface finish:**

Clear-chromated or anodized

Usable width (HP)	Packs of	Order No.
4 (left)	1	<b>3684.592</b>
4 (right)	1	<b>3684.955</b>
8 (left)	1	<b>3684.593</b>
8 (right)	1	<b>3684.956</b>
12	1	<b>3684.594</b>
16	1	<b>3684.595</b>
20	1	<b>3684.596</b>
21	1	<b>3685.985</b>
40	1	<b>3684.960</b>
42	1	<b>3684.560</b>
63	1	<b>3684.561</b>
84	1	<b>3684.562</b>
84	2	<b>3685.267<sup>1)</sup></b>
192	1	<b>3688.000<sup>2)</sup></b>

<sup>1)</sup> Including 4 assembly screws

<sup>2)</sup> Anodised

**! Also required:**

Assembly screws M4 x 12, packs of 100, order no. 3654.300, see page 164

**+ Accessories:**

Threaded inserts (packs of 1), see page 114

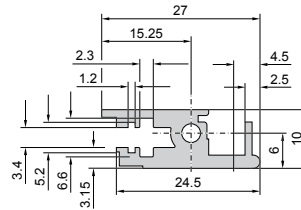
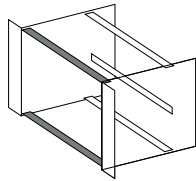

### Front horizontal rail, with double screw fastening (A1)



To accommodate guide rails and for the attachment of front panels. The double screw fastening ensures a high level of stability even under extreme loads.

- Load test to DIN EN/IEC 61 587-1, requirement level SL1
- Shock and vibration tests undertaken as per IEC 61 373 (DIN EN 50 155), Category 1, Class B
- Front projection 2.5 mm corresponding to IEC 60 297-3-101
- HP pitch pattern of holes for the precise installation of guide rails
- M4 thread on end face
- Straight-through core hole

Usable width (HP)	Packs of	Order No.
84	1	<b>9908.721</b>

**Material:**

Extruded aluminum section

**Surface finish:**

Clear-chromated

**! Also required:**

Assembly screws M4 x 12, packs of 100, order no. 3654.300, see page 164

**+ Accessories:**

Threaded inserts, order no. 3684.610 (packs of 1), see page 114

