



Chipsmall Limited consists of a professional team with an average of over 10 year of expertise in the distribution of electronic components. Based in Hongkong, we have already established firm and mutual-benefit business relationships with customers from,Europe,America and south Asia,supplying obsolete and hard-to-find components to meet their specific needs.

With the principle of “Quality Parts,Customers Priority,Honest Operation,and Considerate Service”,our business mainly focus on the distribution of electronic components. Line cards we deal with include Microchip,ALPS,ROHM,Xilinx,Pulse,ON,Everlight and Freescale. Main products comprise IC,Modules,Potentiometer,IC Socket,Relay,Connector.Our parts cover such applications as commercial,industrial, and automotives areas.

We are looking forward to setting up business relationship with you and hope to provide you with the best service and solution. Let us make a better world for our industry!



## Contact us

Tel: +86-755-8981 8866 Fax: +86-755-8427 6832

Email & Skype: info@chipsmall.com Web: www.chipsmall.com

Address: A1208, Overseas Decoration Building, #122 Zhenhua RD., Futian, Shenzhen, China



### Extractor handle type I and type II



- Suitable for flat front panels/U-channel front panels
- With removal function
- May be used in combination with horizontal rails with 10 mm extension.

**Supply includes:**

Assembly parts

**Note:**

With 3 U, only one extractor handle is required.

**1 Type I extractor handle, 15 mm**

Color	Packs of	Order No.
grey	1	<b>3685.587</b>
black	1	<b>3685.589</b>

**2 Type II extractor handle, 30 mm**

Color	Packs of	Order No.
grey	1	<b>3685.588</b>
black	1	<b>3685.590</b>

**+ Accessories:**

Identification strips for extractor handles, see page 139

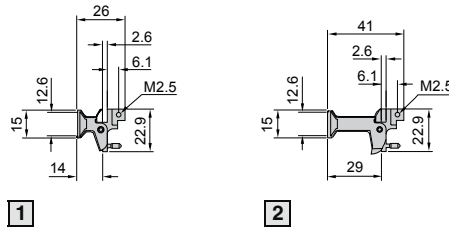
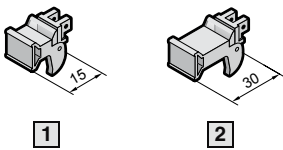

### Injector/extractor handle type IV



**Handles with micro-switch**

For inserting and removing connectors with a large number of pins.

- Insertion/removal function
- Integral microswitch for "live insertion" applications
- Self-activation of the micro-switch during insertion/removal
- ESD pin to dissipate static charges before contacting the connectors and for precise positioning of the board type plug-in unit
- Keyable
- Integral PCB attachment
- Self-locking
- Bayable

**Handle without micro-switch**

Description see above. Micro-switch may be retrofitted.

**Supply includes:**

1 handle without or with micro-switch, assembly parts.

**Note:**

- Insertion only when used with front horizontal rails, with 10 mm extension (B, B1, B2), see page 109-110
- With 3 U front panels, only one extractor handle is required.

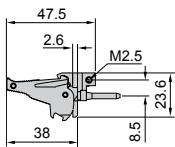
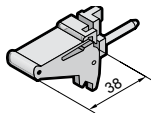

**Handles with micro-switch**

Color	Installation	Packs of	Order No.
grey	top	1	<b>3686.905</b>
grey	bottom	1	<b>3686.904</b>
black	top	1	<b>3686.907</b>
black	bottom	1	<b>3686.906</b>

**Handle without micro-switch**

Color	Installation	Packs of	Order No.
grey	top	1	<b>3686.901</b>
grey	bottom	1	<b>3686.900</b>
black	top	1	<b>3686.903</b>
black	bottom	1	<b>3686.902</b>

**+ Accessories:**

Keys, see page 124  
Keyable guide rails, see page 120  
Micro-switches, see page 141  
Connector pin for buying, see page 139

### Injector/extractor handle type IV



**8 HP, bayed**

Suitable for two front panels 4 HP that must be connected to another mechanically.

**Supply includes:**

2 bayed handles, fully assembled.

Color	Installation	Packs of	Order No.
Black	Bottom	1	<b>3686.908</b>
Black	Top	1	<b>3686.909</b>

**+ Accessories:**

Connector pin for buying, see page 139