



Chipsmall Limited consists of a professional team with an average of over 10 year of expertise in the distribution of electronic components. Based in Hongkong, we have already established firm and mutual-benefit business relationships with customers from,Europe,America and south Asia,supplying obsolete and hard-to-find components to meet their specific needs.

With the principle of “Quality Parts,Customers Priority,Honest Operation,and Considerate Service”,our business mainly focus on the distribution of electronic components. Line cards we deal with include Microchip,ALPS,ROHM,Xilinx,Pulse,ON,Everlight and Freescale. Main products comprise IC,Modules,Potentiometer,IC Socket,Relay,Connector.Our parts cover such applications as commercial,industrial, and automotives areas.

We are looking forward to setting up business relationship with you and hope to provide you with the best service and solution. Let us make a better world for our industry!



Contact us

Tel: +86-755-8981 8866 Fax: +86-755-8427 6832

Email & Skype: info@chipsmall.com Web: www.chipsmall.com

Address: A1208, Overseas Decoration Building, #122 Zhenhua RD., Futian, Shenzhen, China



THIS DRAWING IS UNPUBLISHED.

RELEASED FOR PUBLICATION

, 19

© COPYRIGHT 19

BY AMP INCORPORATED. ALL INTERNATIONAL RIGHTS RESERVED.

AMP PART NO	MATERIAL	PKG TYPE	QTY
8-36958-3	M/F 8-36958-0	BOX	25
8-36958-5	M/F 8-36958-0	BAG	5

LOC	DIST
6	14

P	F	ZONE	LTR

REVISIONS	DESCRIPTION	DATE	APPD
1	REVISED & REDRAWN PER 0720-0037-93	5/24/93	5 PER

METRIC

DIMENSIONS LISTED IN mm [INCHES]

AMP WIRE RANGE	IL E13288 Listed
2/0 AWG	2/0 AWG
SOLID OR STRANDED	SOLID OR STRANDED

LR7189 Certified	MILITARY P/N AND CLASS
2/0 AWG	NOT APPLICABLE
SOLID OR STRANDED	

1 STAMP AMP 2/0W* APPROX AS SHOWN

2 MATERIAL THK: 2.03±0.08 [.080 ±.003]

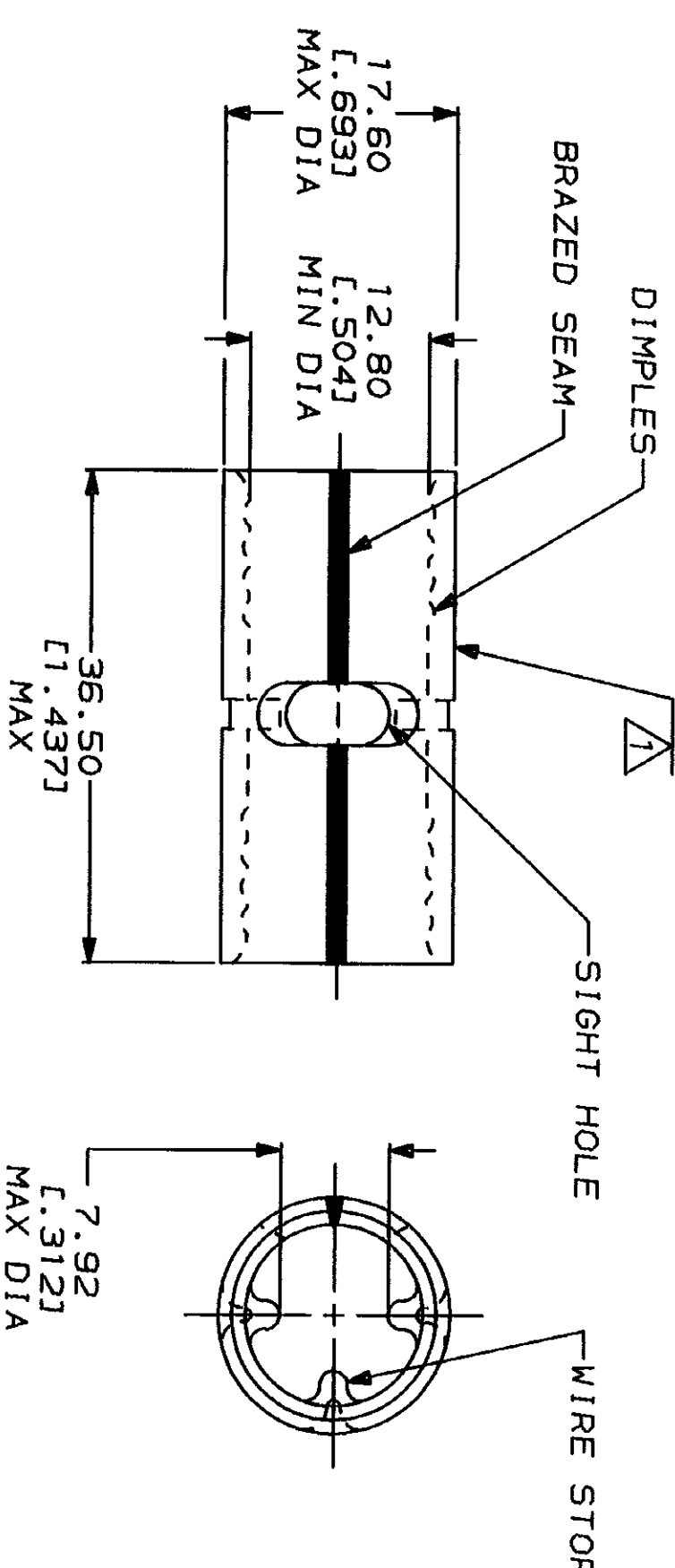

AMP INCORPORATED
CUSTOMER SERVICE SYSTEMS

MAX RECOMMENDED OPERATING TEMPERATURE:

170°C MAX

FOR ADDITIONAL PRODUCT INFORMATION OR COPIES OF DRAWINGS AND TECHNICAL DOCUMENTS

1-800-522-6752

PRODUCT INFORMATION CENTER

1-800-522-6752

FOR APPLICATION

TOOLING INFORMATION

TOOLING ASSISTANCE CENTER

1-800-722-1111

FOR ORDER ENTRY

1-800-526-5142

THIS DRAWING IS A CONTROLLED DOCUMENT FOR AMP INCORPORATED. IT IS SUBJECT TO CHANGE AND THE CONTROLLING ENGINEERING ORGANIZATION SHOULD BE CONTACTED FOR THE LATEST REVISION.

DO NOT SCALE PRINT. DIMENSIONS ON THIS DRAWING ARE TO BE USED FOR TOLERANCES ON: 2 PLC DEC ± 0.20 (.008) 3 PLC DEC ± .1 ANGLES ± .1

MATERIAL COPPER PER ASTM B-152 ANNEALED

FINISH TIN PLATE 0.00254 (.000100) MIN THK PER MIL-T-10727

AMP AMP Incorporated Harrisburg, PA 17105-3608

SPLICE, BUTT, SOLISTRAND™

SIZE CASE CODE 00779 DRAWING NO G-36958

SCALE 2:1 SHEET 1 OF 1