



Chipsmall Limited consists of a professional team with an average of over 10 year of expertise in the distribution of electronic components. Based in Hongkong, we have already established firm and mutual-benefit business relationships with customers from,Europe,America and south Asia,supplying obsolete and hard-to-find components to meet their specific needs.

With the principle of “Quality Parts,Customers Priority,Honest Operation,and Considerate Service”,our business mainly focus on the distribution of electronic components. Line cards we deal with include Microchip,ALPS,ROHM,Xilinx,Pulse,ON,Everlight and Freescale. Main products comprise IC,Modules,Potentiometer,IC Socket,Relay,Connector.Our parts cover such applications as commercial,industrial, and automotives areas.

We are looking forward to setting up business relationship with you and hope to provide you with the best service and solution. Let us make a better world for our industry!



Contact us

Tel: +86-755-8981 8866 Fax: +86-755-8427 6832

Email & Skype: info@chipsmall.com Web: www.chipsmall.com

Address: A1208, Overseas Decoration Building, #122 Zhenhua RD., Futian, Shenzhen, China



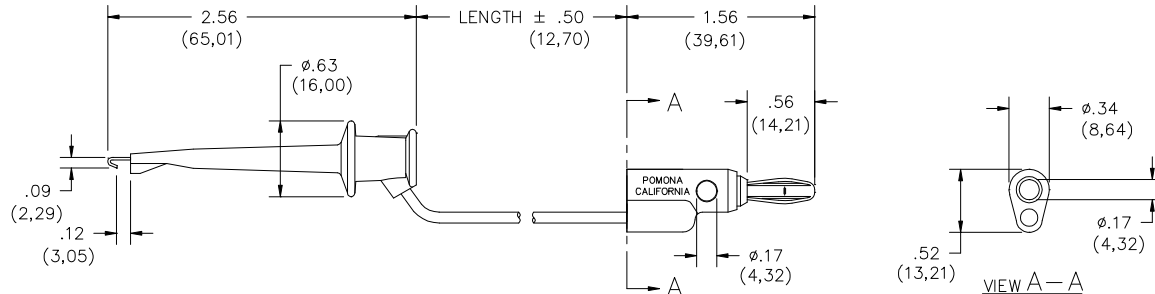

FEATURES:

- Provides a Minigrabber output from a Banana Jack.
- Banana plug is capable of vertical and cross stacking.
- Mates to Model 1581 or any standard Banana Jack.

MATERIALS:

Conn: 1st End - Minigrabber®

Material: Contact – Beryllium Copper

Spring – Stainless Steel

Finish: Contact – Gold Plated

Insulation: Glass filled nylon. Color matches color of wire.

Marking: “POMONA ELECTRONICS” “MINIGRABBER®”

Wire: 20 AWG, stranding 41 x 36 t.c., PVC insulated 2.21 (.087) O.D.

Marking: “POMONA 3782-***”

Conn: 2nd End – Stacking Banana Plug

Material: Spring – Beryllium Copper

Plug Body – Brass

Finish: Nickel Plated

Insulation: Polypropylene molded to plug body and wire. Color matches color of wire.

RATINGS:

Operating Temperature: +55°C (+131°F) Max.

Operating Voltage: Hand-held testing: 30VAC/60VDC Max.

Hands free testing in controlled voltage environments: 300 WVDC

Current: 5 Amperes Cont.

ORDERING INFORMATION: Model 3782-XX-*

XX = Cable Lengths, Standard Lengths: 12” (305mm), 24” (610mm), 36” (914mm), 48” (1219mm) & 60” (1524mm).

*= Color, -0 Black, -2 Red, -4 Yellow, -5 Green, -6 Blue

Ordering Example: 3782-60-2 Indicates 60” in length, Color is Red

Additional lengths and colors can be quoted upon request.

All dimensions are in inches and metric. All specifications are to the latest revisions. Specifications are subject to change without notice. Registered trademarks are the property of their respective companies. Made in USA