



Chipsmall Limited consists of a professional team with an average of over 10 year of expertise in the distribution of electronic components. Based in Hongkong, we have already established firm and mutual-benefit business relationships with customers from,Europe,America and south Asia,supplying obsolete and hard-to-find components to meet their specific needs.

With the principle of "Quality Parts,Customers Priority,Honest Operation,and Considerate Service",our business mainly focus on the distribution of electronic components. Line cards we deal with include Microchip,ALPS,ROHM,Xilinx,Pulse,ON,Everlight and Freescale. Main products comprise IC,Modules,Potentiometer,IC Socket,Relay,Connector.Our parts cover such applications as commercial,industrial, and automotives areas.

We are looking forward to setting up business relationship with you and hope to provide you with the best service and solution. Let us make a better world for our industry!



## Contact us

Tel: +86-755-8981 8866 Fax: +86-755-8427 6832

Email & Skype: info@chipsmall.com Web: www.chipsmall.com

Address: A1208, Overseas Decoration Building, #122 Zhenhua RD., Futian, Shenzhen, China



# INTERCONNECTS

## SERIES 380 • .100" GRID, LOW PROFILE RIGHT ANGLE SOLDER CUP HEADERS • SINGLE ROW STRIPS

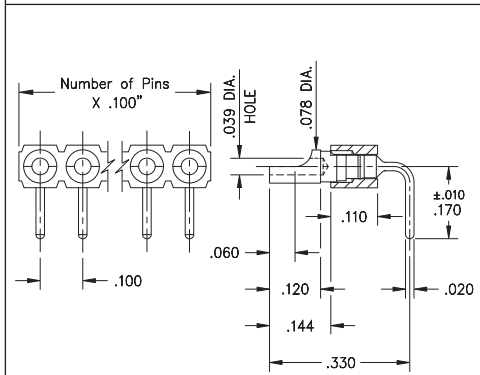
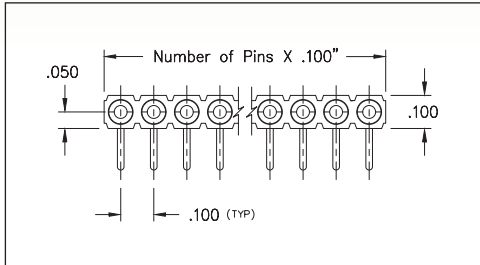

**FIG. 1**

- Series 380 right angle solder cup headers for low profile wire termination applications
- .020" diameter pins are suitable for mating with standard sockets or for through-hole soldering to the P.C.B.
- Connectors feature uniformly aligned solder cups and anti-rotation construction to facilitate efficient soldering
- Accepts up to 22 AWG Stranded wire
- Insulators are high temperature thermoplastic, suitable for all soldering operations

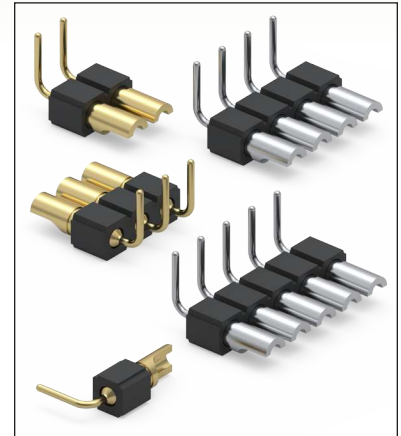

### ORDERING INFORMATION

|               |  |
|---------------|--|
| <b>FIG. 1</b> | <b>Series 380...003</b> <b>Single Row R/A Solder Cup Header</b>    |
|               | <p>380-XX-1-10-003000</p> <p>Specify number of pins      01-64</p> |



XX=Plating Code  
See Below

For  
Electrical, Mechanical  
& Environmental Data,  
See page 264

|                                 |          |           |
|---------------------------------|----------|-----------|
| <b>SPECIFY PLATING CODE XX=</b> | 10 ◆     | 40 ◆      |
| Pin Plating                     | 10 μ" Au | 200 μ" Sn |

