



Chipsmall Limited consists of a professional team with an average of over 10 year of expertise in the distribution of electronic components. Based in Hongkong, we have already established firm and mutual-benefit business relationships with customers from,Europe,America and south Asia,supplying obsolete and hard-to-find components to meet their specific needs.

With the principle of “Quality Parts,Customers Priority,Honest Operation,and Considerate Service”,our business mainly focus on the distribution of electronic components. Line cards we deal with include Microchip,ALPS,ROHM,Xilinx,Pulse,ON,Everlight and Freescale. Main products comprise IC,Modules,Potentiometer,IC Socket,Relay,Connector.Our parts cover such applications as commercial,industrial, and automotives areas.

We are looking forward to setting up business relationship with you and hope to provide you with the best service and solution. Let us make a better world for our industry!



Contact us

Tel: +86-755-8981 8866 Fax: +86-755-8427 6832

Email & Skype: info@chipsmall.com Web: www.chipsmall.com

Address: A1208, Overseas Decoration Building, #122 Zhenhua RD., Futian, Shenzhen, China



SERIES 39 SPST, 150 mA

FEATURES

- 1/4" Diameter
- Up to 1,000,000 Cycles of Operation
- PC Mount



DIMENSIONS in inches (and millimeters)

SPST–Normally Open, without Nut

39-405*

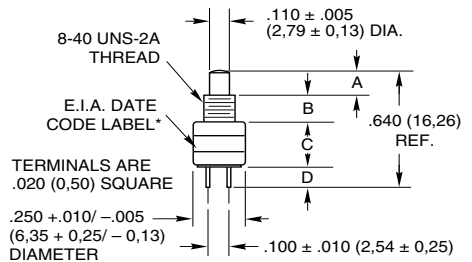

*Label increases nominal diameter to .255 (6.48)

A = .175 + .025 / -.020 (4.45 + 0.64 / - 0.51)
 B = .125 ± .010 (3.18 ± 0.25)
 C = .215 ± .015 (5.46 ± 0.38)
 D = .125 ± .010 (3.18 ± 0.25)

Rating at 28 Vdc Resistive	Operations at Rated Load	*Complete Part Number	Button Color
150 mA	1,000,000	39-405 RED 39-405 BLK	Red Black

Action	Total Travel	Actuating Force (oz.)
Momentary	.035 ± .015 (0.89 ± 0.38)	+ 4 - 2

SPST–Normally Open, with Nut

39-401*

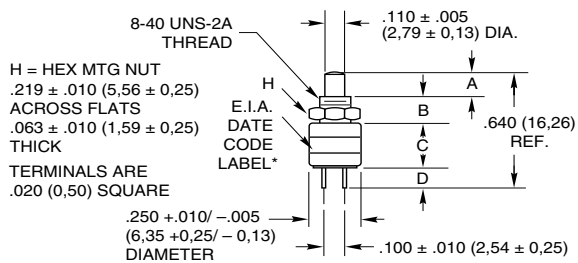

*Label increases nominal diameter to .255 (6.48)

A = .175 + .025 / -.020 (4.45 + 0.64 / - 0.51)
 B = .125 ± .010 (3.18 ± 0.25)
 C = .215 ± .015 (5.46 ± 0.38)
 D = .125 ± .010 (3.18 ± 0.25)

Rating at 28 Vdc Resistive	Operations at Rated Load	*Complete Part Number	Button Color
150 mA	1,000,000	39-401 RED 39-401 BLK	Red Black

Action	Total Travel	Actuating Force (oz.)
Momentary	.035 ± .015 (0.89 ± 0.38)	+ 4 - 2

SPST–Normally Open, with Overtravel

39-424*

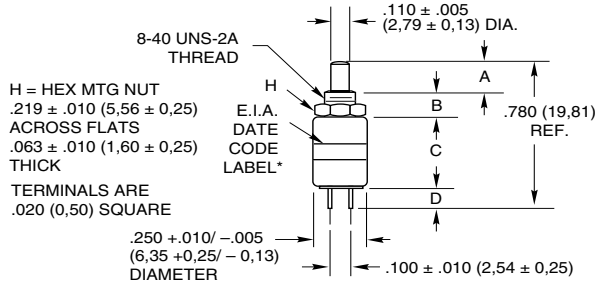

*Label increases nominal diameter to .255 (6.48)

A = .175 + .025 / -.020 (4.45 + 0.64 / - 0.51)
 B = .125 ± .010 (3.18 ± 0.25)
 C = .355 ± .015 (9.02 ± 0.38)
 D = .125 ± .010 (3.18 ± 0.25)

Rating at 28 Vdc Resistive	Operations at Rated Load	*Complete Part Number	Button Color
150 mA	100,000	39-424 RED 39-424 BLK	Red Black

Action	Total Travel	Over Travel	Actuating Force (oz.)
Momentary	.130 ± .025 (3.30 ± 0.64)	.015 (0.38) Min.	5 ± 3

DIMENSIONS in inches (and millimeters)

Right Angle, SPST–Normally Open

39-501*
39-503*

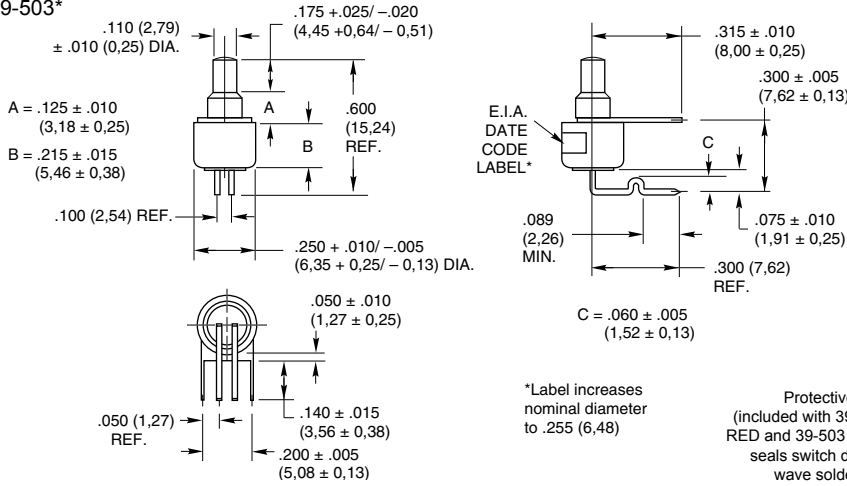

E.I.A. DATE CODE LABEL*
*Label increases nominal diameter to .255 (6,48)
Protective cap (included with 39-503 RED and 39-503 BLK) seals switch during wave soldering.

Mounting Footprint

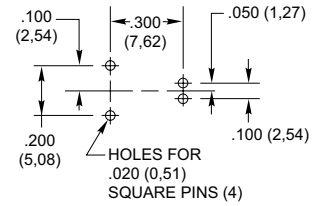

Rating at 28 Vdc Resistive	Operations at Rated Load	*Complete Part Number	Button Color
150 mA	1,000,000	39-501 RED 39-501 BLK 39-503 RED 39-503 BLK	Red Black Red Black

Action	Total Travel	Actuating Force (oz.)
Momentary	.035 ± .015 (0,89 ± 0,38)	4 + 4 - 2

SPST–Normally Open, with Panel and Button Seal

39-138*

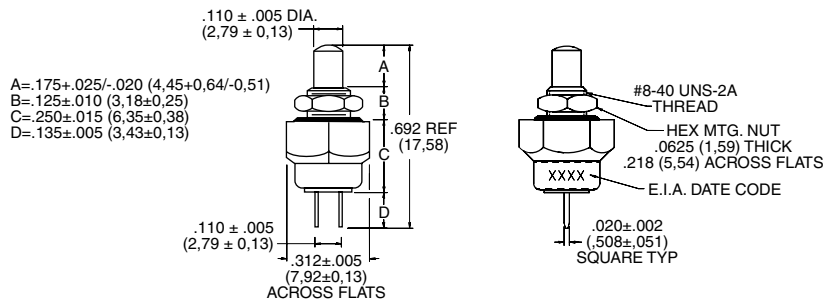

Rating at 115 Vac Resistive	Operations at Rated Load	*Complete Part Number	Button Color
½ Amp	250,000	39-138 RED 39-138 BLK	Red Black

Action	Total Travel	Actuating Force (oz.)
Momentary	.035 ± .015 (0,89 ± 0,38)	16 ± 8

SPECIFICATIONS

Rating Criteria

Contact Resistance: 25 milliohms maximum on a new switch

Voltage Breakdown: 1,000 Vac between mutually insulated parts

Insulation Resistance: 1,000 megohms minimum

Operating Temperature: -40°C to +85°C

* Note: Solder process temperatures should not expose main switch body to temperatures higher than 270F. (132C). Reflow soldering is not recommended. Contact Grayhill for more specific details.

Materials and Finishes

Bushing/Housing: Aluminum, clear anodized for 39-138; Brass, tin zinc for all others

Standoff: (39-501 and 39-503) Brass, tin plated over nickel

Base and Button: Thermoplastic

Shorting Bar: Brass, gold-plated over nickel plate for 39-501 and 39-503; fine silver, gold-plated for others

Terminals: Fine silver, gold-plated for 39-138; Brass, gold-plated over nickel for all others

Spring: Tinned music wire

Mounting Nut: (39-401 and 39-424) Brass, zinc trivalent chromate-plated

ORDERING INFORMATION

Part No.	Type & Button Color
39-401 RED	N.O., Red
39-401 BLK	N.O., Black
39-405 RED	N.O., No Nut, Red
39-405 BLK	N.O., No Nut, Black
39-424 RED	N.O., Overtravel, Red
39-424 BLK	N.O., Overtravel, Black
39-501 RED	N.O., Right Angle, Red
39-501 BLK	N.O., Right Angle, Black
39-503 RED	39-501 Red & Cap Seal
39-503 BLK	39-501 Blk & Cap Seal
39-138 RED	39-351 PC Mount & Seal
39-138 BLK	39-351 PC Mount & Seal

CIRCUITRY

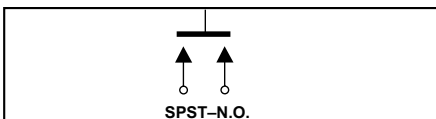

ACCESSORIES



Accessory Part Number	Description
30B1012-5	Red Accessory Cap
30B1012-8	White Accessory Cap
30B1012-9	Black Accessory Cap
SHH1699	Cap Seal Only, Black

Available from your local Grayhill Distributor. For prices and discounts, contact a local Sales Office, an authorized Distributor or Grayhill.