



Chipsmall Limited consists of a professional team with an average of over 10 year of expertise in the distribution of electronic components. Based in Hongkong, we have already established firm and mutual-benefit business relationships with customers from,Europe,America and south Asia,supplying obsolete and hard-to-find components to meet their specific needs.

With the principle of “Quality Parts,Customers Priority,Honest Operation,and Considerate Service”,our business mainly focus on the distribution of electronic components. Line cards we deal with include Microchip,ALPS,ROHM,Xilinx,Pulse,ON,Everlight and Freescale. Main products comprise IC,Modules,Potentiometer,IC Socket,Relay,Connector.Our parts cover such applications as commercial,industrial, and automotives areas.

We are looking forward to setting up business relationship with you and hope to provide you with the best service and solution. Let us make a better world for our industry!



Contact us

Tel: +86-755-8981 8866 Fax: +86-755-8427 6832

Email & Skype: info@chipsmall.com Web: www.chipsmall.com

Address: A1208, Overseas Decoration Building, #122 Zhenhua RD., Futian, Shenzhen, China



C&K 3P Series Miniature Pushwheel Switches



Features/Benefits

- Snap-in front mount design for easy assembly
- 10 position models available
- Illuminated backlighting available

Typical Applications

- Test & measurement equipment
- Industrial machinery
- Computer peripherals

Specifications

CONTACT RATING:
 CARRY: 1 AMP continuous.
 SWITCH: 0.4 VA max., 100 mA max., 28 V DC max.
 OPERATING VOLTAGE: 50 mV to 28 V DC.
 ELECTRICAL LIFE: 100,000 actuations.
 CONTACT RESISTANCE: Below 300 m Ω typ. @ 2-4 V DC, 100 mA.
 INSULATION RESISTANCE: 10⁹ Ω min. (dry).
 DIELECTRIC STRENGTH: 500 Vrms min. @sea level between common terminal and any output.
 OPERATING TEMPERATURE: -10°C to 65°C.

Materials

HOUSING: Polycarbonate (UL 94V-0).
 PUSHWHEEL: Polycarbonate (UL 94V-0).
 PUSHBUTTON: Polycarbonate (UL 94V-0).
 ROTOR CONTACTS: Gold over nickel over copper alloy.
 STATOR CONTACTS: Hard gold over nickel over copper on epoxy fiberglass.

NOTE: Specifications and materials listed above are for switches with standard options. For information on specific and custom switches, consult Customer Service Center.

Build-A-Switch

To order, simply select desired option from each category and place in the appropriate box. Available options are shown and described on pages M-17 thru M-19. For additional options not shown in catalog, consult Customer Service Center. Consult factory for illumination availability.

Thumbwheel & Pushwheel

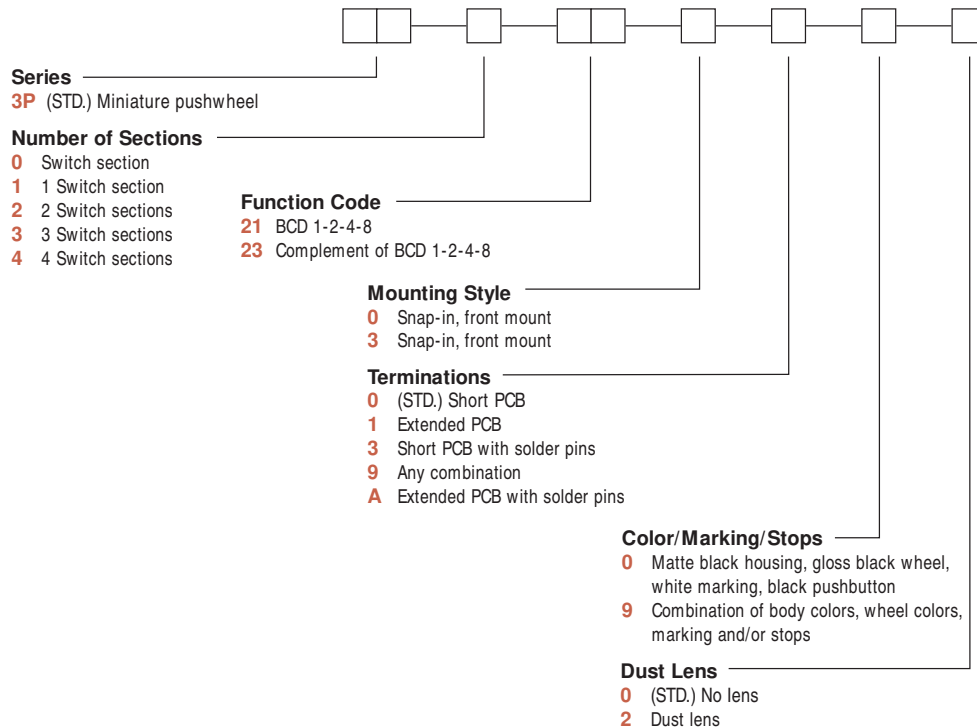

C&K 3P Series Miniature Pushwheel Switches

SERIES 

3P (STD.) MINIATURE PUSHWHEEL SWITCH

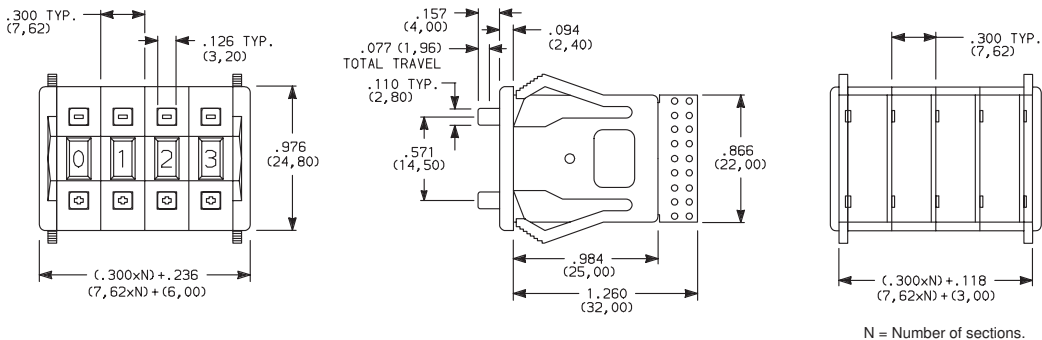

NUMBER OF SECTIONS 

- 0** Switch section only, no endplates.
- 1-4** Number of switch sections in assembly, includes endplates.

NOTE: Endplates and blank sections available separately, see page M-20.

FUNCTION CODE 

21 BCD 1-2-4-8, 10 POSITION

23 COMPLEMENT OF BCD 1-2-4-8, 10 POSITION

W H E E L	SIGNALS CONN. TO COMM. SIG. C			
	1	2	4	8
0				●
1	●			●
2		●		●
3	●	●		●
4			●	●
5	●		●	●
6		●	●	●
7	●	●	●	●
8				●
9	●		●	●
	1	3	5	7
	TERM. LOCATION			

Available Terminations: A, 0, 1, 3
See figs. 2 & 3, page M-19.

W H E E L	SIGNALS CONN. TO COMM. SIG. C			
	1	2	4	8
0	●	●	●	●
1	●	●	●	●
2	●	●	●	●
3	●	●	●	●
4	●	●	●	●
5	●	●	●	●
6	●	●	●	●
7	●	●	●	●
8	●	●	●	●
9	●	●	●	●
	1	7	9	3
	TERM. LOCATION			

Available Terminations: 0, 1, 3
See figs. 2 & 3, page M-19.

NOTE: For terminal location diagrams, see page M-19.



Dimensions are shown: IN (mm)
Dimensions subject to change



C&K 3P Series Miniature Pushwheel Switches

MOUNTING STYLE

- 0** SNAP-IN FRONT MOUNT,
SECTION PITCH: .300 (7,62) EACH SECTION

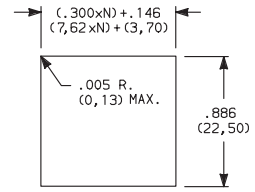
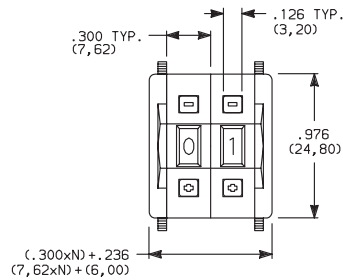

N = Number of sections.

Recommended panel thickness:
.039-.156
(0,99-3,95)

- 3** SNAP-IN FRONT MOUNT WITH SPACER,
SECTION PITCH: .400 (70,16) EACH SECTION, LAST SECTION .300 (7,62)

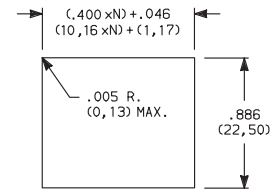
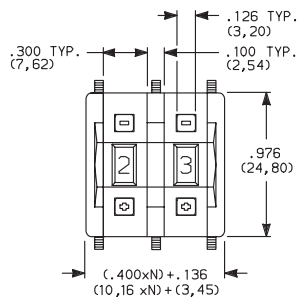

N = Number of sections.

Recommended panel thickness:
.039-.156
(0,99-3,95)

TERMINATIONS

- 0** (STD.) SHORT PCB

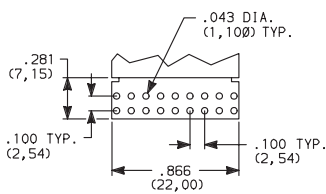

- 1** EXTENDED PCB WITH PROVISION
FOR COMPONENTS

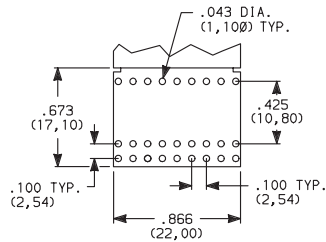

Signal traces cut, except for common(s).

- 3** SHORT PCB, TYPE 0 WITH SOLDER PINS

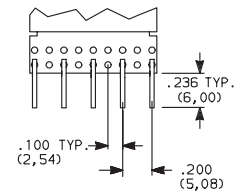

For terminal location numbers, see next page.

- A** EXTENDED PCB, TYPE 1 WITH
SOLDER PINS

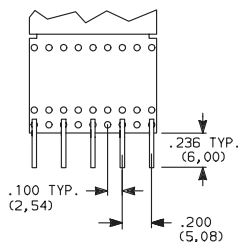

For terminal location numbers, see next page.

Signal traces cut, except for common(s).

- 9** ANY COMBINATION OF TERMINATION
CONFIGURATIONS OR SPECIAL TERMINATIONS

Specify on configuration form, page M-21
and consult Customer Service Center.

PC Board 1/32" (0,79) thick.

NOTE: All terminal holes shown may not be present for all function codes,
consult Customer Service Center.

C&K 3P Series Miniature Pushwheel Switches

TERMINATIONS

Terminal Location Numbers

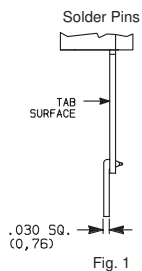

COLOR/MARKING/STOPS

- 0 (STD.) MATTE BLACK HOUSING (Gloss black wheel with white characters, black pushbuttons, no stops.)
- 9 SPECIAL COLORS, MARKINGS FOR HOUSING OR WHEEL, STOPS (Specify on CONFIGURATION FORM, page M-21 and consult Customer Service Center).

DUST LENS

- 0 (STD.) NO LENS
- 2 DUST LENS (Protects character face of the wheel from abrasion and dust.)

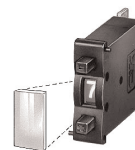

Thumbwheel & Pushwheel



M

C&K 3P Series Miniature Pushwheel Switches

AVAILABLE HARDWARE

Blank sections, .300 THK.

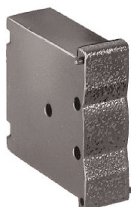

PART NO.
663702000 BLACK
663709000 GRAY

End plates



LEFT-with hole



RIGHT-with pin

PART NO.
623502000 LEFT-BLACK
623509000 LEFT-GRAY
623602000 RIGHT-BLACK
623609000 RIGHT-GRAY

One left and one right
piece required for
complete assembly.

Spacers, .100 THK.
(Makes section pitch .400)



PART NO.
663602000 BLACK
663609000 GRAY

Stop pins



PART NO.
657800000

Terminal connector



PART NO.
630000000

Fits 0, 1
terminations only.

Thumbwheel & Pushwheel



M

C&K 3P Series Miniature Pushwheel Switches

Configuration Form

GRAY SHADED AREAS TO BE FILLED IN BY CUSTOMER SERVICE.

CATALOG PART NO.

3 P

C&K PART NUMBER

C&K PART NUMBER

COMPANY NAME _____

CUSTOMER PRINT REVISION:

ADDRESS _____ TEL.# _____

CUSTOMER CONTACT _____ DATE _____

DETAILS:

ORIGINATED BY _____ SALES REP. _____

PUSHWHEEL SECTIONS	NO. OF SEC.	FUNCTION CODE – TERMINATIONS – COLOR/MARKING/STOPS/SEAL – ILLUMINATION <small>ENTER OPTION CODES IN APPROPRIATE BOXES. FUNCTION CODES INCLUDE BLANK SECTIONS (SEE PAGE M-17).</small>	DESCRIBE IN APPROPRIATE ROW
<input type="checkbox"/> 1 <input type="checkbox"/>	1	3 P - <input type="text"/> <input type="text"/> - <input type="text"/> <input type="text"/> <input type="text"/>	
<input type="checkbox"/> 2 <input type="checkbox"/>	2	3 P - <input type="text"/> <input type="text"/> - <input type="text"/> <input type="text"/> <input type="text"/>	
<input type="checkbox"/> 3 <input type="checkbox"/>	3	3 P - <input type="text"/> <input type="text"/> - <input type="text"/> <input type="text"/> <input type="text"/>	
<input type="checkbox"/> 4 <input type="checkbox"/>	4	3 P - <input type="text"/> <input type="text"/> - <input type="text"/> <input type="text"/> <input type="text"/>	
<input type="checkbox"/> 5 <input type="checkbox"/>	5	3 P - <input type="text"/> <input type="text"/> - <input type="text"/> <input type="text"/> <input type="text"/>	
<input type="checkbox"/> 6 <input type="checkbox"/>	6	3 P - <input type="text"/> <input type="text"/> - <input type="text"/> <input type="text"/> <input type="text"/>	
<input type="checkbox"/> 7 <input type="checkbox"/>	7	3 P - <input type="text"/> <input type="text"/> - <input type="text"/> <input type="text"/> <input type="text"/>	
<input type="checkbox"/> 8 <input type="checkbox"/>	8	3 P - <input type="text"/> <input type="text"/> - <input type="text"/> <input type="text"/> <input type="text"/>	
<input type="checkbox"/> 9 <input type="checkbox"/>	9	3 P - <input type="text"/> <input type="text"/> - <input type="text"/> <input type="text"/> <input type="text"/>	
<input type="checkbox"/> 0 <input type="checkbox"/>	10	3 P - <input type="text"/> <input type="text"/> - <input type="text"/> <input type="text"/> <input type="text"/>	
<input type="checkbox"/> 1 <input type="checkbox"/>	11	3 P - <input type="text"/> <input type="text"/> - <input type="text"/> <input type="text"/> <input type="text"/>	

QUALITY CONTROL INSTRUCTIONS

PRODUCTION APPROVAL

DATE

Q.C. APPROVAL

DATE

REV.

INITIALS

DATE

FOR SWITCHES WITH MORE THAN 11 SECTIONS, CONTINUE ON ADDITIONAL SHEETS.

SPECIAL INSTRUCTIONS OR SPECIFICATIONS:

SHEET ____ OF ____

