



Chipsmall Limited consists of a professional team with an average of over 10 year of expertise in the distribution of electronic components. Based in Hongkong, we have already established firm and mutual-benefit business relationships with customers from,Europe,America and south Asia,supplying obsolete and hard-to-find components to meet their specific needs.

With the principle of “Quality Parts,Customers Priority,Honest Operation,and Considerate Service”,our business mainly focus on the distribution of electronic components. Line cards we deal with include Microchip,ALPS,ROHM,Xilinx,Pulse,ON,Everlight and Freescale. Main products comprise IC,Modules,Potentiometer,IC Socket,Relay,Connector.Our parts cover such applications as commercial,industrial, and automotives areas.

We are looking forward to setting up business relationship with you and hope to provide you with the best service and solution. Let us make a better world for our industry!



Contact us

Tel: +86-755-8981 8866 Fax: +86-755-8427 6832

Email & Skype: info@chipsmall.com Web: www.chipsmall.com

Address: A1208, Overseas Decoration Building, #122 Zhenhua RD., Futian, Shenzhen, China



THIS DRAWING IS UNPUBLISHED. RELEASED FOR PUBLICATION
 © COPYRIGHT - By - ALL RIGHTS RESERVED.

LOC	DIST	REVISIONS					
FT	0	P	LTR	DESCRIPTION	DATE	DWN	APVD
			E	REVISED PER ECO-11-023401	01DEC11	KH	MS

MATERIAL:
 HOUSING: THERMOPLASTIC, UL94V-0, BLACK.
 TERMINAL: M3 THREAD, BRIGHT TIN PLATED, COPPER ALLOY.
 SCREWS: M3 THREAD ZINC PLATED STEEL, EXCEPT WHERE OTHERWISE NOTED.

ELECTRICAL:
 RATED CURRENT: 10A.
 OPERATING VOLTAGE: 300V.
 WIRE RANGE: 16-30 AWG.

MECHANICAL:
 PITCH (TERMINAL SPACING): .250"
 OPERATING TEMP.: 120°C MAX.

- ① SEE FIGURE.
- ② M3 SCREWS, ZINC PLATED STEEL AND M3 THREADED TERMINAL.
- 3 RUNNING TORQUE: 4 IN-LB MAX.
- ④ OBSOLETE PARTS: OBSOLETE CIS STREAMLINING PER D.RENAUD/D.SINISI

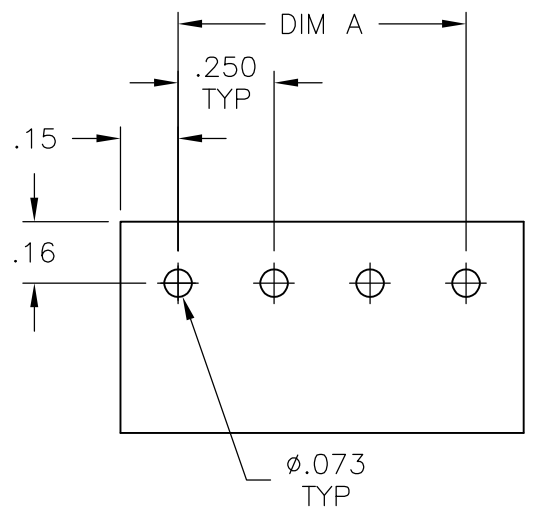
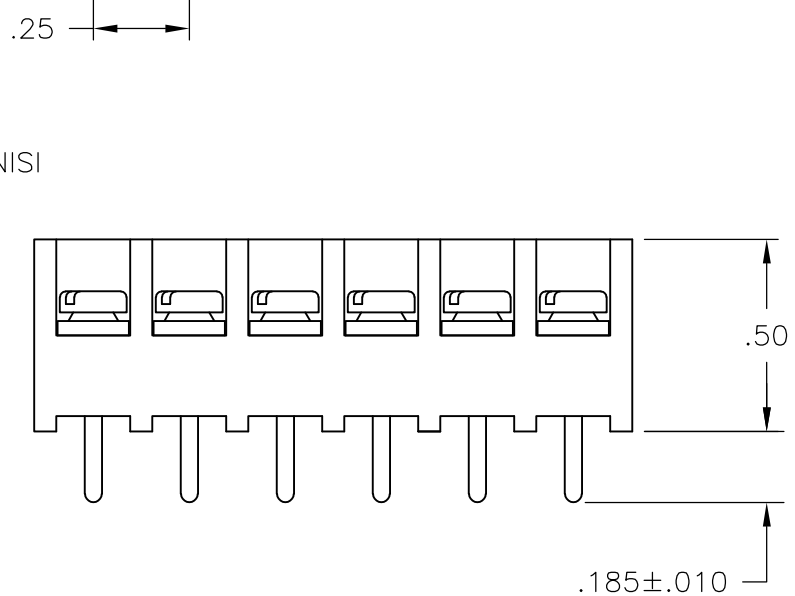
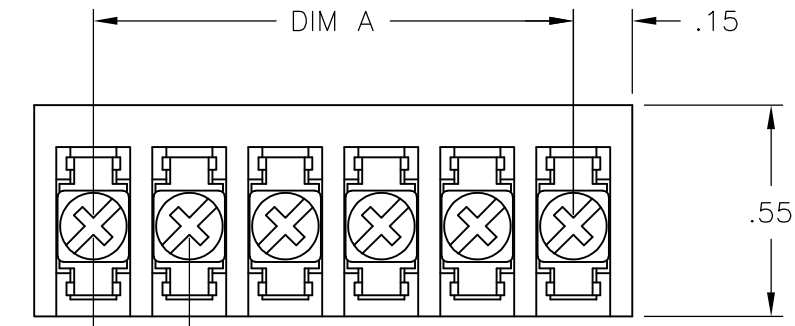

RECOMMENDED PCB LAYOUT

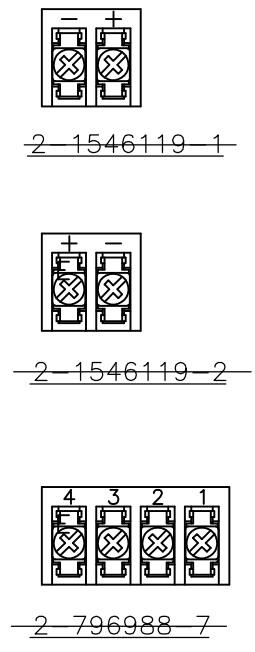

7.25	30	3PCV-30-006	4-1546119-3	
7.00	29	3PCV-29-006	2-1546533-9	
6.75	28	3PCV-28-006	2-1546533-8	
6.50	27	3PCV-27-006	2-1546533-7	
6.25	26	3PCV-26-006	4-1546119-2	
6.00	25	3PCV-25-006	2-1546533-5	
5.75	24	3PCV-24-006	4-1546119-1	
5.50	23	3PCV-23-006	2-1546533-3	
5.25	22	3PCV-22-006	3-1546119-9	
5.00	21	3PCV-21-006	2-1546533-1	
④ 4.75	20	3PCV-20-308	796597-2	
4.75	20	3PCV-20-006	796597-1	
4.50	19	3PCV-19-006	1-1546533-9	
4.25	18	3PCV-18-006	3-1546119-7	
4.00	17	3PCV-17-006	3-1546119-6	
3.75	16	3PCV-16-006	7-1437646-8	
3.50	15	3PCV-15-006	7-1437646-5	
3.25	14	3PCV-14-006	7-1437646-3	
3.00	13	3PCV-13-006	3-1546119-2	
2.75	12	3PCV-12-006	6-1437646-7	
2.50	11	3PCV-11-006	2-1546119-9	
2.25	10	3PCV-10-006	6-1437646-2	
2.00	9	3PCV-09-006	5-1437646-9	
1.75	8	3PCV-08-006	5-1437646-7	
1.50	7	3PCV-07-006	5-1437646-4	
1.25	6	3PCV-06-006	5-1437646-0	
1.00	5	3PCV-05-006	4-1437646-5	
④ ④ ①	.75	4	3PCV-04-006-SPL	-2-796988-7
	.75	4	3PCV-04-006	4-1437646-2
④ ④ ①	.50	3	3PCV-03-006	3-1437646-9
④ ④ ①	.25	2	3PCV-02-297	2-1546119-2
④ ④ ①	.25	2	3PCV-02-296	2-1546119-1
	.25	2	3PCV-02-006	3-1437646-3

- ④ ④ ① OBSOLETE
- ④ ④ ① OBSOLETE
- ④ ④ ① OBSOLETE

THIS DRAWING IS A CONTROLLED DOCUMENT.		DWN	S SCHLEGEL	24MAR03	STE TE Connectivity		
DIMENSIONS: INCHES		CHK	S YODER	3/24/03			
TOLERANCES UNLESS OTHERWISE SPECIFIED:		APVD	S YODER	3/24/03	NAME		
0 PLC	± -	PRODUCT SPEC		3PCV-XX-006 ASSEMBLY			
1 PLC	± -	APPLICATION SPEC		SIZE	CAGE CODE	DRAWING NO	RESTRICTED TO
2 PLC	± .02	MATERIAL		A3	00779	C-4-1437646-2	-
3 PLC	± .010	FINISH		CUSTOMER DRAWING			SCALE
4 PLC	± -	MATERIAL		SCALE			NTS
ANGLES	± -	MATERIAL		SHEET			1 OF 1
		MATERIAL		REV			E