



Chipsmall Limited consists of a professional team with an average of over 10 year of expertise in the distribution of electronic components. Based in Hongkong, we have already established firm and mutual-benefit business relationships with customers from,Europe,America and south Asia,supplying obsolete and hard-to-find components to meet their specific needs.

With the principle of “Quality Parts,Customers Priority,Honest Operation,and Considerate Service”,our business mainly focus on the distribution of electronic components. Line cards we deal with include Microchip,ALPS,ROHM,Xilinx,Pulse,ON,Everlight and Freescale. Main products comprise IC,Modules,Potentiometer,IC Socket,Relay,Connector.Our parts cover such applications as commercial,industrial, and automotives areas.

We are looking forward to setting up business relationship with you and hope to provide you with the best service and solution. Let us make a better world for our industry!



Contact us

Tel: +86-755-8981 8866 Fax: +86-755-8427 6832

Email & Skype: info@chipsmall.com Web: www.chipsmall.com

Address: A1208, Overseas Decoration Building, #122 Zhenhua RD., Futian, Shenzhen, China



THIS DRAWING IS UNPUBLISHED. RELEASED FOR PUBLICATION
 © COPYRIGHT BY TYCO ELECTRONICS CORPORATION. ALL RIGHTS RESERVED.

LOC	DIST	REVISIONS					
		P	LTR	DESCRIPTION	DATE	DWN	APVD
CM	00	K		REV PER ECN 0G3B-0349-03	26JUN03	SC	SB

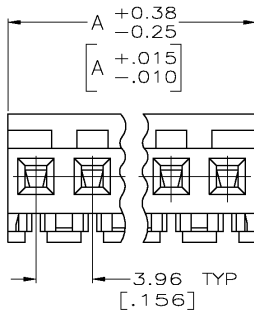
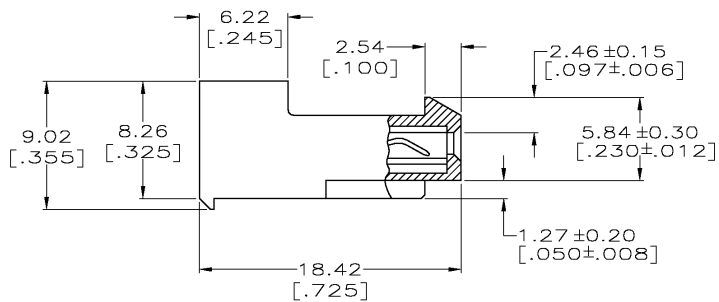
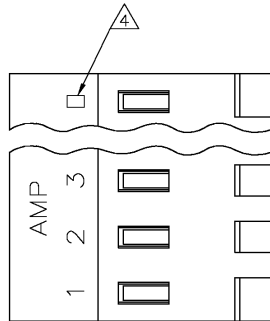

1 MATERIAL: CONNECTOR - NYLON UL94-V2 (ORANGE)
 CONTACTS - 0.30[.012] THICK COPPER ALLOY
 (BRIGHT TIN-LEAD 0.00203[.000080] MIN. THICK
 FOR CONTACTS 640426-2 THRU 2-640426-4).
 (BRIGHT TIN PLATE 0.00305[.000120] MIN. THICK
 FOR CONTACTS 3-640426-2 THRU 5-640426-4).

- 2. CONTACTS ACCEPT 18 AWG WIRE WITH 2.41[.095] MAX INSULATION DIAMETER.
- 3. CONTACTS MUST ACCEPT 1.14±0.03[.045] POST AND REMAIN LOCKED IN POSITION.
- 4 IDENTIFICATION NUMBER FOR LAST CIRCUIT MAY NOT APPEAR ON ALL ASSEMBLIES.
- 5. DIMENSIONS IN BRACKETS ARE IN INCHES.
- 6. HOUSING FEATURES ARE: CLOSED END WITH LOCKING RAMP.

YES	95.10[3.744]	24	5-640426-4
YES	91.13[3.588]	23	5-640426-3
YES	87.17[3.432]	22	5-640426-2
YES	83.21[3.276]	21	5-640426-1
YES	79.25[3.120]	20	5-640426-0
YES	75.29[2.964]	19	4-640426-9
YES	71.32[2.808]	18	4-640426-8
YES	67.36[2.652]	17	4-640426-7
YES	63.40[2.496]	16	4-640426-6
YES	59.44[2.340]	15	4-640426-5
YES	55.47[2.184]	14	4-640426-4
YES	51.51[2.028]	13	4-640426-3
YES	47.55[1.872]	12	4-640426-2
YES	43.59[1.716]	11	4-640426-1
YES	39.62[1.560]	10	4-640426-0
YES	35.66[1.404]	9	3-640426-9
YES	31.70[1.248]	8	3-640426-8
YES	27.74[1.092]	7	3-640426-7
YES	23.77[.936]	6	3-640426-6
YES	19.81[.780]	5	3-640426-5
YES	15.85[.624]	4	3-640426-4
YES	11.89[.468]	3	3-640426-3
YES	7.92[.312]	2	3-640426-2
NO	95.10[3.744]	24	2-640426-4
NO	91.13[3.588]	23	2-640426-3
NO	87.17[3.432]	22	2-640426-2
NO	83.21[3.276]	21	2-640426-1
NO	79.25[3.120]	20	2-640426-0
NO	75.29[2.964]	19	1-640426-9
NO	71.32[2.808]	18	1-640426-8
NO	67.36[2.652]	17	1-640426-7
NO	63.40[2.496]	16	1-640426-6
NO	59.44[2.340]	15	1-640426-5
NO	55.47[2.184]	14	1-640426-4
NO	51.51[2.028]	13	1-640426-3
NO	47.55[1.872]	12	1-640426-2
NO	43.59[1.716]	11	1-640426-1
NO	39.62[1.560]	10	1-640426-0
NO	35.66[1.404]	9	640426-9
NO	31.70[1.248]	8	640426-8
NO	27.74[1.092]	7	640426-7
NO	23.77[.936]	6	640426-6
NO	19.81[.780]	5	640426-5
NO	15.85[.624]	4	640426-4
NO	11.89[.468]	3	640426-3
NO	7.92[.312]	2	640426-2
LEADFREE	DIM A	NO. OF CIRCUITS	PART NO.

THIS DRAWING IS A CONTROLLED DOCUMENT.

DIMENSIONS: INCHES	TOLERANCES UNLESS OTHERWISE SPECIFIED:	DWN S. CARPENTER 26JUN2003	APVD D. BOSSI 26JUN2003
0 PLC ±	1 PLC ±	2 PLC ±	3 PLC ± 0.15 [.005]
4 PLC ±	ANGLES ±	FINISH	
MATERIAL	FINISH	CUSTOMER DRAWING	

CHK D. BOSSI 26JUN2003	NAME D. BOSSI	PRODUCT SPEC 108-1051	APPLICATION SPEC 114-1020
SIZE A2	CAGE CODE 00779	DRAWING NO 640426	RESTRICTED TO -
SCALE 4:1		SHEET 1 OF 1	

THIS DRAWING IS A CONTROLLED DOCUMENT. DWN S. CARPENTER 26JUN2003. CHK D. BOSSI 26JUN2003. APVD D. BOSSI 26JUN2003. NAME D. BOSSI. PRODUCT SPEC 108-1051. APPLICATION SPEC 114-1020. SIZE A2. CAGE CODE 00779. DRAWING NO 640426. RESTRICTED TO -. SCALE 4:1. SHEET 1 OF 1. REV K.



3/C BUSINESS GRP 3323 177-34 BARRY LEWIS