



Chipsmall Limited consists of a professional team with an average of over 10 year of expertise in the distribution of electronic components. Based in Hongkong, we have already established firm and mutual-benefit business relationships with customers from,Europe,America and south Asia,supplying obsolete and hard-to-find components to meet their specific needs.

With the principle of “Quality Parts,Customers Priority,Honest Operation,and Considerate Service”,our business mainly focus on the distribution of electronic components. Line cards we deal with include Microchip,ALPS,ROHM,Xilinx,Pulse,ON,Everlight and Freescale. Main products comprise IC,Modules,Potentiometer,IC Socket,Relay,Connector.Our parts cover such applications as commercial,industrial, and automotives areas.

We are looking forward to setting up business relationship with you and hope to provide you with the best service and solution. Let us make a better world for our industry!



## Contact us

Tel: +86-755-8981 8866 Fax: +86-755-8427 6832

Email & Skype: info@chipsmall.com Web: www.chipsmall.com

Address: A1208, Overseas Decoration Building, #122 Zhenhua RD., Futian, Shenzhen, China



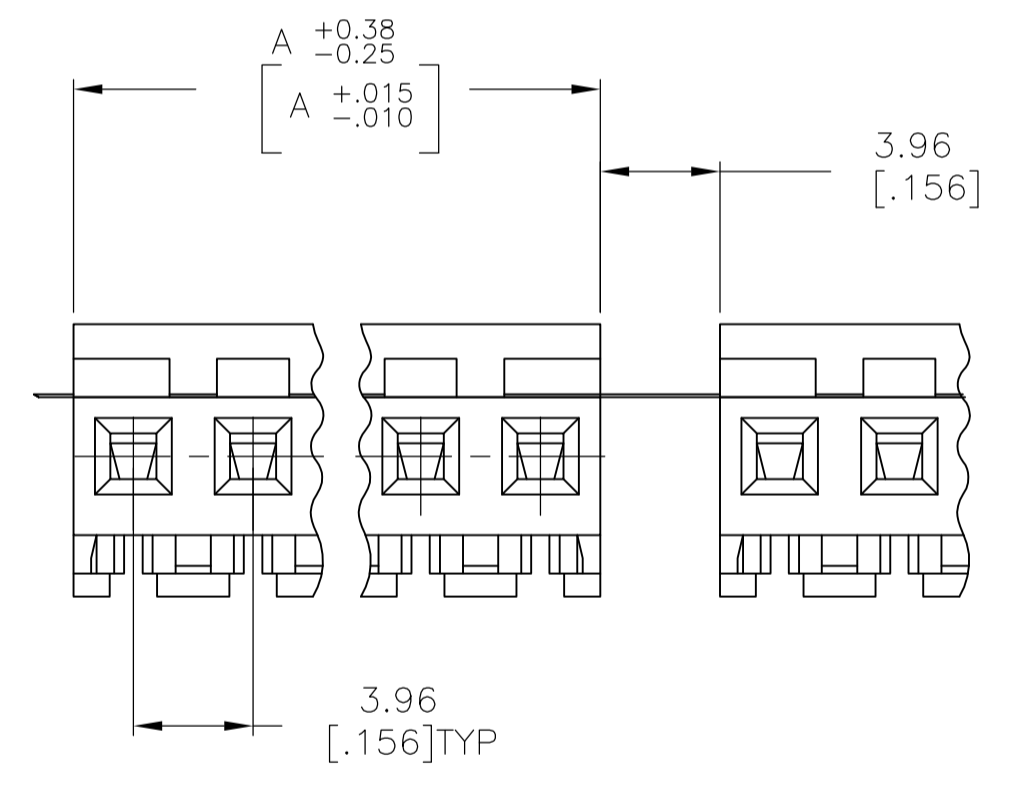
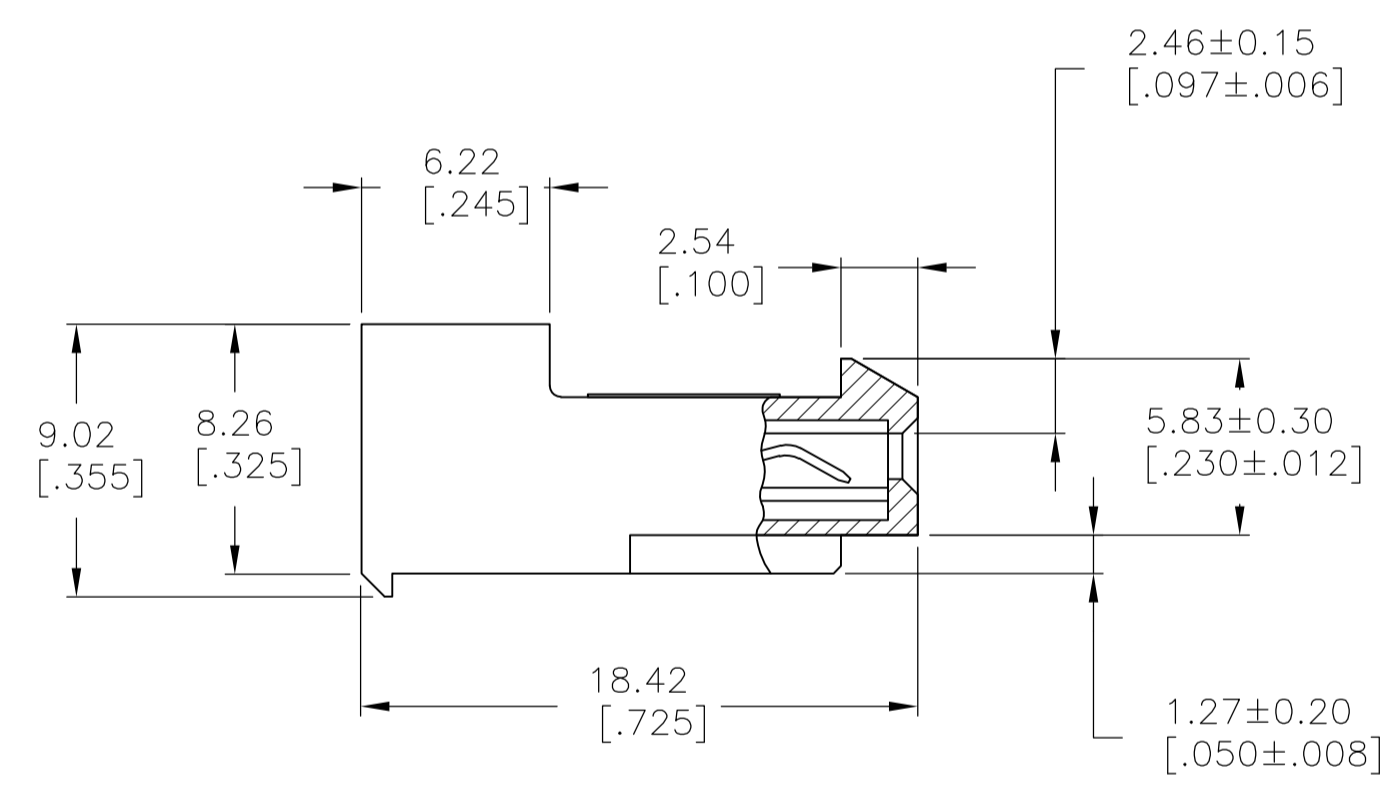
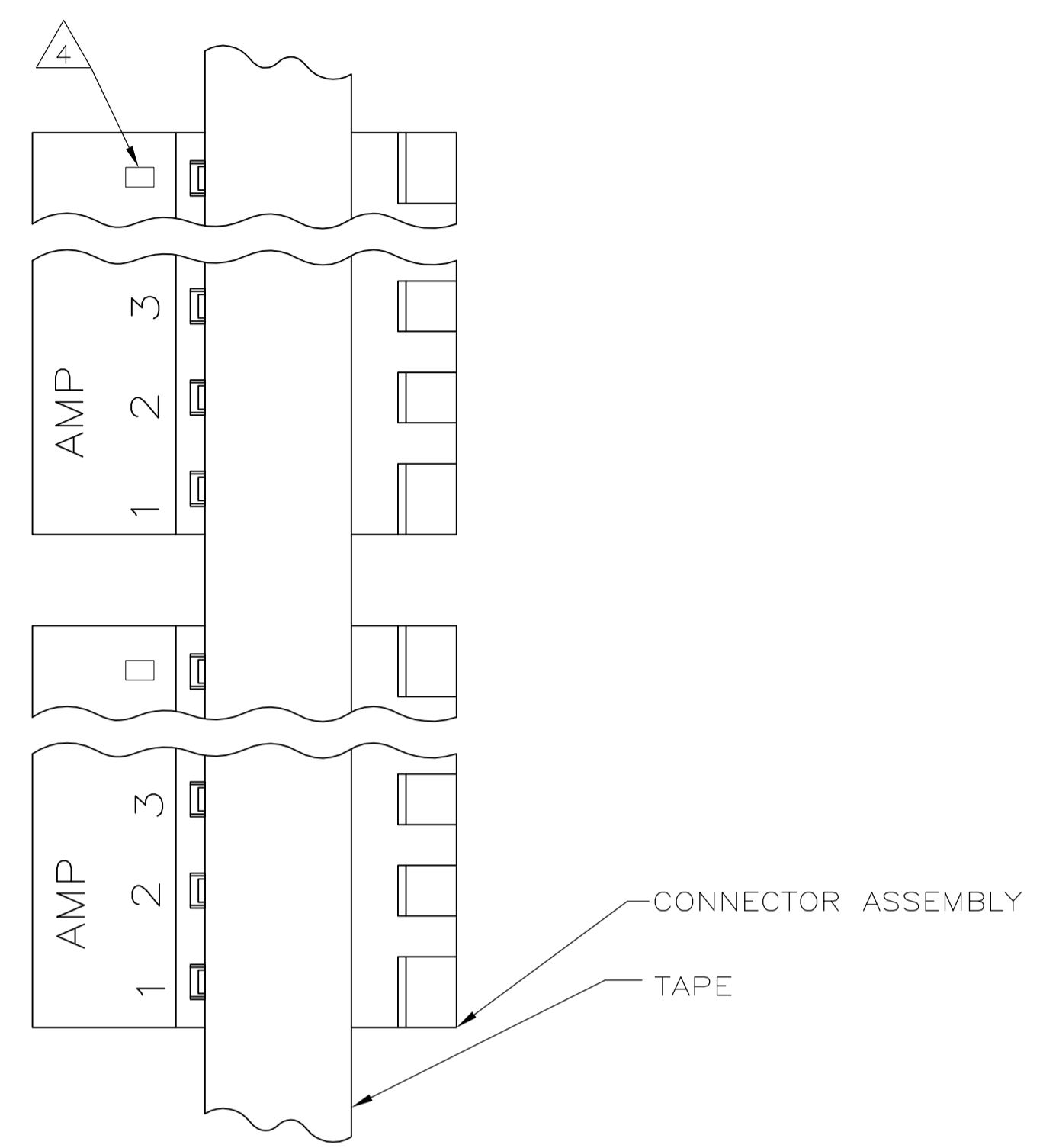

- 1 MATERIAL: CONTACTS - 0.30[.012] THICK COPPER ALLOY BRIGHT TIN-LEAD 0.00203[.000080] MIN THICK FOR CONTACTS 640474-2 THRU 2-640474-4 MATTE WHISKER MITIGATED TIN 0.00203[.000080] MIN THICKNESS OVER NICKEL UNDERPLATE FOR 3-640474-2 THRU 5-640474-4
- 2 CONTACTS ACCEPT 22 AWG WIRE WITH 2.41[.095] MAX INSULATION DIAMETER.
- 3 CONTACTS MUST ACCEPT 1.14±0.03[.045±.001] SQUARE POST AND REMAIN LOCKED IN POSITION.
- 4 IDENTIFICATION NUMBER FOR LAST CIRCUIT MAY NOT APPEAR ON ALL ASSEMBLIES.
- 5 DIMENSIONS IN BRACKETS ARE IN INCHES.
- 6 HOUSING FEATURES ARE: CLOSED END WITH LOCKING RAMP.
- 7 OBSOLETE PARTS: OBSOLETE CIS STREAMLINING PER D.RENAUD/D.SINISI
- 8 RED COLOR STRIPE ON HOUSING (NOT SHOWN) MAY RUN DOWN BETWEEN RIBS

95.10	[3.744]	24	5-640474-4
91.13	[3.588]	23	5-640474-3
87.17	[3.432]	22	5-640474-2
83.21	[3.276]	21	5-640474-1
79.25	[3.120]	20	5-640474-0
75.29	[2.964]	19	4-640474-9
71.32	[2.808]	18	4-640474-8
67.36	[2.652]	17	4-640474-7
63.40	[2.496]	16	4-640474-6
59.44	[2.340]	15	4-640474-5
55.47	[2.184]	14	4-640474-4
51.51	[2.028]	13	4-640474-3
47.55	[1.872]	12	4-640474-2
43.59	[1.716]	11	4-640474-1
39.62	[1.560]	10	4-640474-0
35.66	[1.404]	9	3-640474-9
31.70	[1.248]	8	3-640474-8
27.74	[1.092]	7	3-640474-7
23.77	[.936]	6	3-640474-6
19.81	[.780]	5	3-640474-5
15.85	[.624]	4	3-640474-4
11.89	[.468]	3	3-640474-3
7.92	[.312]	2	3-640474-2
95.10	[3.744]	24	2-640474-4
91.13	[3.588]	23	2-640474-3
87.17	[3.432]	22	2-640474-2
83.21	[3.276]	21	2-640474-1
79.25	[3.120]	20	2-640474-0
75.29	[2.964]	19	1-640474-9
71.32	[2.808]	18	1-640474-8
67.36	[2.652]	17	1-640474-7
63.40	[2.496]	16	1-640474-6
59.44	[2.340]	15	1-640474-5
55.47	[2.184]	14	1-640474-4
51.51	[2.028]	13	1-640474-3
47.55	[1.872]	12	1-640474-2
43.59	[1.716]	11	1-640474-1
39.62	[1.560]	10	1-640474-0
35.66	[1.404]	9	640474-9
31.70	[1.248]	8	640474-8
27.74	[1.092]	7	640474-7
23.77	[.936]	6	640474-6
19.81	[.780]	5	640474-5
15.85	[.624]	4	640474-4
11.89	[.468]	3	640474-3
7.92	[.312]	2	640474-2

SUPERSEDED  
 7  
 SUPERSEDED

7 SUPERSEDED

DIM A	NO OF CIRCUITS	PART NO
-------	----------------	---------

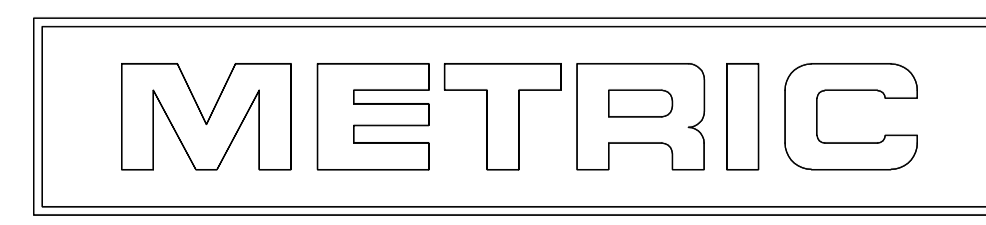

THIS DRAWING IS A CONTROLLED DOCUMENT. DIN 9139 LEWIS 2-12-91  
 CHK R SWING 2-12-91  
 APVD -

PRODUCT SPEC: 108-1051  
 APPLICATION SPEC: 114-1020

MTA-156 CONNECTOR ASSEMBLY, 22 AWG, STANDARD TAPE MOUNTED

SIZE: A1  
 CAGE CODE: 00779  
 DRAWING NO: 640474

RESTRICTED TO: -  
 CUSTOMER DRAWING  
 SCALE: 4:1 SHEET 1 OF 1 REV Y