



Chipsmall Limited consists of a professional team with an average of over 10 year of expertise in the distribution of electronic components. Based in Hongkong, we have already established firm and mutual-benefit business relationships with customers from,Europe,America and south Asia,supplying obsolete and hard-to-find components to meet their specific needs.

With the principle of “Quality Parts,Customers Priority,Honest Operation,and Considerate Service”,our business mainly focus on the distribution of electronic components. Line cards we deal with include Microchip,ALPS,ROHM,Xilinx,Pulse,ON,Everlight and Freescale. Main products comprise IC,Modules,Potentiometer,IC Socket,Relay,Connector.Our parts cover such applications as commercial,industrial, and automotives areas.

We are looking forward to setting up business relationship with you and hope to provide you with the best service and solution. Let us make a better world for our industry!



Contact us

Tel: +86-755-8981 8866 Fax: +86-755-8427 6832

Email & Skype: info@chipsmall.com Web: www.chipsmall.com

Address: A1208, Overseas Decoration Building, #122 Zhenhua RD., Futian, Shenzhen, China



- 1 MATERIAL: CONNECTOR-NYLON UL94V-2.
CONTACTS-0.30 [.012] THICK COPPER ALLOY
0.00076 [.000030] GOLD OR 0.00076[.000030]
TOTAL GOLD FLASH OVER PALLADIUM NICKEL,
PER TE CONNECTIVITY'S DISCRETION, IN
CONTACT AREA WITH BRIGHT TIN-LEAD
FOR 641240-2 THRU 2-641240-8, MATTE
WHISKER MITIGATED TIN FOR 3-641240-2
THRU 5-641240-8 OVER NICKEL UNDERPLATE.
- 2 CONTACTS ACCEPT 28 AWG WIRE WITH 1.52 [.060] MAX INSULATION DIAMETER.
- 3 CONTACTS MUST ACCEPT 0.64±0.03 [.025±.001] SQUARE POST AND REMAIN LOCKED IN POSITION.
- 4 IDENTIFICATION NUMBER FOR LAST CIRCUIT MAY NOT APPEAR ON ALL ASSEMBLIES.
- 5 DIMENSIONS IN BRACKETS ARE IN INCHES.
- 6 HOUSING FEATURES ARE: CLOSED END WITH LOCKING RAMP.
- 7 OBSOLETE PARTS: OBSOLETE CIS STREAMLINING PER D.RENAUD/D.SINISI
- 8 GREEN COLOR STRIPE ON HOUSING (NOT SHOWN) MAY RUN DOWN BETWEEN RIBS.

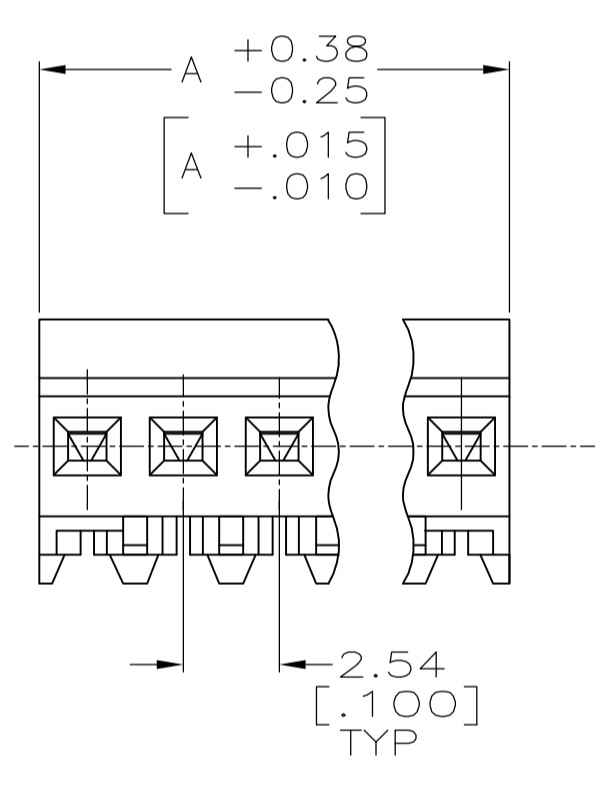
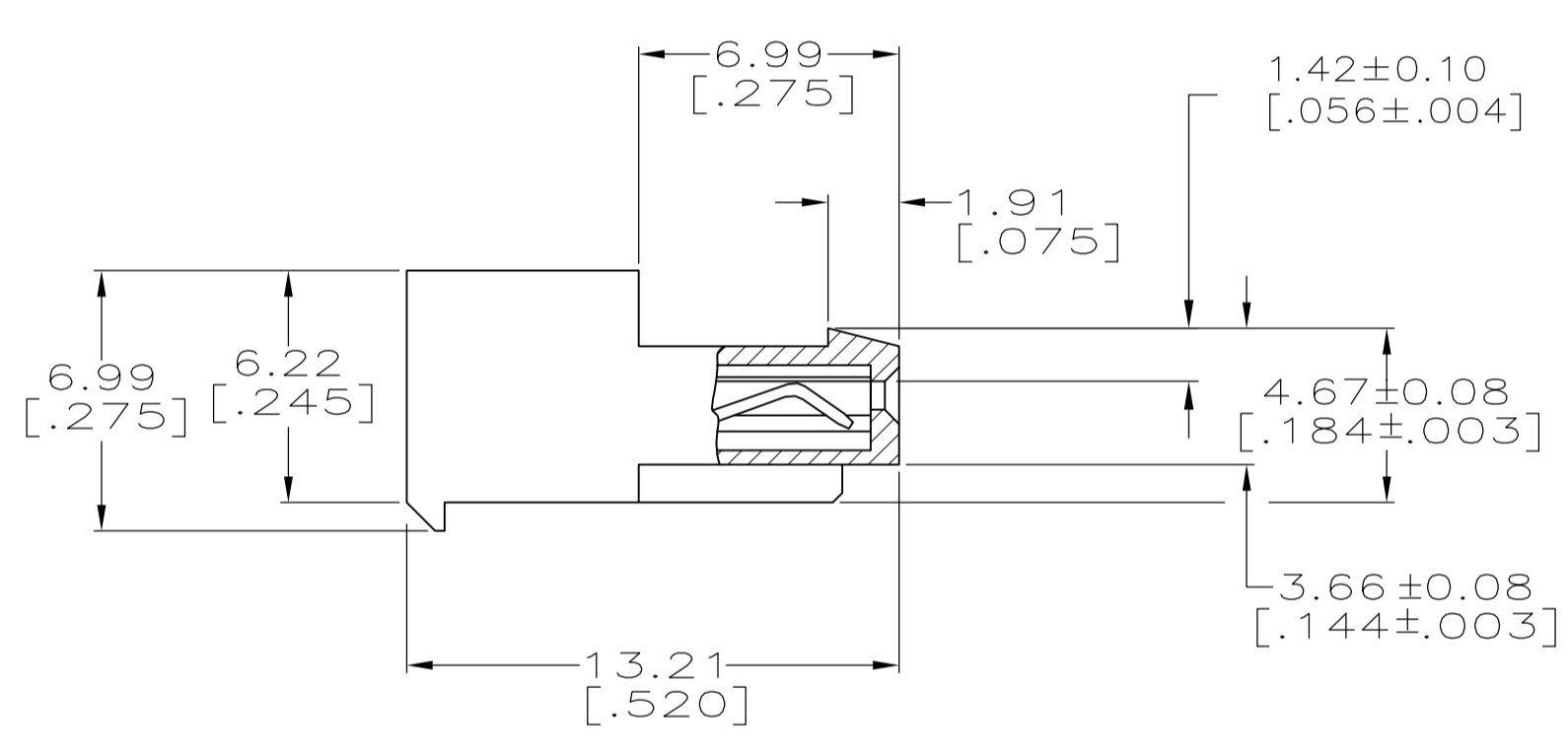
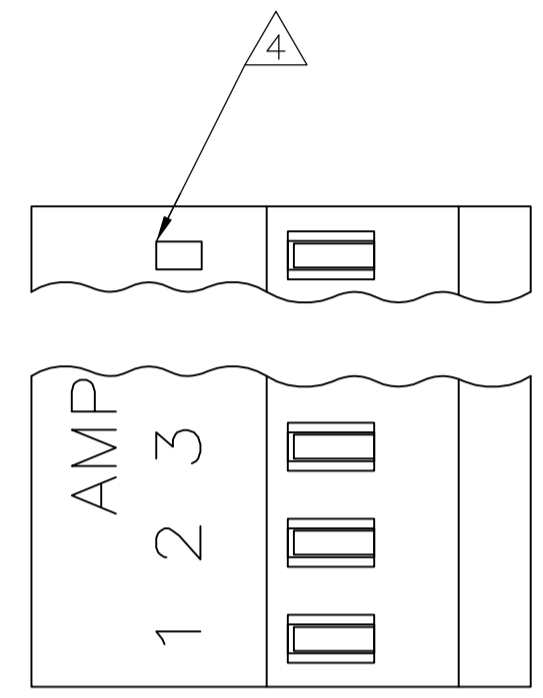

LEAD FREE	71.12 [2.800]	28	5-641240-8	CONTAINS LEAD	71.12 [2.800]	28	2-641240-8
	68.58 [2.700]	27	5-641240-7		68.58 [2.700]	27	2-641240-7
	66.04 [2.600]	26	5-641240-6		66.04 [2.600]	26	2-641240-6
	63.50 [2.500]	25	5-641240-5		63.50 [2.500]	25	2-641240-5
	60.96 [2.400]	24	5-641240-4		60.96 [2.400]	24	2-641240-4
	58.42 [2.300]	23	5-641240-3		58.42 [2.300]	23	2-641240-3
	55.88 [2.200]	22	5-641240-2		55.88 [2.200]	22	2-641240-2
	53.34 [2.100]	21	5-641240-1		53.34 [2.100]	21	2-641240-1
	50.80 [2.000]	20	5-641240-0		50.80 [2.000]	20	2-641240-0
	48.26 [1.900]	19	4-641240-9		48.26 [1.900]	19	1-641240-9
	45.72 [1.800]	18	4-641240-8		45.72 [1.800]	18	1-641240-8
	43.18 [1.700]	17	4-641240-7		43.18 [1.700]	17	1-641240-7
	40.64 [1.600]	16	4-641240-6		40.64 [1.600]	16	1-641240-6
	38.10 [1.500]	15	4-641240-5		38.10 [1.500]	15	1-641240-5
	35.56 [1.400]	14	4-641240-4		35.56 [1.400]	14	1-641240-4
	33.02 [1.300]	13	4-641240-3		33.02 [1.300]	13	1-641240-3
	30.48 [1.200]	12	4-641240-2		30.48 [1.200]	12	1-641240-2
	27.94 [1.100]	11	4-641240-1		27.94 [1.100]	11	1-641240-1
	25.40 [1.000]	10	4-641240-0		25.40 [1.000]	10	1-641240-0
	22.86 [.900]	9	3-641240-9		22.86 [.900]	9	641240-9
20.32 [.800]	8	3-641240-8	20.32 [.800]	8	641240-8		
17.78 [.700]	7	3-641240-7	17.78 [.700]	7	641240-7		
15.24 [.600]	6	3-641240-6	15.24 [.600]	6	641240-6		
12.70 [.500]	5	3-641240-5	12.70 [.500]	5	641240-5		
10.16 [.400]	4	3-641240-4	10.16 [.400]	4	641240-4		
7.62 [.300]	3	3-641240-3	7.62 [.300]	3	641240-3		
5.08 [.200]	2	3-641240-2	5.08 [.200]	2	641240-2		
DIM A	NO.OF POSN	ASSEMBLY	DIM A	NO.OF POSN	ASSEMBLY		

SUPERCEDED

SUPERCEDED

METRIC

THIS DRAWING IS A CONTROLLED DOCUMENT.

DIMENSIONS: mm [INCHES]	TOLERANCES UNLESS OTHERWISE SPECIFIED:	DIN S. HOOVER 28-DEC-2004	TE Connectivity
0 PLC ±	± 0.13 [.005]	CHK: D. ROSSI 28-DEC-2004	NAME: MTA .100 CONNECTOR ASSEMBLY 28 AWG, STANDARD
1 PLC ±		APPROV: D. ROSSI	PRODUCT SPEC: 108-1050
2 PLC ±			APPLICATION SPEC: 114-1019
3 PLC ±			SIZE: A1
4 PLC ±			SCALE: 5:1
ANGLES ±			SHEET 1 OF 1
FINISH			REV M

CUSTOMER DRAWING