



Chipsmall Limited consists of a professional team with an average of over 10 year of expertise in the distribution of electronic components. Based in Hongkong, we have already established firm and mutual-benefit business relationships with customers from,Europe,America and south Asia,supplying obsolete and hard-to-find components to meet their specific needs.

With the principle of “Quality Parts,Customers Priority,Honest Operation,and Considerate Service”,our business mainly focus on the distribution of electronic components. Line cards we deal with include Microchip,ALPS,ROHM,Xilinx,Pulse,ON,Everlight and Freescale. Main products comprise IC,Modules,Potentiometer,IC Socket,Relay,Connector.Our parts cover such applications as commercial,industrial, and automotives areas.

We are looking forward to setting up business relationship with you and hope to provide you with the best service and solution. Let us make a better world for our industry!



Contact us

Tel: +86-755-8981 8866 Fax: +86-755-8427 6832

Email & Skype: info@chipsmall.com Web: www.chipsmall.com

Address: A1208, Overseas Decoration Building, #122 Zhenhua RD., Futian, Shenzhen, China



THIS DRAWING IS UNPUBLISHED. RELEASED FOR PUBLICATION
 © COPYRIGHT - By - ALL RIGHTS RESERVED.

LOC		DIST		REVISIONS			
P	LTR	DESCRIPTION		DATE	DWN	APVD	
CM	00	G		REVISED PER ECO-12-007612	03AUG12	KH	SM

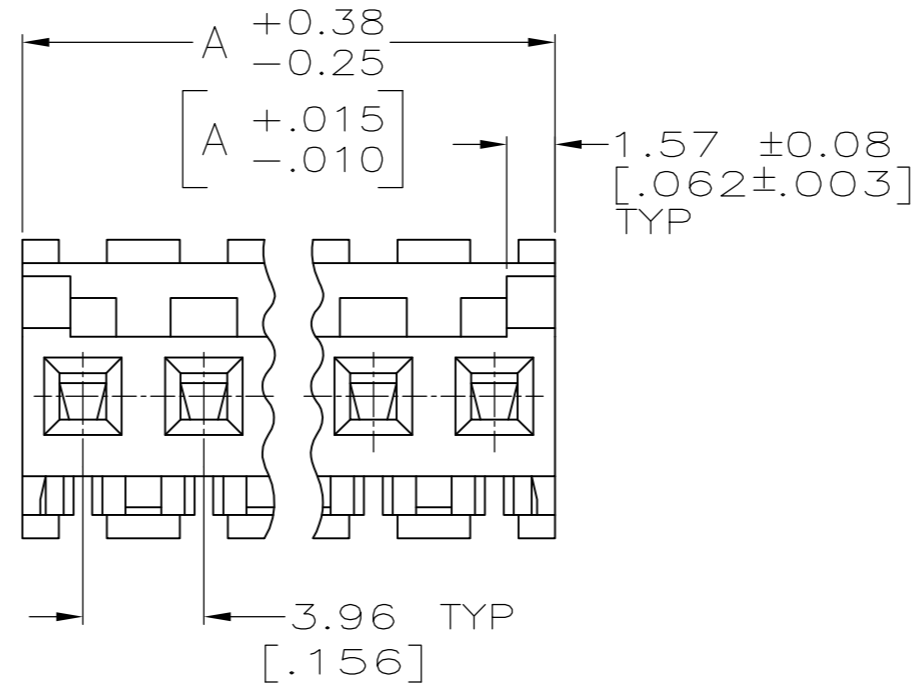
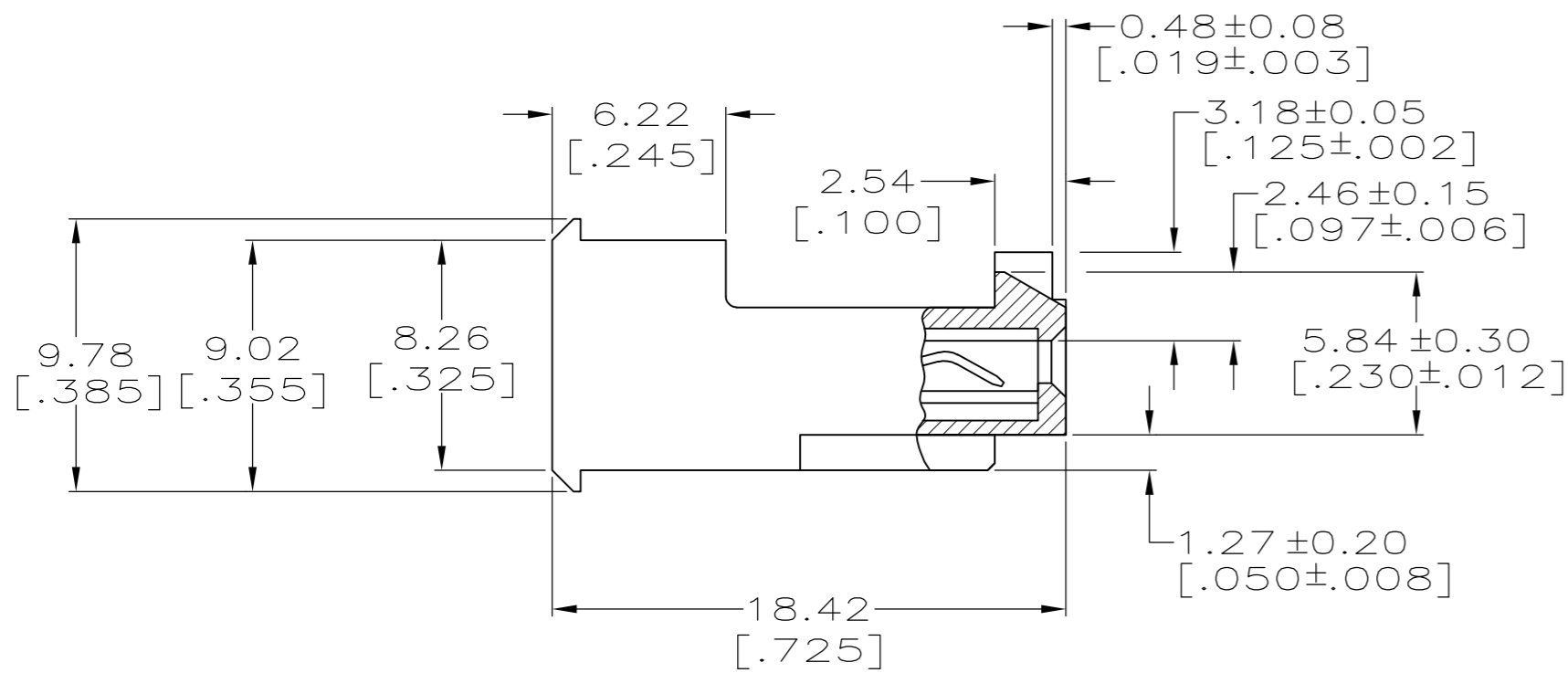
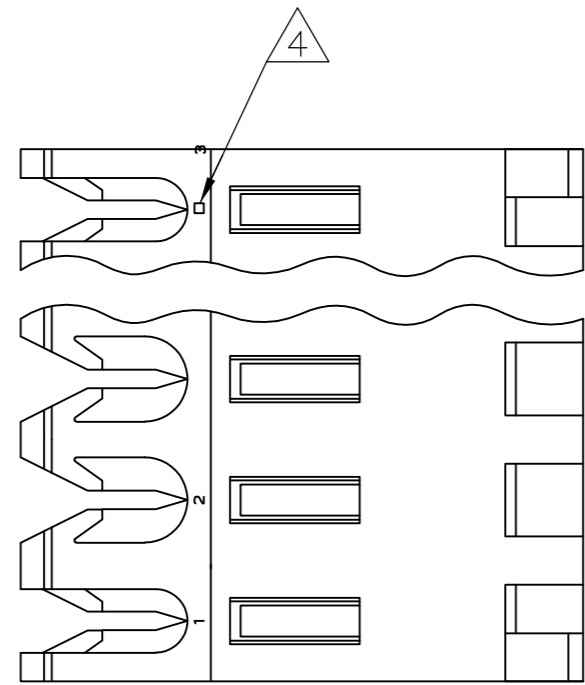

- 1 MATERIAL:
 CONNECTOR - NYLON UL94V-2.
 CONTACTS - 0.30[.012] THICK COPPER ALLOY.
 PLATING - 0.00076[.000030] GOLD THK OR 0.00008[.000003] MIN THK GOLD FLASH OVER 0.00068[.000027] THK PALLADIUM NICKEL, PER TE CONNECTIVITY'S DISCRETION. IN CONTACT AREA. 0.00203[.000080] MIN THICKNESS BRIGHT TIN LEAD IN SLOT AREA FOR 647479-2 THRU 1-647479-2 OR MATTE WHISKER MITIGATED TIN IN SLOT AREA FOR 3-647479-2 THRU 5-647479-4 OVER NICKEL UNDERPLATE.
- 2 CONTACTS ACCEPT 18 AWG WIRE WITH 2.41[.095] MAX INSULATION DIAMETER.
- 3 CONTACTS MUST ACCEPT 1.14 0.03[.045] POST AND REMAIN LOCKED IN POSITION.
- 4 IDENTIFICATION NUMBER FOR LAST CIRCUIT MAY TIN-LEADT APPEAR ON ALL ASSEMBLIES.
- 5 DIMENSIONS IN BRACKETS ARE IN INCHES.
- 6 HOUSING FEATURES ARE: FEED-THRU WITH LOCKING RAMP AND POLARIZING TAB.
- 7 OBSOLETE PARTS: OBSOLETE CIS STREAMLINING PER D.RENAUD/D.SINISI
- 8 ORANGE COLOR STRIPE ON HOUSING (NOT SHOWN) MAY RUN DOWN BETWEEN RIBS.

TIN	47.55[1.872]	12	4-647479-2	
TIN	43.59[1.716]	11	4-647479-1	
TIN	39.62[1.560]	10	4-647479-0	
TIN	35.66[1.404]	9	3-647479-9	
TIN	31.70[1.248]	8	3-647479-8	
TIN	27.74[1.092]	7	3-647479-7	
TIN	23.77[.936]	6	3-647479-6	
TIN	19.81[.780]	5	3-647479-5	
TIN	15.85[.624]	4	3-647479-4	
TIN	11.89[.468]	3	3-647479-3	
TIN	7.92[.312]	2	3-647479-2	
TIN-LEAD	47.55[1.872]	12	1-647479-2	
7 SUPERSEDED	TIN-LEAD 43.59[1.716]	11	1-647479-1	
	TIN-LEAD 39.62[1.560]	10	1-647479-0	
7 SUPERSEDED	TIN-LEAD 35.66[1.404]	9	647479-9	
7 SUPERSEDED	TIN-LEAD 31.70[1.248]	8	647479-8	
7 SUPERSEDED	TIN-LEAD 27.74[1.092]	7	647479-7	
7 SUPERSEDED	TIN-LEAD 23.77[.936]	6	647479-6	
	TIN-LEAD 19.81[.780]	5	647479-5	
	TIN-LEAD 15.85[.624]	4	647479-4	
	TIN-LEAD 11.89[.468]	3	647479-3	
	TIN-LEAD 7.92[.312]	2	647479-2	
	FINISH	DIM A	NO. OF CIRCUITS	PART NO.

THIS DRAWING IS A CONTROLLED DOCUMENT.		DWN K. WHITAKER 15-MAR-04	TE Connectivity	
DIMENSIONS: mm [INCHES]		CHK D. BOSSI 15-MAR-04		
TOLERANCES UNLESS OTHERWISE SPECIFIED:		APVD D. BOSSI 15-MAR-04	NAME MTA-156 CONNECTOR ASSEMBLY, 18 AWG, STANDARD	
0 PLC ± - 1 PLC ± - 2 PLC ± - 3 PLC ± - 4 PLC ± - ANGLES ± -		PRODUCT SPEC 108-1051	SIZE A2	CAGE CODE 00779
MATERIAL 1		APPLICATION SPEC 114-1020	DRAWING NO C=647479	RESTRICTED TO -
FINISH 1		WEIGHT -	SCALE 4:1	SHEET 1 OF 1
		CUSTOMER DRAWING	REV G	

