



Chipsmall Limited consists of a professional team with an average of over 10 year of expertise in the distribution of electronic components. Based in Hongkong, we have already established firm and mutual-benefit business relationships with customers from,Europe,America and south Asia,supplying obsolete and hard-to-find components to meet their specific needs.

With the principle of “Quality Parts,Customers Priority,Honest Operation,and Considerate Service”,our business mainly focus on the distribution of electronic components. Line cards we deal with include Microchip,ALPS,ROHM,Xilinx,Pulse,ON,Everlight and Freescale. Main products comprise IC,Modules,Potentiometer,IC Socket,Relay,Connector.Our parts cover such applications as commercial,industrial, and automotives areas.

We are looking forward to setting up business relationship with you and hope to provide you with the best service and solution. Let us make a better world for our industry!



## Contact us

Tel: +86-755-8981 8866 Fax: +86-755-8427 6832

Email & Skype: info@chipsmall.com Web: www.chipsmall.com

Address: A1208, Overseas Decoration Building, #122 Zhenhua RD., Futian, Shenzhen, China





DESCRIPTION: STD D-SUB SOCKET CONTACT, CRIMP  
 MODEL NUMBER: 40-9864S, 40-9866S, 40-9866SK  
 APPLICATION: FOR D-SUB  
 CRIMP TOOL: N/A  
 IMPEDANCE: N/A  
 FREQUENCY RANGE: N/A  
 MATERIAL: PHOSPHOR BRONZE GOLD PLATED  
 WIRE RANGE: 24-28 AWG  
 RoHS COMPLIANCE: YES  
 TECHNICAL DETAIL: N/A

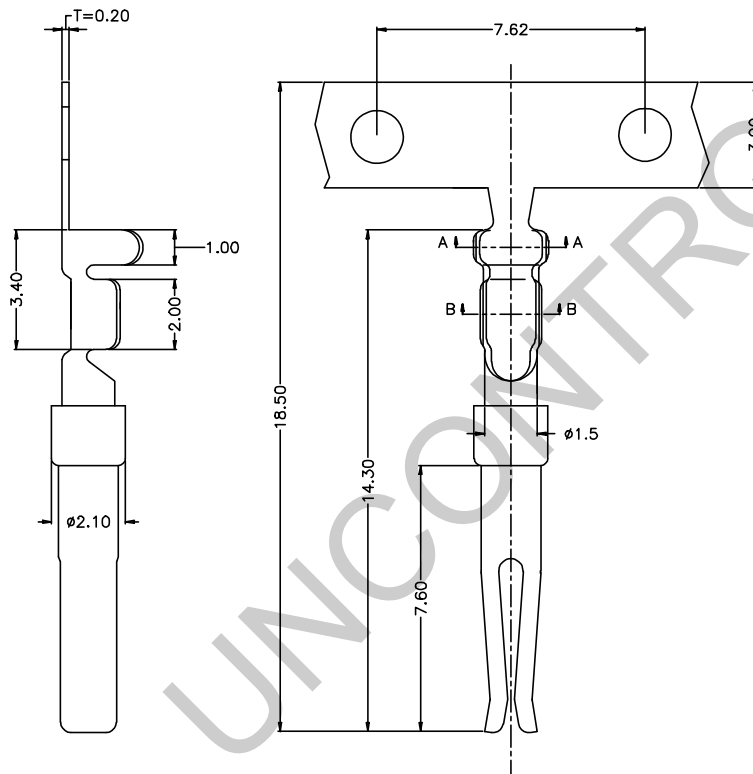

MODEL NUMBER	PACKAGE
40-9864S	25 PCS/BAG
40-9866S	100 PCS/BAG
40-9866SK	5K PCS/BAG

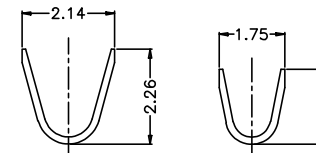

A-A SECTION

B-B SECTION

	3RD ANGLE PROJECTION 	<b>AIM-Cambridge</b>	
	RoHS2 <input checked="" type="checkbox"/> 2011/65/EU	Title: <b>D-SUB SOCKET CONTACT</b>	
<small>           This PROPRIETARY Document is property of Cinch Connectivity Solutions. It is confidential in nature, non-transferable, and issued with the clear understanding that it is not traced or copied without permission and is returnable upon demand.            INTERPRET DRAWING IN ACCORDANCE WITH ASME Y14.5-2009.         </small>	<small>UNLESS OTHERWISE SPECIFIED</small> UNITS: METRIC .XX ± .51 .XXX ± .127 ANGLES ± 2°	Model No. <b>40-98(64S)(66S)(66SK)</b>	
	Size <b>A</b>	DO NOT SCALE DRAWING	Date: <b>12/10/2013</b>