



Chipsmall Limited consists of a professional team with an average of over 10 year of expertise in the distribution of electronic components. Based in Hongkong, we have already established firm and mutual-benefit business relationships with customers from,Europe,America and south Asia,supplying obsolete and hard-to-find components to meet their specific needs.

With the principle of "Quality Parts,Customers Priority,Honest Operation,and Considerate Service",our business mainly focus on the distribution of electronic components. Line cards we deal with include Microchip,ALPS,ROHM,Xilinx,Pulse,ON,Everlight and Freescale. Main products comprise IC,Modules,Potentiometer,IC Socket,Relay,Connector.Our parts cover such applications as commercial,industrial, and automotives areas.

We are looking forward to setting up business relationship with you and hope to provide you with the best service and solution. Let us make a better world for our industry!



## Contact us

Tel: +86-755-8981 8866 Fax: +86-755-8427 6832

Email & Skype: info@chipsmall.com Web: www.chipsmall.com

Address: A1208, Overseas Decoration Building, #122 Zhenhua RD., Futian, Shenzhen, China



## SSS RELAIS 24V/230V 1AAC

**Weidmüller Interface GmbH & Co. KG**

Klingenbergstraße 16

D-32758 Detmold

Germany

Fon: +49 5231 14-0

Fax: +49 5231 14-292083

www.weidmueller.com



TERMSERIES accessories include:

- Spare relay
- Base
- Partition plates
- Cross-connections
- Power-feed modules

### General ordering data

Order No.	<a href="#">4061210000</a>
Type	SSS RELAIS 24V/230V 1AAC
Version	Solid-state relay, Rated control voltage: 18 V DC... <b>24 V DC</b> ...30 V DC , Rated switching voltage: 24...240 V AC, Rated switching current: 1 A, Plug-in connection
GTIN (EAN)	4032248643813
Qty.	20 pc(s).

**SSS RELAIS 24V/230V 1AAC****Weidmüller Interface GmbH & Co. KG**

Klingenbergstraße 16

D-32758 Detmold

Germany

Fon: +49 5231 14-0

Fax: +49 5231 14-292083

www.weidmueller.com

**Technical data****Dimensions and weights**

Width	5 mm	Height	28 mm
Depth	15 mm	Weight	3.65 g
Net weight	3.53 g		

**Temperatures**

Operating temperature	-20 °C...+60 °C	Storage temperature	-40 °C...+70 °C
-----------------------	-----------------	---------------------	-----------------

**Control side**

Rated control voltage	18 V DC... <b>24 V DC</b> ...30 V DC	Nominal control current	7 mA DC (± 10 %)
Power rating	170 mW		

**Load side**

Rated switching voltage	24...240 V AC	Continuous current	1 A
Rated switching current	1 A	Switch-on delay	< 11 ms
Switch-off delay	< 11 ms	Leakage current	< 10 µA
Voltage drop at max. load	≤ 1 V	Load side status indicator	No
Short-circuit-proof	No		

**General data**

Solid-state type	Triac (no-voltage switch)	No. of poles	1
Conductor connection system	Plug-in connection	Humidity	40 °C / 93 % rel. humidity, no condensation

**Insulation coordination**

Clearance and creepage distances for control side - load side	≥ 5.5 mm	Dielectric strength for control side - load side	3.75 KV <sub>eff</sub> / 1 min.
---	----------	--	---------------------------------

**Classifications**

ETIM 3.0	EC001504	UNSPSC	30-21-18-01
eClass 4.1	27-27-09-00	eClass 5.1	27-27-09-90
eClass 6.0	27-37-16-01	eClass 7.0	27-37-16-01

**Approvals**

Approvals



**SSS RELAIS 24V/230V 1AAC**

**Weidmüller Interface GmbH & Co. KG**  
 Klingenbergstraße 16  
 D-32758 Detmold  
 Germany  
 Fon: +49 5231 14-0  
 Fax: +49 5231 14-292083  
 www.weidmueller.com

**Drawings**

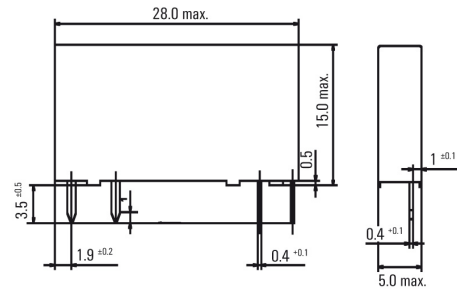
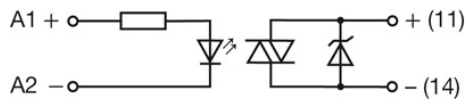



## SSS RELAIS 24V/230V 1AAC

**Weidmüller Interface GmbH & Co. KG**

Klingenbergstraße 16

D-32758 Detmold

Germany

Fon: +49 5231 14-0

Fax: +49 5231 14-292083

www.weidmueller.com

## Mating connector (fully pluggable)

### Screw connection

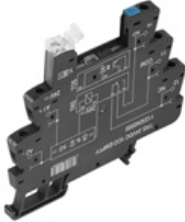

TERMSERIES accessories include:

- Spare relay
- Base
- Partition plates
- Cross-connections
- Power-feed modules

### General ordering data

Order No.	Type	Version	GTIN (EAN)	Qty.
<a href="#">1123250000</a>	TRS 24VUC 1CO EMPTY	TERMSERIES, Relay base, Continuous current: 10 A, Screw connection	4032248905713	10 pc(s).
<a href="#">1123330000</a>	TRS 24-230VUC 1CO EMPTY	TERMSERIES, Relay base, Continuous current: 10 A, Screw connection	4032248905614	10 pc(s).
<a href="#">1123240000</a>	TRS 24VDC 1CO EMPTY	TERMSERIES, Relay base, Continuous current: 10 A, Screw connection	4032248905485	10 pc(s).
<a href="#">1123270000</a>	TRS 48VUC 1CO EMPTY	TERMSERIES, Relay base, Continuous current: 10 A, Screw connection	4032248905423	10 pc(s).

### Tension clamp connection

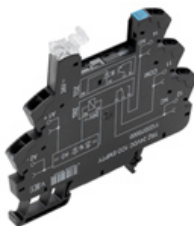

TERMSERIES accessories include:

- Spare relay
- Base
- Partition plates
- Cross-connections
- Power-feed modules

### General ordering data

Order No.	Type	Version	GTIN (EAN)	Qty.
<a href="#">1123390000</a>	TRZ 48VUC 1CO EMPTY	TERMSERIES, Relay base, Continuous current: 10 A, Tension clamp connection	4032248905331	10 pc(s).
<a href="#">1123380000</a>	TRZ 24VUC 1CO EMPTY	TERMSERIES, Relay base, Continuous current: 10 A, Tension clamp connection	4032248905195	10 pc(s).
<a href="#">1123370000</a>	TRZ 24VDC 1CO EMPTY	TERMSERIES, Relay base, Continuous current: 10 A, Tension clamp connection	4032248905324	10 pc(s).

**SSS RELAIS 24V/230V 1AAC****Weidmüller Interface GmbH & Co. KG**

Klingenbergstraße 16

D-32758 Detmold

Germany

Fon: +49 5231 14-0

Fax: +49 5231 14-292083

www.weidmueller.com

**Mating connector (fully pluggable)**[1123450000](#) TRZ 24-230VUC 1CO EMPTY

TERMSERIES, Relay base, 4032248905508 10 pc(s).

Continuous current: 10 A,

Tension clamp connection