



Chipsmall Limited consists of a professional team with an average of over 10 year of expertise in the distribution of electronic components. Based in Hongkong, we have already established firm and mutual-benefit business relationships with customers from,Europe,America and south Asia,supplying obsolete and hard-to-find components to meet their specific needs.

With the principle of “Quality Parts,Customers Priority,Honest Operation,and Considerate Service”,our business mainly focus on the distribution of electronic components. Line cards we deal with include Microchip,ALPS,ROHM,Xilinx,Pulse,ON,Everlight and Freescale. Main products comprise IC,Modules,Potentiometer,IC Socket,Relay,Connector.Our parts cover such applications as commercial,industrial, and automotives areas.

We are looking forward to setting up business relationship with you and hope to provide you with the best service and solution. Let us make a better world for our industry!



## Contact us

Tel: +86-755-8981 8866 Fax: +86-755-8427 6832

Email & Skype: info@chipsmall.com Web: www.chipsmall.com

Address: A1208, Overseas Decoration Building, #122 Zhenhua RD., Futian, Shenzhen, China



# DUAL-IN-LINE SOCKETS

## SERIES 110, 410 • RELAY AND ZIG-ZAG SOCKETS

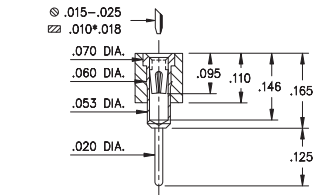

Fig. 1

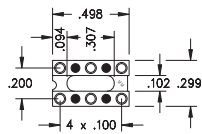

Fig. 2

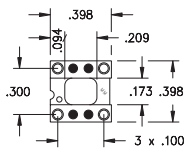

Fig. 3

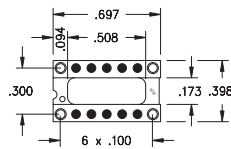
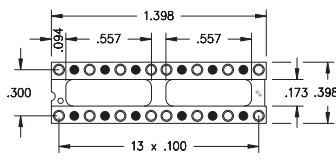
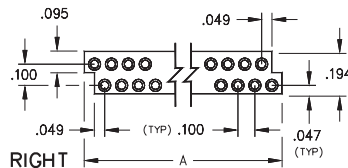
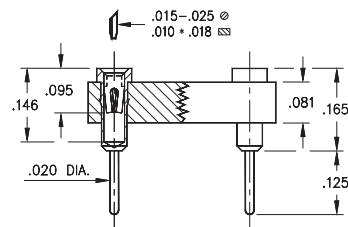
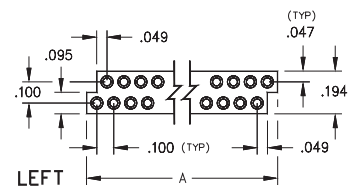

Fig. 4



○ = Loaded Position   ● = Empty Position



- Relay sockets accept devices with I/O pins on .100" grid
- Additional Relay DIP socket patterns are available on Page 135
- Zig-Zag strip sockets are suitable for IC's and memory chips with staggered double row patterns
- Series 110 and 410 use MM #1001 receptacles. See page 165 for details
- Hi-Rel, 4-finger BeCu #30 contact is rated at 3 amps. See page 253 for details
- Insulators are high temperature thermoplastic, suitable for all soldering operations
- For Electrical, Mechanical and Environmental Data, see page 264 for details

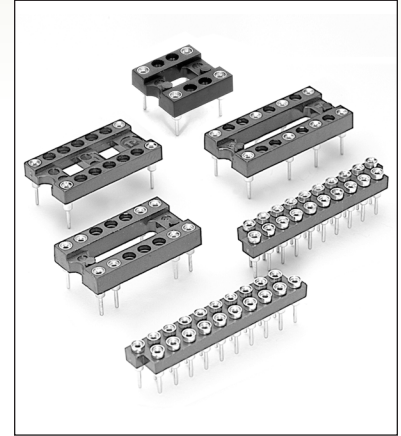

## ORDERING INFORMATION

### Selectively Loaded Sockets For Dual-In-Line Relays



	Number of Pins	Ordering Information
<b>FIG. 1</b>	6	110-XX-210-10-001000
<b>FIG. 2</b>	4	110-XX-308-10-001000
<b>FIG. 3</b>	4	110-XX-314-10-001000
<b>FIG. 4</b>	16	110-XX-328-10-001000

### Staggered (Zig-Zag) Strip Sockets

Dim 'A'	Number of Pins	Insulator Body	Ordering Information
0.747	14	Left, Stackable	410-XX-214-10-001000
0.747	14	Right, Stackable	410-XX-214-10-002000
0.847	16	Left, Stackable	410-XX-216-10-001000
0.847	16	Right, Stackable	410-XX-216-10-002000
1.047	20	Left, Stackable	410-XX-220-10-001000
1.047	20	Right, Stackable	410-XX-220-10-002000
1.247	24	Left, Stackable	410-XX-224-10-001000
1.247	24	Right, Stackable	410-XX-224-10-002000
1.447	28	Left, Stackable	410-XX-228-10-001000
1.447	28	Right, Stackable	410-XX-228-10-002000

XX=Plating Code  
See Below

RoHS-2  
2011/65/EU

SPECIFY PLATING CODE XX=	13	93	43
Sleeve (Pin) 	10 μ" Au	200 μ" Sn/Pb	200 μ" Sn
Contact (Clip) 	30 μ" Au	30 μ" Au	30 μ" Au

