



Chipsmall Limited consists of a professional team with an average of over 10 year of expertise in the distribution of electronic components. Based in Hongkong, we have already established firm and mutual-benefit business relationships with customers from,Europe,America and south Asia,supplying obsolete and hard-to-find components to meet their specific needs.

With the principle of "Quality Parts,Customers Priority,Honest Operation,and Considerate Service",our business mainly focus on the distribution of electronic components. Line cards we deal with include Microchip,ALPS,ROHM,Xilinx,Pulse,ON,Everlight and Freescale. Main products comprise IC,Modules,Potentiometer,IC Socket,Relay,Connector.Our parts cover such applications as commercial,industrial, and automotives areas.

We are looking forward to setting up business relationship with you and hope to provide you with the best service and solution. Let us make a better world for our industry!



## Contact us

Tel: +86-755-8981 8866 Fax: +86-755-8427 6832

Email & Skype: info@chipsmall.com Web: www.chipsmall.com

Address: A1208, Overseas Decoration Building, #122 Zhenhua RD., Futian, Shenzhen, China



1970

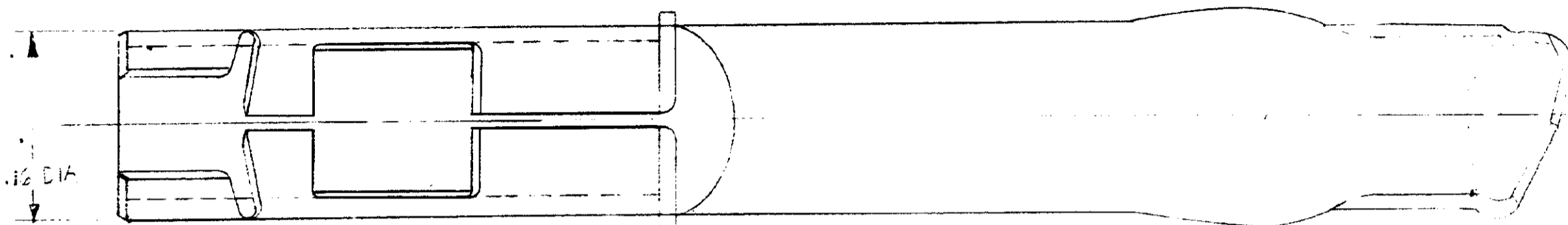

.74

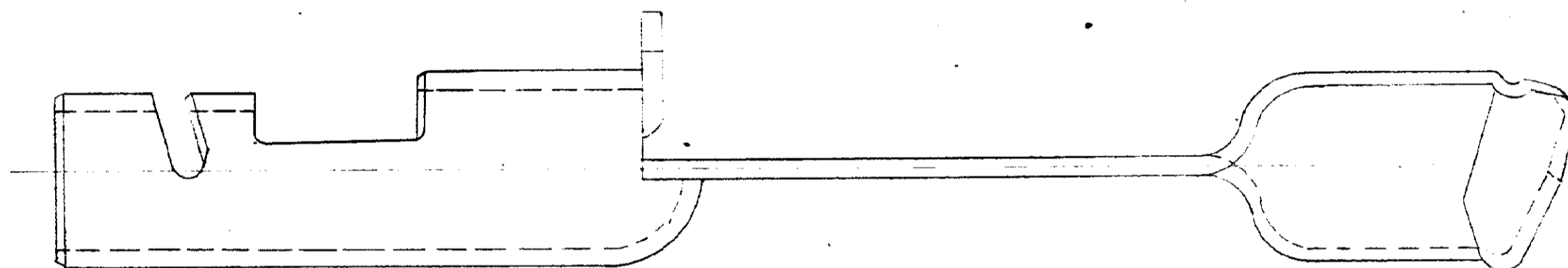

1.20

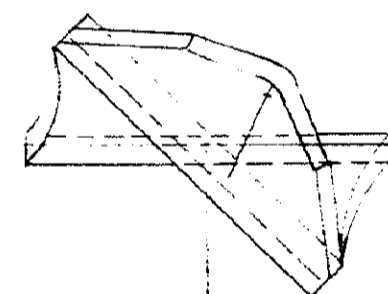

421336-7	GOLD
421336-2	TIN
PART NO.	PLATING

DIMENSIONS IN INCHES. DO NOT SCALE PRINT.

12

REV	DATE	BY	DESCRIPTION
A	9-4-70	W. Baker	-7 WAS -3
0	9-4-70	W. Baker	RELEASE TO CUST

REQUIRED PER ASSEMBLY		DWG SIZE	NUMBER	NAME	REMARKS	ITEM NO.
		MATERIAL	FINE GRAIN BRASS	HEAT TREAT	COATING OR PLATING	SEE ABOVE
		WIRE RANGE	UNLESS OTHERWISE SPECIFIED REMOVE BURRS, BREAK SHARP EDGES .015 R MAX DECIMALS: .00 = .02, .000 = .005, .0000 = .0005			
		AREA	ANGLES: 20° 30'			
		CLASS	TYPE	LANCER LOK	AMP INCORPORATED HARRISBURG, PENNA.	
		DR	E. Zimmerman	9-4-70	FIRST USED	
		CHK	W. Baker	9-4-70	PPF	
		APP	Leon Yocum	9/4/70	SCALE	10:1
		REL			NAME	SPRING - LEFT HAND
				LOC	SC	421336
				REV	A	

CUSTOMER DRAWING