



Chipsmall Limited consists of a professional team with an average of over 10 year of expertise in the distribution of electronic components. Based in Hongkong, we have already established firm and mutual-benefit business relationships with customers from,Europe,America and south Asia,supplying obsolete and hard-to-find components to meet their specific needs.

With the principle of "Quality Parts,Customers Priority,Honest Operation,and Considerate Service",our business mainly focus on the distribution of electronic components. Line cards we deal with include Microchip,ALPS,ROHM,Xilinx,Pulse,ON,Everlight and Freescale. Main products comprise IC,Modules,Potentiometer,IC Socket,Relay,Connector.Our parts cover such applications as commercial,industrial, and automotives areas.

We are looking forward to setting up business relationship with you and hope to provide you with the best service and solution. Let us make a better world for our industry!



## Contact us

Tel: +86-755-8981 8866 Fax: +86-755-8427 6832

Email & Skype: info@chipsmall.com Web: www.chipsmall.com

Address: A1208, Overseas Decoration Building, #122 Zhenhua RD., Futian, Shenzhen, China



DRAWING MADE IN THIRD ANGLE PROJECTION

© COPYRIGHT 1960 BY AMP INCORPORATED, HARRISBURG, PA.  
ALL INTERNATIONAL RIGHTS RESERVED. AMP INCORPORATED PRODUCTS  
COVERED BY U.S. AND FOREIGN PATENTS AND/OR PATENTS PENDING.

AC	OBS -2 PER AD1831	3-22-88	UB
AD	REV PER 0010-1582-95	1-30-97	PB/RR
AE	REV PER EC 0320-344-97	24 Nov 97	NJS
AE1	REVISED PER ECO-09-026346	25NOV09	AEG

REVISIONS									
		ZONE	LTR	DESCRIPTION	DATE	APPROVED			
✓	W			REDRAWN PER ECN 3834 m.s.	6-12-73				
✓	Y			REVISED	4501 m.s.	7-28-75			
✓	Y1			ADDED -9	6507 m.s.	3-80			
✓	Z			REVISED PLATING	7665 12.	11-13-81			
✓	AA			REVISED	7818 m.s.	2-82			
✓	AA1			OBS -7-B & -9 AD1112	2-11-86	SP			
✓	AB			REV PER AD1327	7-23-86	EP/RR			

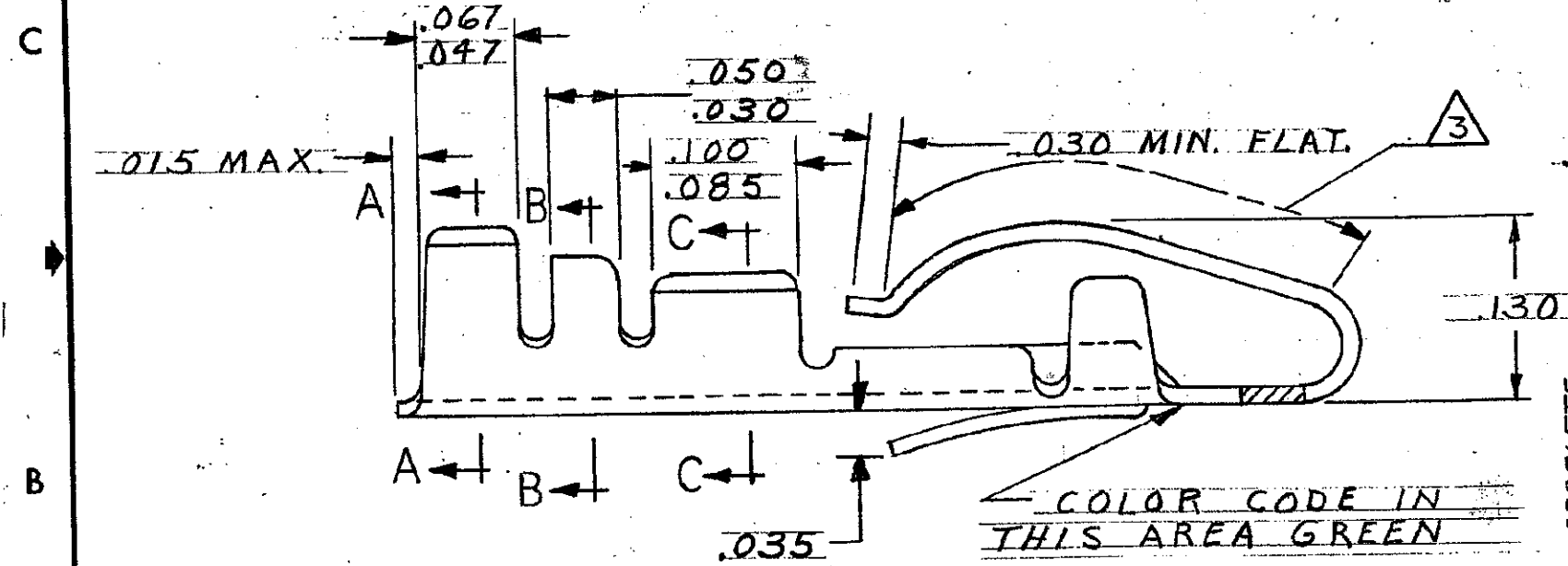
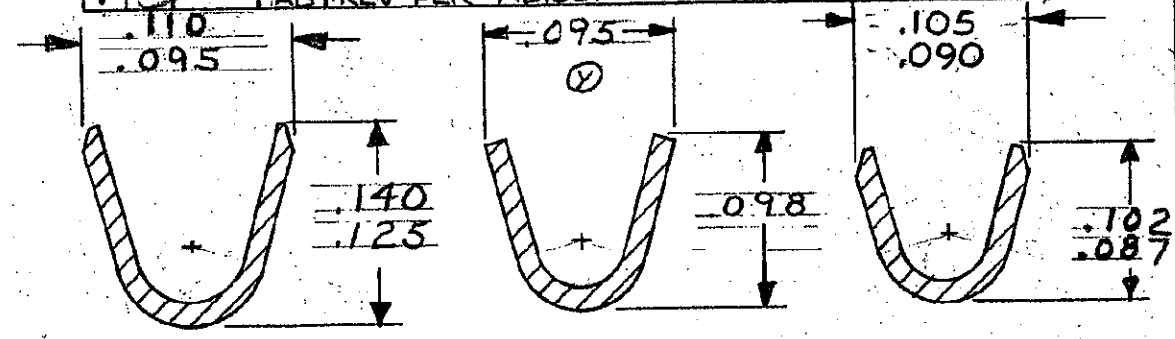
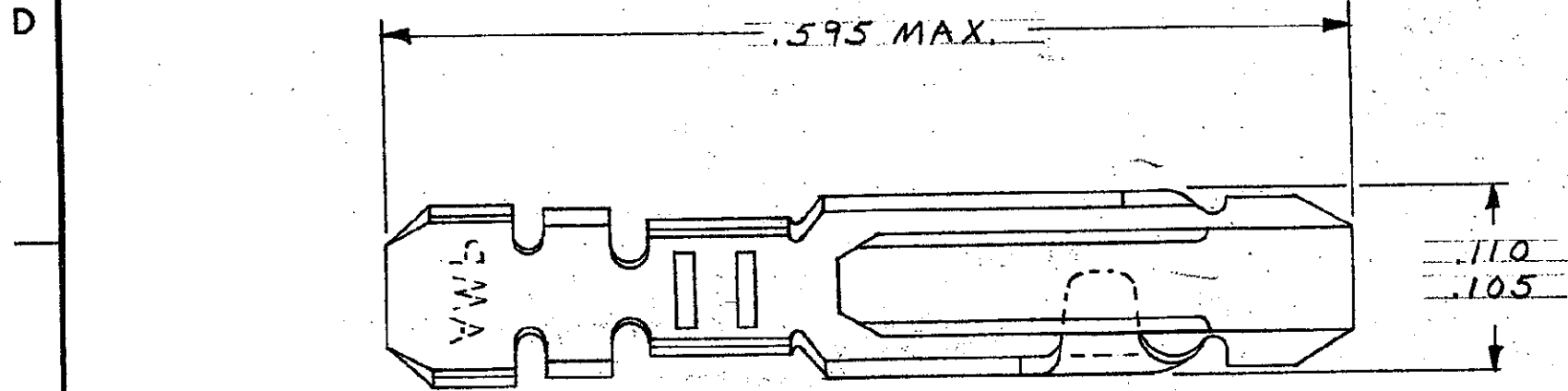

SECT. A-A INSULATION RANGE .055 - .080  
SECT. B-B WIRE RANGE #22 - #18  
SECT. C-C WIRE RANGE #22 - #18

OBSELETE	PART NO.	FINISH
△	42840-9	
	42840-8	.000030 GOLD IN CONTACT AREA ONLY OVER .000030 NICKEL ALL OVER.
	42840-7	.000006 GOLD OVER NICKEL
△	42840-6	.000015 GOLD OVER .000050 NICKEL
	42840-3	.00003 GOLD OVER NICKEL
	42840-2	TIN

- △ 1 PHOS. BRONZE, .010 COMM.
- △ 2 .120 MAX. SUM OF INSULATION DIAMETERS.
- △ 3 .000015 GOLD OVER .000050 NICKEL IN CONTACT AREA, REMAINDER OF CONTACT NICKEL PLATED.

△ 4 OBSOLETE PARTS: OBSOLETE CIS STREAMLINING PER D.RENAUD/D.SINISI

CODE IDENT	DWG SIZE	PART NO OR IDENTIFYING NO	NOMENCLATURE OR DESCRIPTION	ITEM NO
REVISION OF EACH ASSY NO (WHEN BLANK, USE DWG REVISION)				
QTY REQD PER ASSY		PARTS LIST		
UNLESS OTHERWISE SPECIFIED DIMENSIONS ARE IN INCHES. TOLERANCES ON: DECIMALS ± .005 ANGLES ±	CONTRACT NO DR <i>M. Smich</i> 6-12-73 CHK <i>M. J. Lee</i> 6-14-73 APPD <i>D. J. ...</i> 6-15-73 APPD <i>R. ...</i> 6-15-73	AMP INCORPORATED Harrisburg, Pa. NAME AMP LEAF CONTACT LOOSE PIECE		
MATERIAL △	DSGN APPD	SIZE B	CODE IDENT NO 00779	NUMBER 42840
FINISH	OTHER APPD	SCALE NTS	SHEET 1 OF 1	

CUSTOMER DRAWING