



Chipsmall Limited consists of a professional team with an average of over 10 year of expertise in the distribution of electronic components. Based in Hongkong, we have already established firm and mutual-benefit business relationships with customers from,Europe,America and south Asia,supplying obsolete and hard-to-find components to meet their specific needs.

With the principle of “Quality Parts,Customers Priority,Honest Operation,and Considerate Service”,our business mainly focus on the distribution of electronic components. Line cards we deal with include Microchip,ALPS,ROHM,Xilinx,Pulse,ON,Everlight and Freescale. Main products comprise IC,Modules,Potentiometer,IC Socket,Relay,Connector.Our parts cover such applications as commercial,industrial, and automotives areas.

We are looking forward to setting up business relationship with you and hope to provide you with the best service and solution. Let us make a better world for our industry!



Contact us

Tel: +86-755-8981 8866 Fax: +86-755-8427 6832

Email & Skype: info@chipsmall.com Web: www.chipsmall.com

Address: A1208, Overseas Decoration Building, #122 Zhenhua RD., Futian, Shenzhen, China



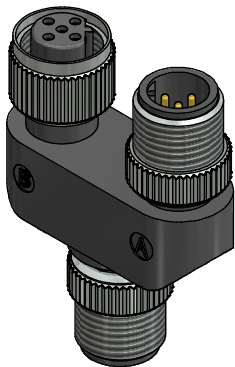
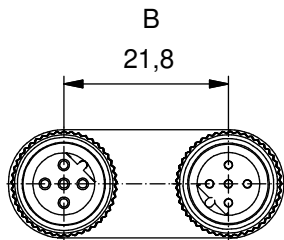
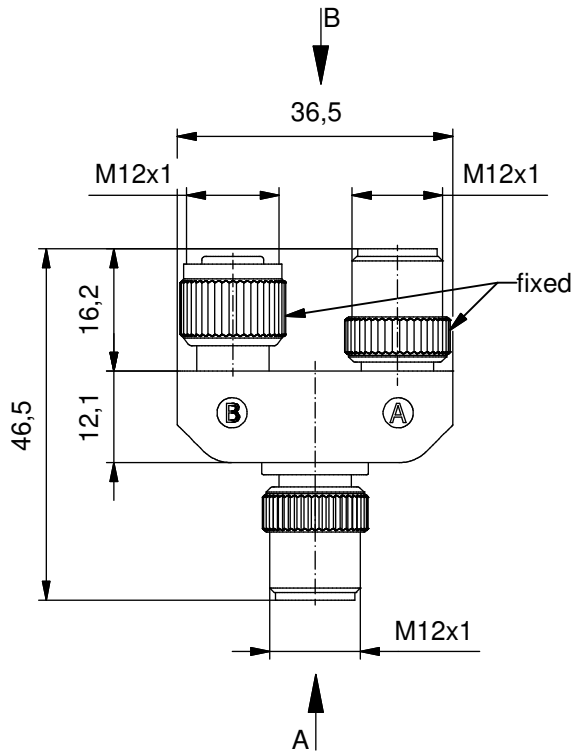
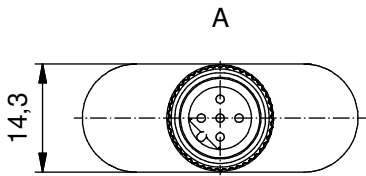

Technical specification:

Rated voltage: 60 V
IEC 61076-2-101

Current rating: 4A bei 40°C
IEC 61076-2-101

Insulation resistance: >=100 MΩ
IEC 60512

Pollution degree: 3/2
IEC 60664-1

Degree of protection: IP 65, in mated condition
IEC 60529

Temperature range: -30°C ... +85°C
IEC 60664-1

Mating cycles: >=100
IEC 60512-9a

Materials:

Contact: CuZn

Contact plating: Nickel, gold plated

Contact carrier: PBT GF, UL 94

Sealing: FPM

Body: Thermoplastic Elastomer, RAL 9004

Installation specification:

Recommended torque: 0,6 Nm

4x Inductance 110nH

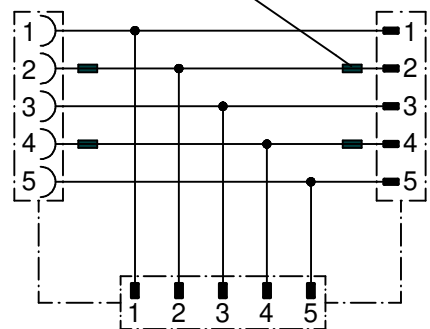

Part no:	Description:
43-11210	SAL - 12B - RS5 - RK5 - RS5

DO NOT ALTER CAD DRAWING BY HAND Directive 2002/95/EC RoHS compliant	Index: a 24.08.11 VF Ä3941 data sheet revised	dim. in mm	title: Junction box, Profibus DP, M12x1									
	tolerance of cable:	<table border="1"> <thead> <tr> <th></th> <th>date</th> <th>name</th> </tr> </thead> <tbody> <tr> <td>drawn</td> <td>30.10.07</td> <td>Mankopf</td> </tr> <tr> <td>appd.</td> <td>30.10.07</td> <td>Fromm</td> </tr> </tbody> </table>		date	name	drawn	30.10.07	Mankopf	appd.	30.10.07	Fromm	dwg no: 43K1A563
		date	name									
	drawn	30.10.07	Mankopf									
appd.	30.10.07	Fromm										
general tolerance:		part no: see table										
<small>THIS DRAWING MAY NOT BE COPIED OR REPRODUCED IN ANY WAY, AND MAY NOT BE PASSED ON TO A THIRD PARTY WITHOUT WRITTEN PERMISSION. OWNERSHIP AND COPYRIGHT OF CONEC GmbH</small>												