



Chipsmall Limited consists of a professional team with an average of over 10 year of expertise in the distribution of electronic components. Based in Hongkong, we have already established firm and mutual-benefit business relationships with customers from,Europe,America and south Asia,supplying obsolete and hard-to-find components to meet their specific needs.

With the principle of "Quality Parts,Customers Priority,Honest Operation,and Considerate Service",our business mainly focus on the distribution of electronic components. Line cards we deal with include Microchip,ALPS,ROHM,Xilinx,Pulse,ON,Everlight and Freescale. Main products comprise IC,Modules,Potentiometer,IC Socket,Relay,Connector.Our parts cover such applications as commercial,industrial, and automotives areas.

We are looking forward to setting up business relationship with you and hope to provide you with the best service and solution. Let us make a better world for our industry!



Contact us

Tel: +86-755-8981 8866 Fax: +86-755-8427 6832

Email & Skype: info@chipsmall.com Web: www.chipsmall.com

Address: A1208, Overseas Decoration Building, #122 Zhenhua RD., Futian, Shenzhen, China



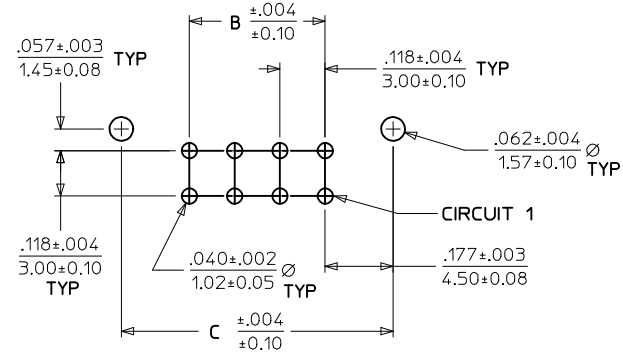
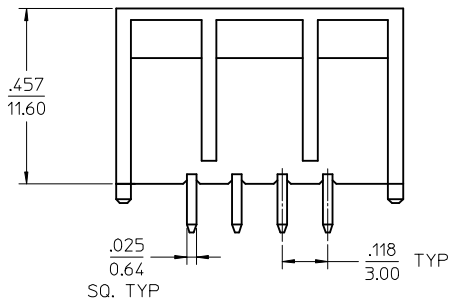
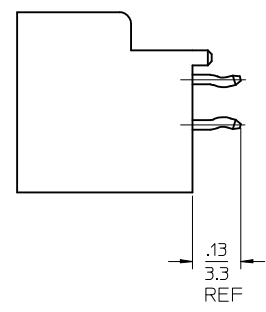
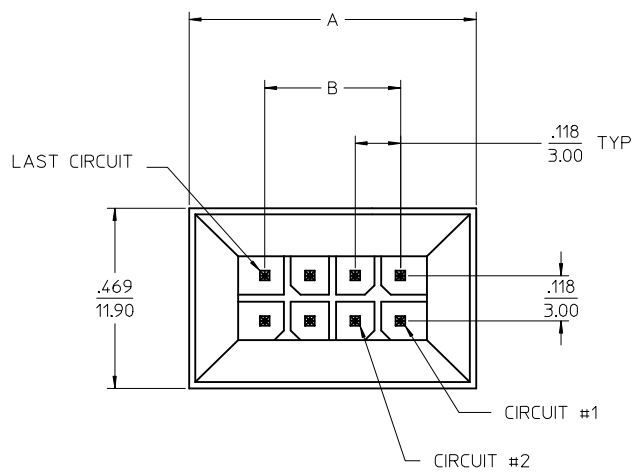

PCB LAYOUT: COMPONENT SIDE
RECOMMENDED PCB THICKNESS .062/1.57

CIRCUIT SIZE	"A"	"B"	C
04	$\frac{.512}{13.00}$	$\frac{.118}{3.00}$	$\frac{.472}{12.00}$
06	$\frac{.630}{16.00}$	$\frac{.236}{6.00}$	$\frac{.590}{15.00}$
08	$\frac{.748}{19.00}$	$\frac{.354}{9.00}$	$\frac{.709}{18.00}$
10	$\frac{.866}{22.00}$	$\frac{.472}{12.00}$	$\frac{.827}{21.00}$
12	$\frac{.984}{25.00}$	$\frac{.590}{15.00}$	$\frac{.945}{24.00}$
14	$\frac{1.102}{28.00}$	$\frac{.709}{18.00}$	$\frac{1.063}{27.00}$
16	$\frac{1.220}{31.00}$	$\frac{.827}{21.00}$	$\frac{1.181}{30.00}$
18	$\frac{1.338}{34.00}$	$\frac{.945}{24.00}$	$\frac{1.299}{33.00}$
20	$\frac{1.457}{37.00}$	$\frac{1.063}{27.00}$	$\frac{1.417}{36.00}$
22	$\frac{1.575}{40.00}$	$\frac{1.181}{30.00}$	$\frac{1.535}{39.00}$
24	$\frac{1.693}{43.00}$	$\frac{1.299}{33.00}$	$\frac{1.653}{42.00}$

NOTES :

- MATERIALS -
HOUSING : NYLON , GLASS-FILLED, UL94V-0 COLOR - BLACK
TERMINAL : BRASS ALLOY
- FINISH:
A = .000200/(0.00508) MIN. TIN OVER .000050/(0.00127) MIN. NICKEL.
B = .000015/(0.00038) MIN. SELECT GOLD IN CONTACT AREA;
.000100/(0.00254) MIN. SELECT TIN ON SOLDER TAILS;
BOTH OVER .000050/(0.00127) MIN. NICKEL.
C = .000030/(0.00076) MIN. SELECT GOLD IN CONTACT AREA;
.000100/(0.00254) MIN. SELECT TIN ON SOLDER TAILS;
BOTH OVER .000050/(0.00127) MIN. NICKEL.
- PRODUCT SPECIFICATION : PS-44300-001
- PACKAGING SPECIFICATION : PK-44432-001
- THIS ASSEMBLY MATES WITH MOLEX BMI PANEL MOUNT RECEPTACLE (SEE DRAWING SD-44133-001) & FEMALE CRIMP TERMINAL (SEE DRAWING SD-43030-****)
- SEE SHEET 2 FOR PART NUMBER CHART.
- THIS PART CONFORMS TO CLASS B REQUIREMENTS OF COSMETIC SPECIFICATION PS-45499-002

ADD REFERENCE DIM EC NO: UCP2016-3971 DRWING:SLAFTER 2016/04/11 CHKD:JDFX 2016/04/11 APPR:FSMITH 2016/04/13	QUALITY SYMBOLS ▽=0 ▽=0 ▽=0	GENERAL TOLERANCES (UNLESS SPECIFIED)		DIMENSION STYLE IN/MM		SCALE 4:1	DESIGN UNITS METRIC	THIRD ANGLE PROJECTION		
		mm	INCH	DRAWN BY	DATE	MICRO FIT (3.0) DUAL ROW VERTICAL BMI HEADER ASS'Y molex DOCUMENT NO. SD-44432-001 SHEET NO. 1 OF 2				
		4 PLACES ± --- ± ---	3 PLACES ± --- ± .010	MUELLER	1999/11/29					
		2 PLACES ± 0.25 ± .015	1 PLACE ± 0.38 ± ---	MUELLER	1999/11/29					
0 PLACE ± --- ± ---		APPROVED BY	DATE							
		ANGULAR ±1/2°		MATERIAL NO. SEE CHART						
DRAFT WHERE APPLICABLE MUST REMAIN WITHIN DIMENSIONS		SIZE C		THIS DRAWING CONTAINS INFORMATION THAT IS PROPRIETARY TO MOLEX. INCORPORATED AND SHOULD NOT BE USED WITHOUT WRITTEN PERMISSION						

	13	12	11	10	9	8	7	6	5	4	3	2	1
J	MATERIAL NUMBER	NUMBER OF POSITIONS	PLATING OPTION										
	44432-0401	04	A										
	44432-0402	04	B										
	44432-0403	04	C										
I	44432-0601	06	A										
	44432-0602	06	B										
	44432-0603	06	C										
	44432-0801	08	A										
	44432-0802	08	B										
	44432-0803	08	C										
H	44432-1001	10	A										
	44432-1002	10	B										
	44432-1003	10	C										
	44432-1201	12	A										
	44432-1202	12	B										
G	44432-1203	12	C										
	44432-1401	14	A										
	44432-1402	14	B										
	44432-1403	14	C										
F	44432-1601	16	A										
	44432-1602	16	B										
	44432-1603	16	C										
	44432-1801	18	A										
	44432-1802	18	B										
	44432-1803	18	C										
E	44432-2001	20	A										
	44432-2002	20	B										
	44432-2003	20	C										
	44432-2201	22	A										
D	44432-2202	22	B										
	44432-2203	22	C										
	44432-2401	24	A										
	44432-2402	24	B										
C	44432-2403	24	C										

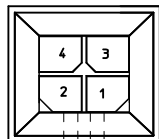

4 CIRCUIT

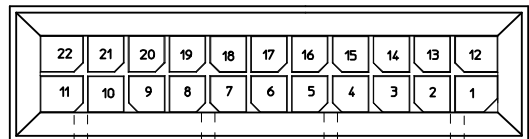

22 CIRCUIT

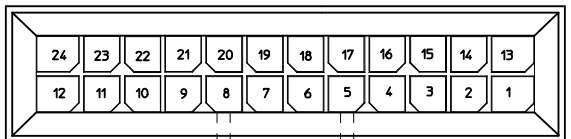

24 CIRCUIT

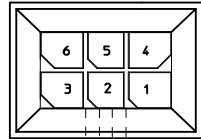

6 CIRCUIT

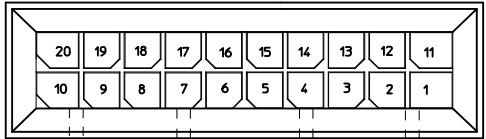

20 CIRCUIT

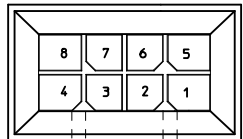

8 CIRCUIT

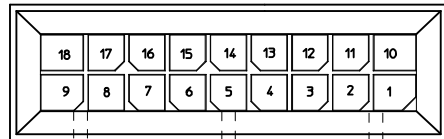

18 CIRCUIT

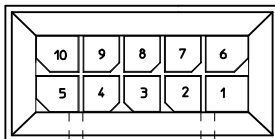

10 CIRCUIT

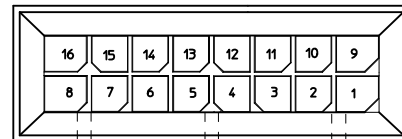

16 CIRCUIT

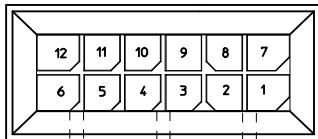

12 CIRCUIT

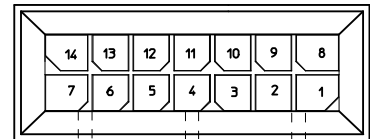

14 CIRCUIT

POLARIZATION LAYOUT
4-24 CIRCUITS

SEE SHEET 1 EC NO: UCP2016-3971 DRWNSLAFTER 2016/04/11 CHKD:JDFX 2016/04/11 APPR:FSMITH 2016/04/13 REV: D2	QUALITY SYMBOLS 	GENERAL TOLERANCES (UNLESS SPECIFIED) <table border="1"> <tr> <th></th> <th>mm</th> <th>INCH</th> </tr> <tr> <td>4 PLACES</td> <td>± .005</td> <td>± .0005</td> </tr> <tr> <td>3 PLACES</td> <td>± .010</td> <td>± .0010</td> </tr> <tr> <td>2 PLACES</td> <td>± .025</td> <td>± .0015</td> </tr> <tr> <td>1 PLACE</td> <td>± 0.38</td> <td>± .0150</td> </tr> <tr> <td>0 PLACE</td> <td>± .000</td> <td>± .0000</td> </tr> </table>		mm	INCH	4 PLACES	± .005	± .0005	3 PLACES	± .010	± .0010	2 PLACES	± .025	± .0015	1 PLACE	± 0.38	± .0150	0 PLACE	± .000	± .0000	DIMENSION STYLE IN/MM DRAWN BY: MUELLER DATE: 1999/11/29 CHECKED BY: MUELLER DATE: 1999/11/29 APPROVED BY: FSMITH DATE: 2016/04/13	SCALE 4:1 DESIGN UNITS METRIC THIRD ANGLE PROJECTION	TITLE MICRO FIT (3.0) DUAL ROW VERTICAL BMI HEADER ASS'Y molex	MATERIAL NO. SEE CHART DOCUMENT NO. SD-44432-001 SHEET NO. 2 OF 2
		mm	INCH																					
	4 PLACES	± .005	± .0005																					
	3 PLACES	± .010	± .0010																					
2 PLACES	± .025	± .0015																						
1 PLACE	± 0.38	± .0150																						
0 PLACE	± .000	± .0000																						
DRAFT WHERE APPLICABLE MUST REMAIN WITHIN DIMENSIONS		ANGULAR ±1/2°		THIS DRAWING CONTAINS INFORMATION THAT IS PROPRIETARY TO MOLEX INCORPORATED AND SHOULD NOT BE USED WITHOUT WRITTEN PERMISSION																				