

Chipsmall Limited consists of a professional team with an average of over 10 year of expertise in the distribution of electronic components. Based in Hongkong, we have already established firm and mutual-benefit business relationships with customers from,Europe,America and south Asia,supplying obsolete and hard-to-find components to meet their specific needs.

With the principle of “Quality Parts,Customers Priority,Honest Operation,and Considerate Service”,our business mainly focus on the distribution of electronic components. Line cards we deal with include Microchip,ALPS,ROHM,Xilinx,Pulse,ON,Everlight and Freescale. Main products comprise IC,Modules,Potentiometer,IC Socket,Relay,Connector.Our parts cover such applications as commercial,industrial, and automotives areas.

We are looking forward to setting up business relationship with you and hope to provide you with the best service and solution. Let us make a better world for our industry!



Contact us

Tel: +86-755-8981 8866 Fax: +86-755-8427 6832

Email & Skype: info@chipsmall.com Web: www.chipsmall.com

Address: A1208, Overseas Decoration Building, #122 Zhenhua RD., Futian, Shenzhen, China

THIS DRAWING IS UNPUBLISHED. RELEASED FOR PUBLICATION, 19
 © COPYRIGHT 19 BY AMP INCORPORATED. ALL INTERNATIONAL RIGHTS RESERVED.

LOC	DIST	P	F	REVISIONS				
DF	A0			ZONE	LTR	DESCRIPTION	DATE	APPD
					D	REV PER 063D-0201-00	CT	RG
							8-00	

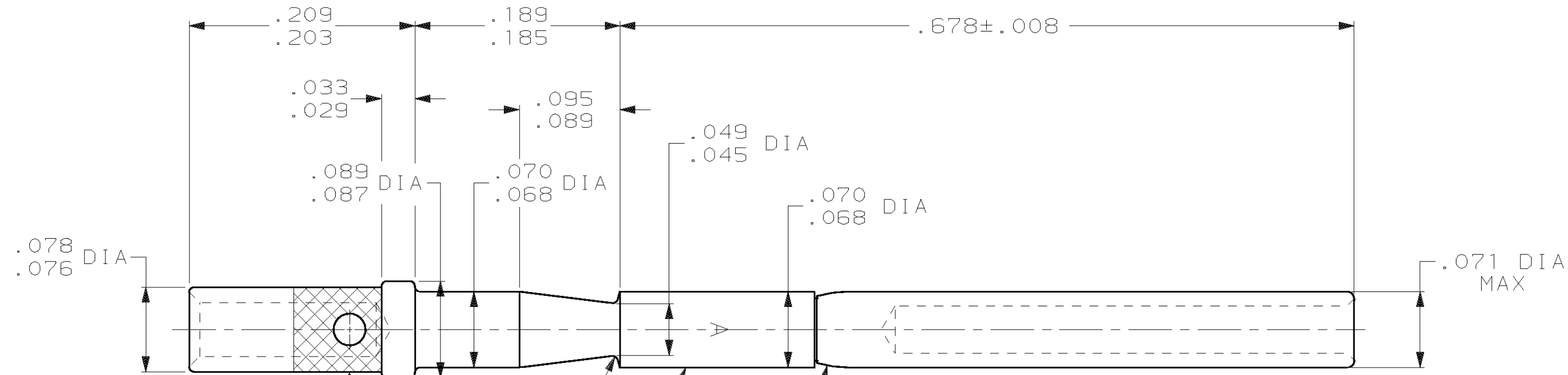

COLOR CODED BROWN

SOCKET BODY
 MAT'L: BeCu PER QQ-C-530
 FINISH: PLATED GOLD .000050 MIN THK PER MIL-G-45204 OVER NICKEL .000050 THK PER QQ-N-290

HOOD
 MATL: STAINLESS STEEL PER QQ-S-766
 FINISH: PASSIVATED PER QQ-P-35

1. CONTACT ACCEPTS 20-24 AWG WIRE.

445591-1
 PART NUMBER

DO NOT SCALE PRINT. UNLESS SPECIFIED DIMENSIONS IN INCHES TOLERANCES ON: 2 PLC DEC ± _____ 3 PLC DEC ± .005 ANGLES ± _____	DR 9-14-88 BRENT YOHN	AMP INCORPORATED Harrisburg, Pa. 17105
	CHK 9-14-88 E.HOWARD	
	APPD 9-14-88 E.HOWARD	NAME SOCKET ASSY, ARINC 404, SIZE 20, FRONT RLSE/REAR RMV, LOW INSERTION FORCE
	APPD 9-14-88 J.KALASKY	SIZE B FSCM NO 00779 DRAWING NO 445591
MATERIAL SEE CALLOUTS	PRODUCT SPEC -	SCALE 10:1 SHEET 1 OF 1
FINISH SEE CALLOUTS	APPLICATION SPEC -	
	WEIGHT -	