



Chipsmall Limited consists of a professional team with an average of over 10 year of expertise in the distribution of electronic components. Based in Hongkong, we have already established firm and mutual-benefit business relationships with customers from,Europe,America and south Asia,supplying obsolete and hard-to-find components to meet their specific needs.

With the principle of “Quality Parts,Customers Priority,Honest Operation,and Considerate Service”,our business mainly focus on the distribution of electronic components. Line cards we deal with include Microchip,ALPS,ROHM,Xilinx,Pulse,ON,Everlight and Freescale. Main products comprise IC,Modules,Potentiometer,IC Socket,Relay,Connector.Our parts cover such applications as commercial,industrial, and automotives areas.

We are looking forward to setting up business relationship with you and hope to provide you with the best service and solution. Let us make a better world for our industry!



Contact us

Tel: +86-755-8981 8866 Fax: +86-755-8427 6832

Email & Skype: info@chipsmall.com Web: www.chipsmall.com

Address: A1208, Overseas Decoration Building, #122 Zhenhua RD., Futian, Shenzhen, China



THIS DRAWING IS UNPUBLISHED. RELEASED FOR PUBLICATION , 19

© COPYRIGHT 19 BY AMP INCORPORATED. ALL INTERNATIONAL RIGHTS RESERVED.

PROJ LGC DIST
5049 DF A0

		REVISIONS			
ZONE	LTR	DESCRIPTION	DATE	APPD	
	0	RLSE/NPR 89-015 CCT	2-89	EH	
	A	REV PER ECN DF-1837 TW	5-89	EH	
✓	B	REV PER DF-3934 CT	6-89	12-70	

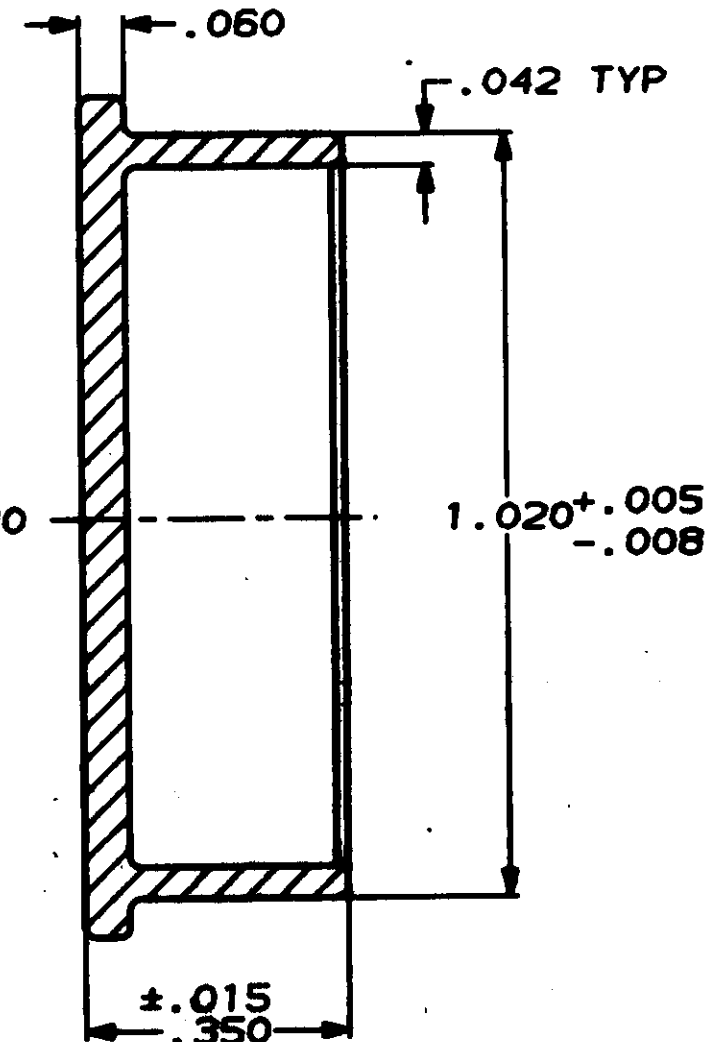
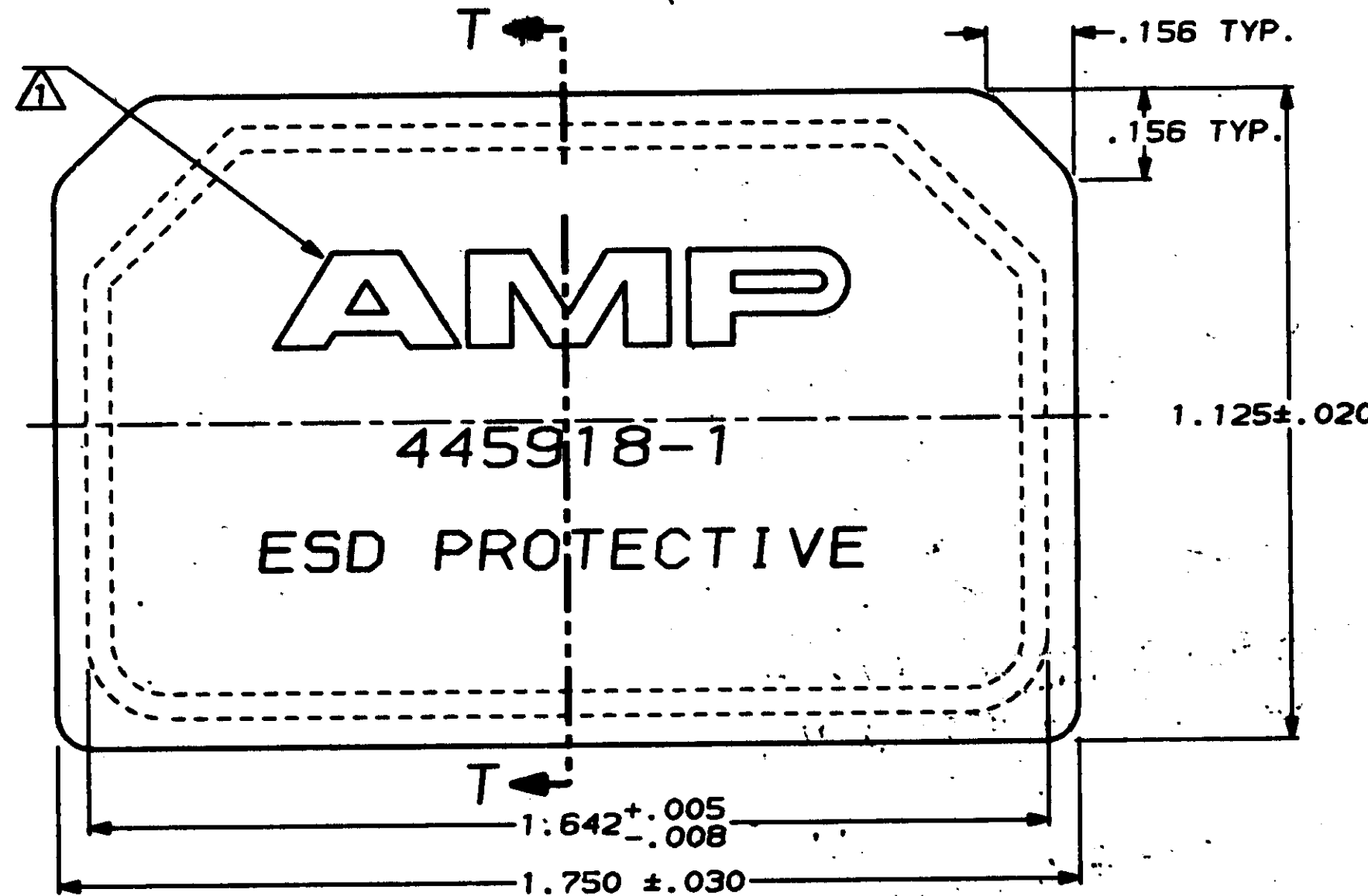

SECTION T-T

⚠ MARKING IS MOLDED IN AND RAISED .005-.012 ABOVE SURFACE APPROX: AS SHOWN.

DO NOT SCALE PRINT. UNLESS SPECIFIED DIMENSIONS IN INCHES TOLERANCES ON: Ø PLC DEC ± .005 Ø PLC DEC ± .008 ANGLES ± .5	ON 2-15-89 C.E. THOMPSON CHK 3-1-89 E. HENNING APPD 3-1-89 E. HENNING APPD 3-1-89 E. HENNING
MATERIAL CONDUCTIVE THERMOPLASTIC	PRODUCT SPEC -
FINISH BLACK	APPLICATION SPEC -
	RETRY -

SIZE B	PCN NO 00779	DRAWING NO 445918
SCALE 4:1	SHEET 1 OF 1	

445918-1	
PART NO	
AMP AMP INCORPORATED Harrisburg, Pa. 17106	
DUST COVER, ARINC 404 DUAL RECEPTACLE	

CUSTOMER DRAWING