



Chipsmall Limited consists of a professional team with an average of over 10 year of expertise in the distribution of electronic components. Based in Hongkong, we have already established firm and mutual-benefit business relationships with customers from,Europe,America and south Asia,supplying obsolete and hard-to-find components to meet their specific needs.

With the principle of “Quality Parts,Customers Priority,Honest Operation,and Considerate Service”,our business mainly focus on the distribution of electronic components. Line cards we deal with include Microchip,ALPS,ROHM,Xilinx,Pulse,ON,Everlight and Freescale. Main products comprise IC,Modules,Potentiometer,IC Socket,Relay,Connector.Our parts cover such applications as commercial,industrial, and automotives areas.

We are looking forward to setting up business relationship with you and hope to provide you with the best service and solution. Let us make a better world for our industry!



Contact us

Tel: +86-755-8981 8866 Fax: +86-755-8427 6832

Email & Skype: info@chipsmall.com Web: www.chipsmall.com

Address: A1208, Overseas Decoration Building, #122 Zhenhua RD., Futian, Shenzhen, China



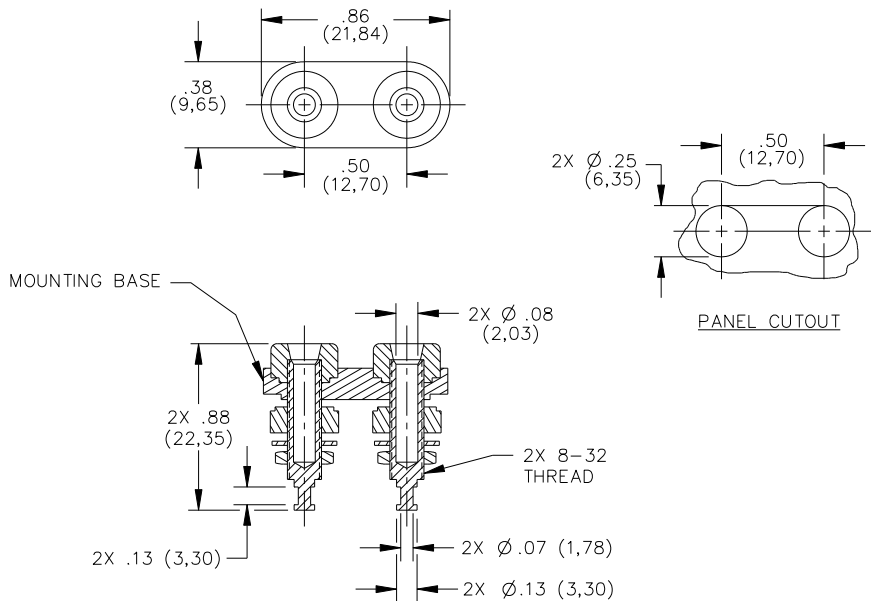

FEATURES:

- Accepts .080 dia. pin
- Max. panel thickness .188.

MATERIALS:

Miniature Insulation: Polycarbonate Thermoplastic molded to pin tip. Color: One Red and one Black.

Mounting Plate Insulation: Polycarbonate Thermoplastic

Panel Insulator: Polycarbonate Thermoplastic. Color: Matches color of pin tip jack insulator.

Lockwasher #8: Internal Tooth: Steel, Finish: Nickel plate per QQ-N-290 Class 2 (.0002 min.)

Hex Nut #8-32: Brass, Finish: Nickel plate per QQ-N-290 Class 2 (.0002 min.).

Pin Tip Jack Body: Gold Plated Brass H.H., Alloy 360

Spring: One piece Beryllium Copper, Berylco 25

Finish: Gold flash per MIL-G-45204 Type 2 .00001/.00002 over electroless nickel per MIL-C-26074A, Class 2, .0002/.0003 thick.

RATINGS:

Operating Temperature: +115°C. (+239°F.) Max.

Operating Voltage: 1500 VDC

Current: 5 Amperes

ORDERING INFORMATION: Model 4543-*

* = Mounting Base Color, Standard Colors: -0 Black, -2 Red

All dimensions are in inches. Tolerances (except noted): .xx = ±.02" (.51 mm), .xxx = ±.005" (.127 mm).

All specifications are to the latest revisions. Specifications are subject to change without notice.

Registered trademarks are the property of their respective companies.

Made in USA