



Chipsmall Limited consists of a professional team with an average of over 10 year of expertise in the distribution of electronic components. Based in Hongkong, we have already established firm and mutual-benefit business relationships with customers from,Europe,America and south Asia,supplying obsolete and hard-to-find components to meet their specific needs.

With the principle of “Quality Parts,Customers Priority,Honest Operation,and Considerate Service”,our business mainly focus on the distribution of electronic components. Line cards we deal with include Microchip,ALPS,ROHM,Xilinx,Pulse,ON,Everlight and Freescale. Main products comprise IC,Modules,Potentiometer,IC Socket,Relay,Connector.Our parts cover such applications as commercial,industrial, and automotives areas.

We are looking forward to setting up business relationship with you and hope to provide you with the best service and solution. Let us make a better world for our industry!



## Contact us

Tel: +86-755-8981 8866 Fax: +86-755-8427 6832

Email & Skype: info@chipsmall.com Web: www.chipsmall.com

Address: A1208, Overseas Decoration Building, #122 Zhenhua RD., Futian, Shenzhen, China



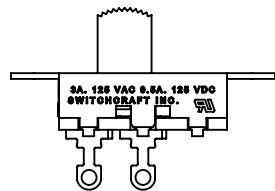

**46202LRX**

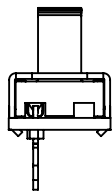

SCHEMATIC  
SINGLE POLE SINGLE THROW

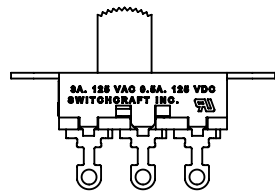

**46203LRX**

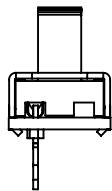

SCHEMATIC  
SINGLE POLE DOUBLE THROW

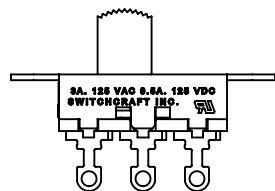

**46203LSRX**

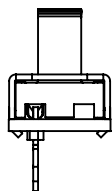

SCHEMATIC  
SINGLE POLE DOUBLE THROW  
SHORTING CONTACT

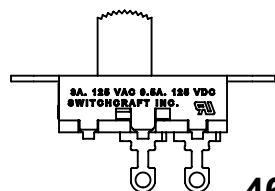

**46204LRX**

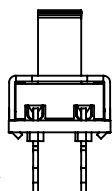

SCHEMATIC  
DOUBLE POLE SINGLE THROW

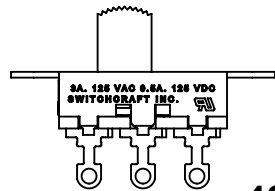

**46206LRX**

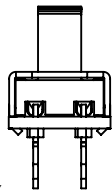

SCHEMATIC  
DOUBLE POLE DOUBLE THROW

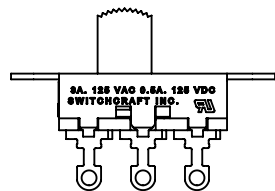

**46206LSRX**

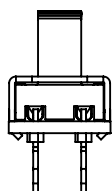

SCHEMATIC  
DOUBLE POLE DOUBLE THROW  
SHORTING CONTACTS

Ø0.140 MTG HOLE  
(2) PLACES

0.19 THROW

Ø0.078 HOLE  
(6) PLACES

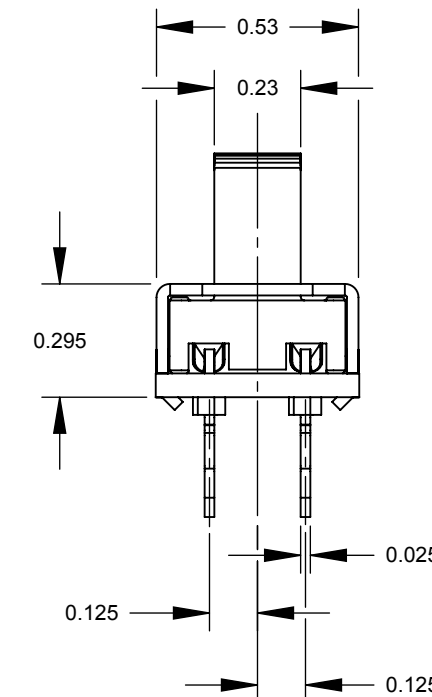
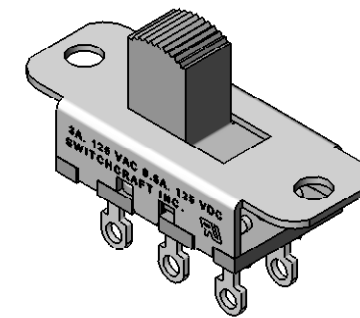
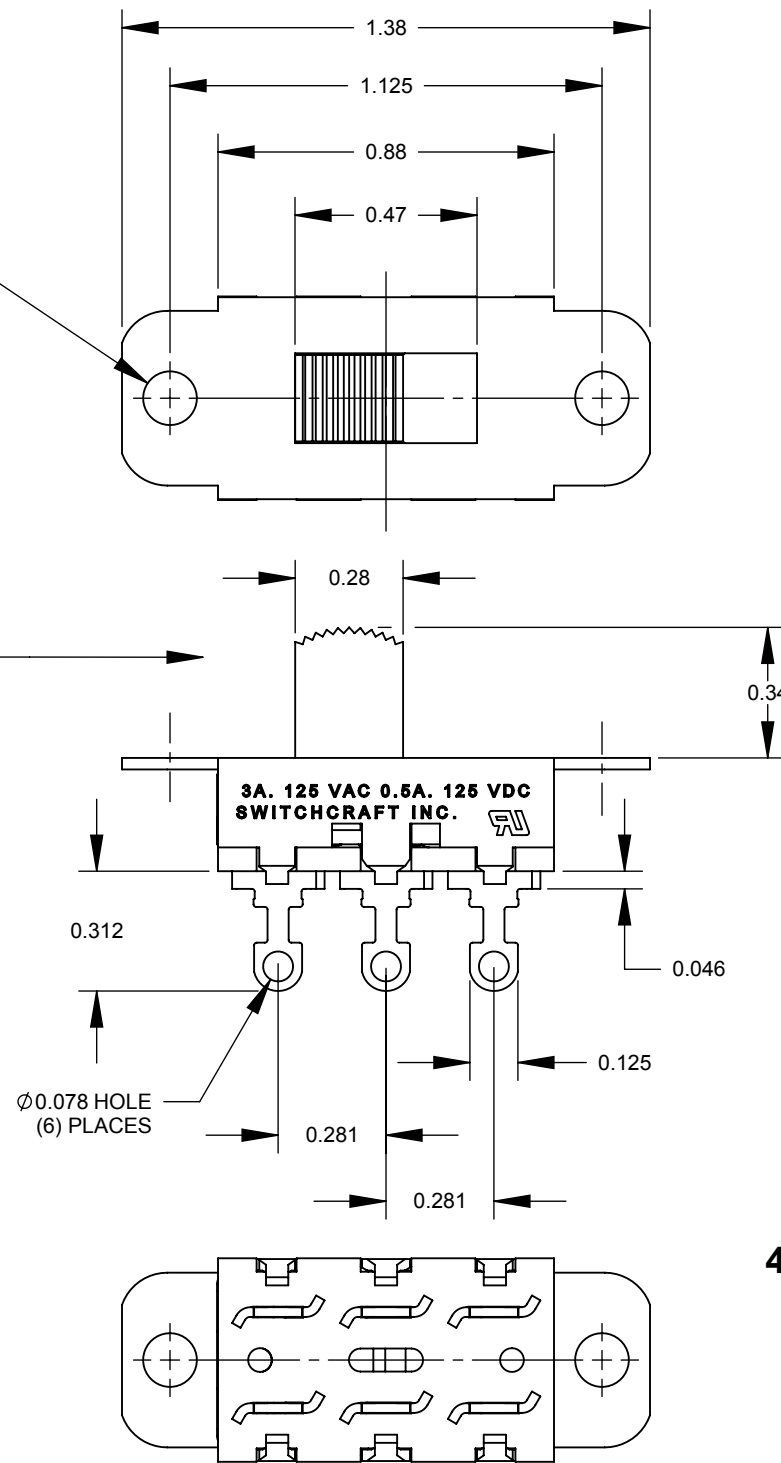

**46206LRX SHOWN**

**CUSTOMER DRAWING**

**NOTES:**

1. ALL DIMENSIONS REFERENCE UNLESS OTHERWISE SPECIFIED.
2. MATERIALS:  
HOUSING - STEEL, ZINC PLATED  
BUTTON - THERMOPLASTIC, BLACK  
TERMINALS & CONTACT SLIDER - BRASS, SILVER PLATED  
TERMINAL BOARD - PHENOLIC
3. SWITCH RATING:  
3 AMP, 125 V.A.C., 0.5 AMP, 125 V.D.C.
4. THIS PRODUCT IS RoHS COMPLIANT.

REV	ECO NUMBER	DATE	BY	APVD
A	26008	8/5/06	RS	TJK
REVISIONS				

UNLESS OTHERWISE SPECIFIED

1. ALL DIMENSIONS IN INCHES
- TWO PLACE DECIMALS ±0.02
- THREE PLACE DECIMALS ±0.005

DO NOT SCALE DRAWING

THIS DRAWING DESCRIBES A DESIGN CONSIDERED PROPRIETARY IN NATURE, DEVELOPED AND MANUFACTURED BY SWITCHCRAFT INC. AND IS RELEASED ON A CONFIDENTIAL BASIS FOR IDENTIFICATION PURPOSES ONLY.

SIZE	WIDTH	MULT	LBS/M	TEMPER
FINISH			MATERIAL	
SPEC No.			SPEC No.	
FIRST USED ON		SCALE		
		2:1		
DATE DRAWN	BY	CHKD	APVD	
2/19/09	RS	RS	TJK	
		2/19/09	2/19/09	
NAME			PART No.	REV
46200LR SERIES			46200LRX SERIES	A
SLIDE SWITCH, RoHS			SHEET 1 OF 1	

**SolidWorks CAD File**