



Chipsmall Limited consists of a professional team with an average of over 10 year of expertise in the distribution of electronic components. Based in Hongkong, we have already established firm and mutual-benefit business relationships with customers from,Europe,America and south Asia,supplying obsolete and hard-to-find components to meet their specific needs.

With the principle of “Quality Parts,Customers Priority,Honest Operation,and Considerate Service”,our business mainly focus on the distribution of electronic components. Line cards we deal with include Microchip,ALPS,ROHM,Xilinx,Pulse,ON,Everlight and Freescale. Main products comprise IC,Modules,Potentiometer,IC Socket,Relay,Connector.Our parts cover such applications as commercial,industrial, and automotives areas.

We are looking forward to setting up business relationship with you and hope to provide you with the best service and solution. Let us make a better world for our industry!



Contact us

Tel: +86-755-8981 8866 Fax: +86-755-8427 6832

Email & Skype: info@chipsmall.com Web: www.chipsmall.com

Address: A1208, Overseas Decoration Building, #122 Zhenhua RD., Futian, Shenzhen, China



PART NUMBER	REV	FIRST USED
466735-1	F	565435-5
466735-3	F	354500-1

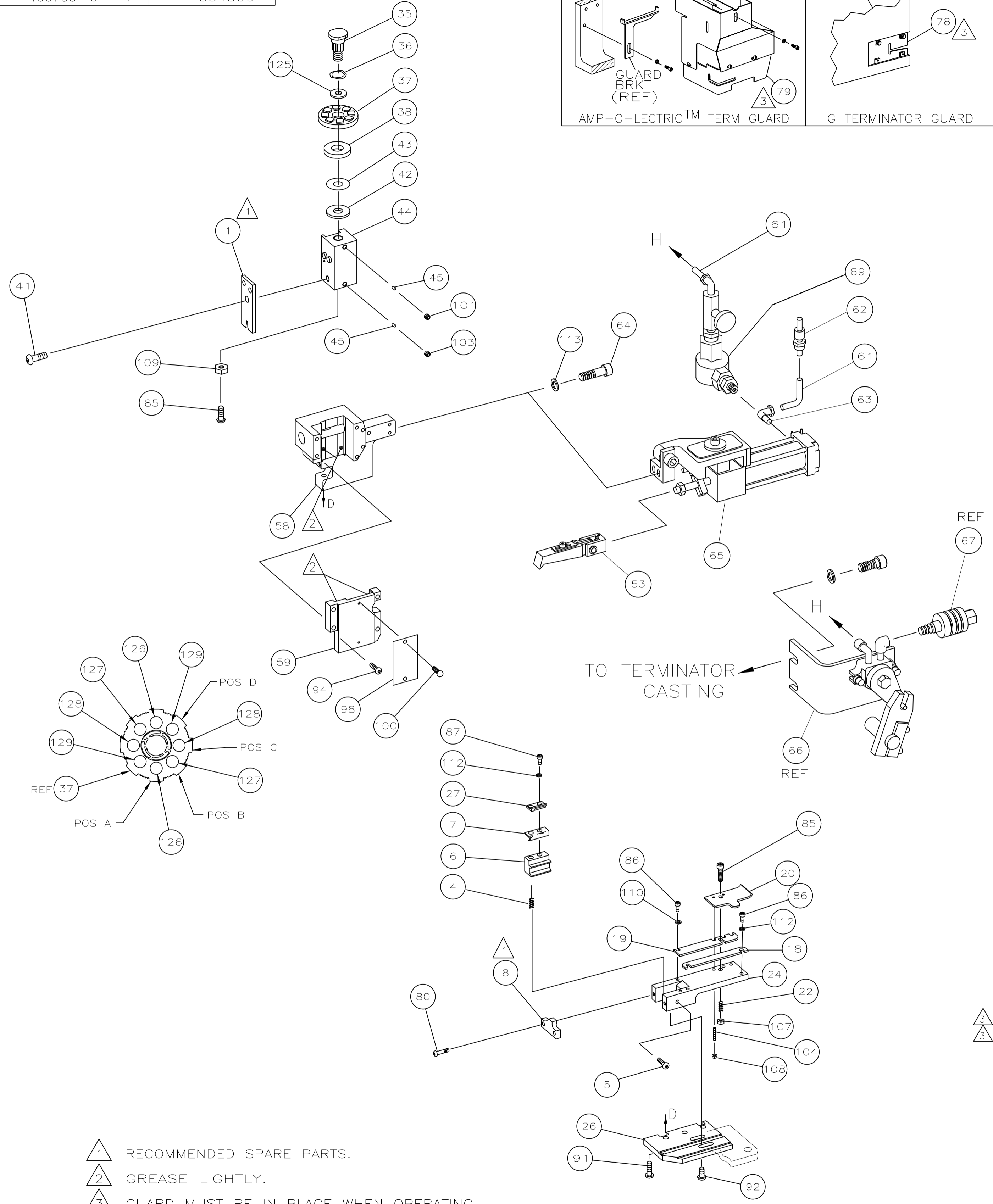
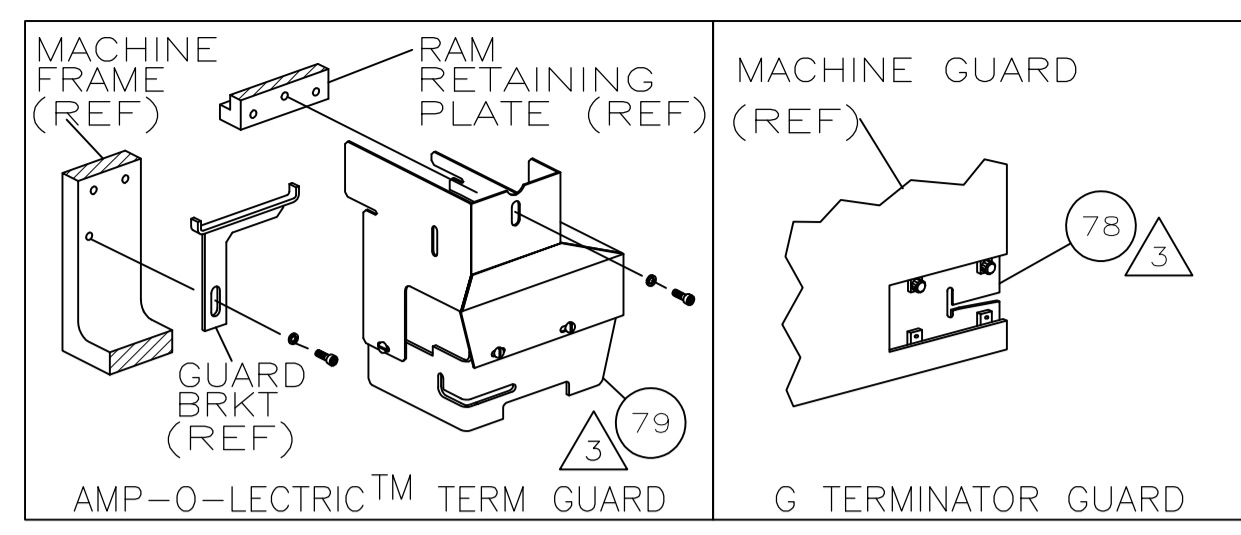

TERMINAL NAME: THRU SPLICE		CRIMPING DATA	
PAD LTR	CRIMP HEIGHT	WIRE SIZE	
A	.101 ±.002 [2.56 ±0.05mm]	8500-10000 CMA	
B	.096 ±.002 [2.44 ±0.05mm]	7000-8500 CMA	
C	.091 ±.002 [2.31 ±0.05mm]	5500-7000 CMA	
D	.085 ±.002 [2.16 ±0.05mm]	4000-5500 CMA	
CRIMP	SIZE	TYPE	RANGE
WIRE	.180 [4.57mm]	F	4000-10000 CMA
INSUL	-	-	-

QTY REQD PER ASSY	TERM APPL SPEC	FEED	APPL INSTRUCTION	SET UP GAGE	LAYOUT	
.295-.335	114-2088	.300	408-8039	-	948	
2	2	-	C 1-354779-8	PIN, WIRE DISC (.3080)D	129	
2	2	-	C 354779-8	PIN, WIRE DISC (.3030)C	128	
2	2	-	C 9-354778-5	PIN, WIRE DISC (.2970)B	127	
2	2	-	C 8-354778-5	PIN, WIRE DISC (.2920)A	126	
1	1	-	A 986950-1	WASHER, FLAT PRECISION	125	
					124	
					123	
					122	
					121	
					120	
					119	
					118	
					117	
					116	
					115	
					114	
2	2	-	A 21024-5	WASHER, LOCK(NO 10)AIR FD ASSY	113	
5	5	-	A 21024-3	WASHER, LOCK(NO 6)STR & SHR	112	
					111	
					110	
1	1	-	A 21019-1	NUT, HEX MACH(1/4-20) RAM	109	
2	2	-	A 21018-6	NUT, HEX (8-32) DRAG ADJ SCR	108	
1	1	-	A 21022-4	NUT, HEX SL(1/4-20) DRAG STUD	107	
					106	
					105	
2	2	-	A 5-21061-5	SCR, SKT SET CP (8-32x.88) DRAG	104	
1	1	-	A 5-21008-4	SCR, SKT SET(10-32x.50) RAM	103	
					102	
1	1	-	A 21009-2	SCR, SKT SET(1/4-20x.25)RAM	101	
2	2	-	A 21017-2	SCR, DRIVE(#2x.19)ID PLATE	100	
					99	
					98	
1	1	-	B 464249-1	PLATE, IDENTIFICATION	98	
					97	
					96	
					95	
4	4	-	A 2-21002-9	SCR, BHC(10-32x.75)CAP	94	
1	1	-	A 22733-8	SCR, BHC(8-32x.38 LW)ANVIL	93	
2	2	-	A 3-21002-3	SCR, BHC(1/4-20x.50)ST GD PL	92	
3	3	-	A 2-22733-9	SCR, BHC(1/4-20x.75)HSG	91	
					90	
					89	
					88	
2	2	-	A 2-21000-0	SCR, SHC(6-32x.50)STRIP & SHEAR	87	
4	4	-	A 1-21002-9	SCR, SHC(6-32x.625) ST GUIDES	86	
2	2	-	A 21001-8	SCR, SHC(1/4-20x1.50) DRAG & RAM	85	
					84	
					83	
					82	
					81	
2	2	-	A 2-21002-3	SCR, BHC(8-32x.63)ANVIL	80	
-	1	-	A 460980-1	GUARD ASSY	79	
REF	-	-	A 679532-1	INSERT, GUARD	78	
					77	
					76	
					75	
					74	
					73	
					72	
					71	
-3	-1	U/M	DWG SIZE	PART NO	DESCRIPTION	ITEM NO

QTY REQD PER ASSY	TERM APPL SPEC	FEED	APPL INSTRUCTION	SET UP GAGE	LAYOUT	
1	1	-	C 458407-9	ANVIL	8	
1	1	-	B 458410-1	SHEAR	7	
1	1	-	B 458409-1	HOLDER, SHEAR	6	
1	1	-	A 690461-4	SCREW, SHEAR STOP	5	
1	1	-	A 6-22282-8	SPRING, SHEAR RETURN	4	
					3	
					2	
1	1	-	C 456412-4	CRIMPER, WIRE	1	
-3	-1	U/M	DWG SIZE	PART NO	DESCRIPTION	ITEM NO

THIS DRAWING IS A CONTROLLED DOCUMENT.

THIS DRAWING IS UNPUBLISHED. RELEASE FOR PUBLICATION BY AMP INCORPORATED. ALL RIGHTS RESERVED. COPYRIGHT 1999

- 1 RECOMMENDED SPARE PARTS.
- 2 GREASE LIGHTLY.
- 3 GUARD MUST BE IN PLACE WHEN OPERATING APPLICATOR IN A BENCH MACHINE.
- 4 SEE DRAWING FOR COMPONENTS

A
66

REV	DESCRIPTION	DATE
F	ECR-14-005184	JT 4-14
E1	ECN 0150-0331-03	TE 3-03
E	0150-7443-96	TB 12-96
D	0150-6144-95	CE 5/95
C	EC 0150-5948-95	CE -3-95

DIMENSIONS IN INCHES. DO NOT SCALE PRINT. TOLERANCES UNLESS OTHERWISE SPECIFIED:
 2 PLC DEC ±.25
 3 PLC DEC ±.
 4 PLC DEC ±.
 ANGLES ±.
 SURF TEXTURE: ✓
 REMOVE BURRS, BREAK SHARP EDGES R.015 MAX

MATL - HT TR - FIN -

DR J.BAKER 3/7/95 APP 3/16/95 A BEDDICK
 CHK 3/16/95 REL 3/28/95 B. MORGAN
 C.ERISMAN

NAME END FEED HDM APPLICATOR MACHINE REF MINI APPL
 SCALE - DWG NO 466735 SHEET 1 OF 1 REV F

CAGE CODE 00779 CUSTOMER AND ASSEMBLY DRAWING RESTRICTED TO

466735

D

C

B

A