



Chipsmall Limited consists of a professional team with an average of over 10 year of expertise in the distribution of electronic components. Based in Hongkong, we have already established firm and mutual-benefit business relationships with customers from,Europe,America and south Asia,supplying obsolete and hard-to-find components to meet their specific needs.

With the principle of “Quality Parts,Customers Priority,Honest Operation,and Considerate Service”,our business mainly focus on the distribution of electronic components. Line cards we deal with include Microchip,ALPS,ROHM,Xilinx,Pulse,ON,Everlight and Freescale. Main products comprise IC,Modules,Potentiometer,IC Socket,Relay,Connector.Our parts cover such applications as commercial,industrial, and automotives areas.

We are looking forward to setting up business relationship with you and hope to provide you with the best service and solution. Let us make a better world for our industry!



Contact us

Tel: +86-755-8981 8866 Fax: +86-755-8427 6832

Email & Skype: info@chipsmall.com Web: www.chipsmall.com

Address: A1208, Overseas Decoration Building, #122 Zhenhua RD., Futian, Shenzhen, China



DO NOT SCALE DRAWING

| | | | |
|-------------|--------------|---------|---------|
| CADFILE NO. | SIMILAR ITEM | EDP NO. | ENG. NO |
|-------------|--------------|---------|---------|

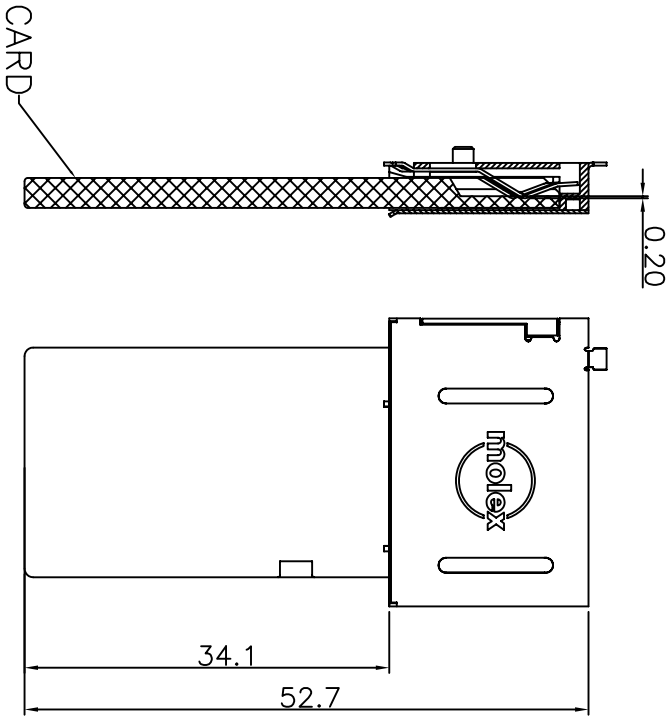

LENGTH OF INSERT CARD

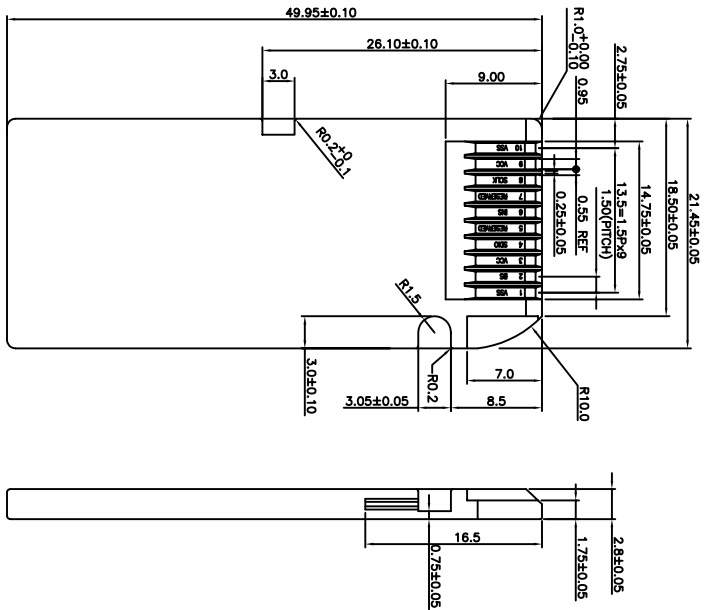

RECOMMENDED CARD LAYOUT

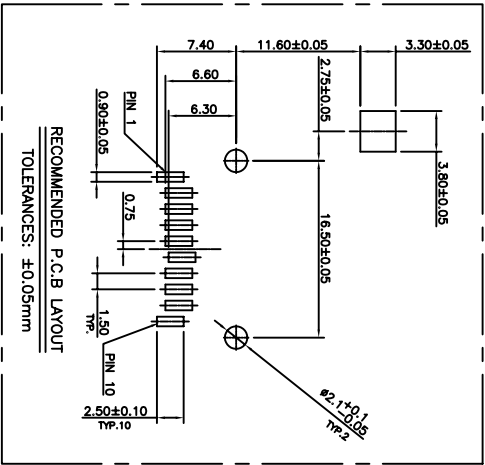

RECOMMENDED P.C.B. LAYOUT
TOLERANCES: ±0.05mm

| | | | | | | | | | | |
|--|---|--|---------------------------------|---------------------------------------|---------|--|---|-----------------|---------|---------|
| REV | DESCRIPTION | | QUALITY SYMBOLS | GENERAL TOLERANCES (UNLESS SPECIFIED) | SCALE | DESIGN UNITS | THIRD ANGLE PROJECTION | DIMENSIONS: | SHT | REV |
| | TOOLING RELEASE EC NO. T2004-0115 DRWN: LISHER CHK: K APPR: | | | | | | | | | |
| A | A | | MAJOR = 0 CRITICAL C=0 | MM INCH | MM INCH | <input checked="" type="checkbox"/> MM <input type="checkbox"/> INCH | <input checked="" type="checkbox"/> THIRD ANGLE <input type="checkbox"/> PROJECTION | MM INCH MM INCH | MM INCH | MM INCH |
| DRAFT WHERE APPLICABLE MUST REMAIN WITHIN DIMENSIONS APPROVED BY & DATE: Wilson Chong CHECKED BY & DATE: Sam Shin DRAWN BY & DATE: HU YAN MING 01/20/04 CAD FILENAME: S4809401S2.pdf MATERIAL NO.: 48094-0001 DRAWING NO.: SD-48094-001 SHEET NO.: 2 OF 2 SIZE: A3 THIS DRAWING CONTAINS INFORMATION THAT IS PROPRIETARY TO MOLEX INCORPORATED AND SHOULD NOT BE USED WITHOUT WRITTEN PERMISSION. | | | | | | | | | | |

A C D E F

8 7 6 5 4 3 2 1