



Chipsmall Limited consists of a professional team with an average of over 10 year of expertise in the distribution of electronic components. Based in Hongkong, we have already established firm and mutual-benefit business relationships with customers from,Europe,America and south Asia,supplying obsolete and hard-to-find components to meet their specific needs.

With the principle of “Quality Parts,Customers Priority,Honest Operation,and Considerate Service”,our business mainly focus on the distribution of electronic components. Line cards we deal with include Microchip,ALPS,ROHM,Xilinx,Pulse,ON,Everlight and Freescale. Main products comprise IC,Modules,Potentiometer,IC Socket,Relay,Connector.Our parts cover such applications as commercial,industrial, and automotives areas.

We are looking forward to setting up business relationship with you and hope to provide you with the best service and solution. Let us make a better world for our industry!



## Contact us

Tel: +86-755-8981 8866 Fax: +86-755-8427 6832

Email & Skype: info@chipsmall.com Web: www.chipsmall.com

Address: A1208, Overseas Decoration Building, #122 Zhenhua RD., Futian, Shenzhen, China



THIS DRAWING IS UNPUBLISHED. RELEASED FOR PUBLICATION  
 © COPYRIGHT - By - ALL RIGHTS RESERVED.

LOC	DIST	REVISIONS					
FT	0	P	LTR	DESCRIPTION	DATE	DWN	APVD
			C2	REVISED PER ECO-11-004917	11MAR11	RK	HMR

**MATERIALS:**  
 HOUSING: POLYAMIDE, UL94V-0.  
 TERMINALS: COPPER ALLOY, TIN PLATED.  
 SCREWS: STEEL, ZINC PLATED.

**ELECTRICAL:**  
 RATING: 20A, 150V(300V LIMITED RATING)  
 UL & CSA.

**MECHANICAL:**  
 WIRE RANGE: 12-22 AWG.  
 MAXIMUM TIGHTENING TORQUE: 7 IN-LB.

1 ALL SCREWS TO BE BOTTOMED

2 OBSOLETE PARTS: OBSOLETE CIS STREAMLINING PER D.RENAUD/D.SINISI

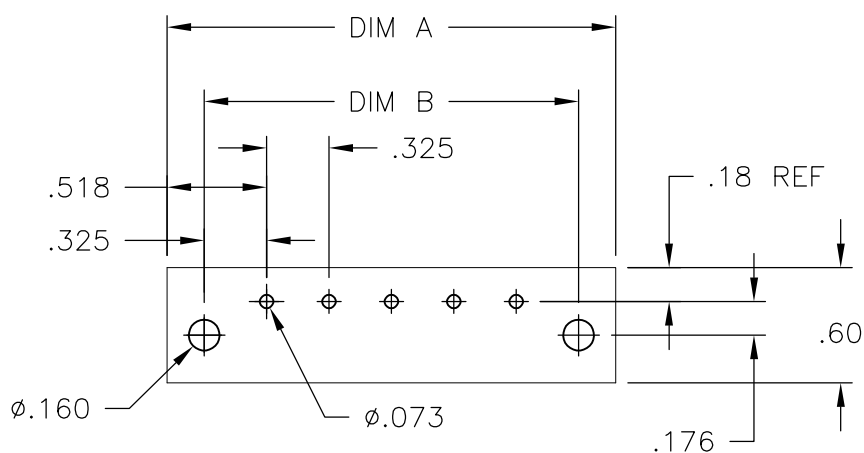
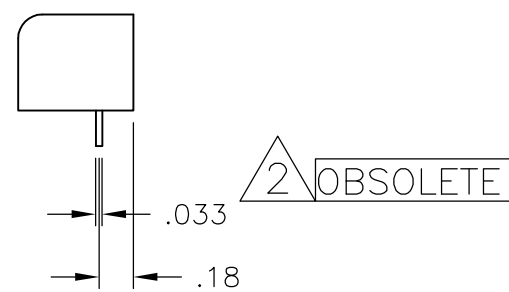
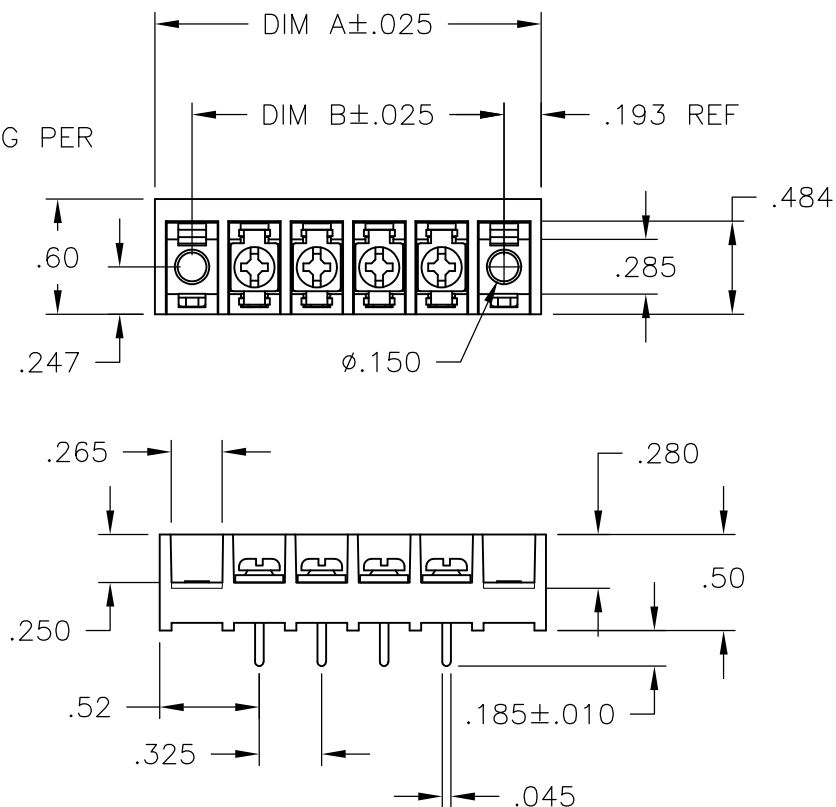

RECOMMENDED PCB LAYOUT

DIM A	DIM B	NO. OF POS.	CATALOG NUMBER	PART NO.
9.811	9.425	28	4PCV-28-008	1-1546939-6
9.486	9.100	27	4PCV-27-008	1-1546939-5
9.161	8.775	26	4PCV-26-008	1-1546939-4
8.836	8.450	25	4PCV-25-008	1-1546939-3
8.511	8.125	24	4PCV-24-008	1-1546939-2
8.186	7.800	23	4PCV-23-008	1-1546939-1
7.861	7.475	22	4PCV-22-008	1-1546939-0
7.536	7.150	21	4PCV-21-008	1546939-9
7.211	6.825	20	4PCV-20-008	1546939-8
6.886	6.500	19	4PCV-19-008	1546939-7
6.561	6.175	18	4PCV-18-008	1546939-6
6.236	5.850	17	4PCV-17-008	1546939-5
5.911	5.525	16	4PCV-16-008	1546939-4
5.586	5.200	15	4PCV-15-008	1546158-7
5.261	4.875	14	4PCV-14-008	1546939-3
4.936	4.550	13	4PCV-13-008	1546939-2
4.611	4.225	12	4PCV-12-008	1546939-1
4.286	3.900	11	4PCV-11-008	1546158-3
3.961	3.575	10	4PCV-10-008	1546158-2
3.636	3.250	9	4PCV-09-008	1546158-1
3.311	2.925	8	4PCV-08-235	9-1546119-9
3.311	2.925	8	4PCV-08-008	9-1437648-3
2.986	2.600	7	4PCV-07-008	9-1546119-8
2.661	2.275	6	4PCV-06-008	8-1437648-1
2.336	1.950	5	4PCV-05-008	7-1437648-5
2.011	1.625	4	4PCV-04-008	6-1437648-8
1.686	1.300	3	4PCV-03-008	6-1437648-2
1.361	.975	2	4PCV-02-008	9-1546119-3

THIS DRAWING IS A CONTROLLED DOCUMENT.		DWN S SCHLEGEL 6/20/06	TE Connectivity			
DIMENSIONS: INCHES		CHK S. YODER 6/20/06				
TOLERANCES UNLESS OTHERWISE SPECIFIED:		APVD S. YODER 6/20/06	NAME			
0 PLC ± - 1 PLC ± - 2 PLC ± .01 3 PLC ± .005 4 PLC ± - ANGLES ± 1°		PRODUCT SPEC	4PCV-XX-008 ASSEMBLY			
MATERIAL		APPLICATION SPEC	SIZE	CAGE CODE	DRAWING NO	RESTRICTED TO
FINISH		WEIGHT	A3	00779	C-6-1437648-2	-
CUSTOMER DRAWING			SCALE	SHEET	REV	
			NTS	1 OF 1	C2	