



Chipsmall Limited consists of a professional team with an average of over 10 year of expertise in the distribution of electronic components. Based in Hongkong, we have already established firm and mutual-benefit business relationships with customers from,Europe,America and south Asia,supplying obsolete and hard-to-find components to meet their specific needs.

With the principle of “Quality Parts,Customers Priority,Honest Operation,and Considerate Service”,our business mainly focus on the distribution of electronic components. Line cards we deal with include Microchip,ALPS,ROHM,Xilinx,Pulse,ON,Everlight and Freescale. Main products comprise IC,Modules,Potentiometer,IC Socket,Relay,Connector.Our parts cover such applications as commercial,industrial, and automotives areas.

We are looking forward to setting up business relationship with you and hope to provide you with the best service and solution. Let us make a better world for our industry!



Contact us

Tel: +86-755-8981 8866 Fax: +86-755-8427 6832

Email & Skype: info@chipsmall.com Web: www.chipsmall.com

Address: A1208, Overseas Decoration Building, #122 Zhenhua RD., Futian, Shenzhen, China



THIS DRAWING IS UNPUBLISHED.

RELEASED FOR PUBLICATION

20

© COPYRIGHT 20 BY -

ALL RIGHTS RESERVED.

REVISIONS

P	LTR	DESCRIPTION	DATE	DWN	APVD
	A	Initial release	18 JUL 2014	RG	RG

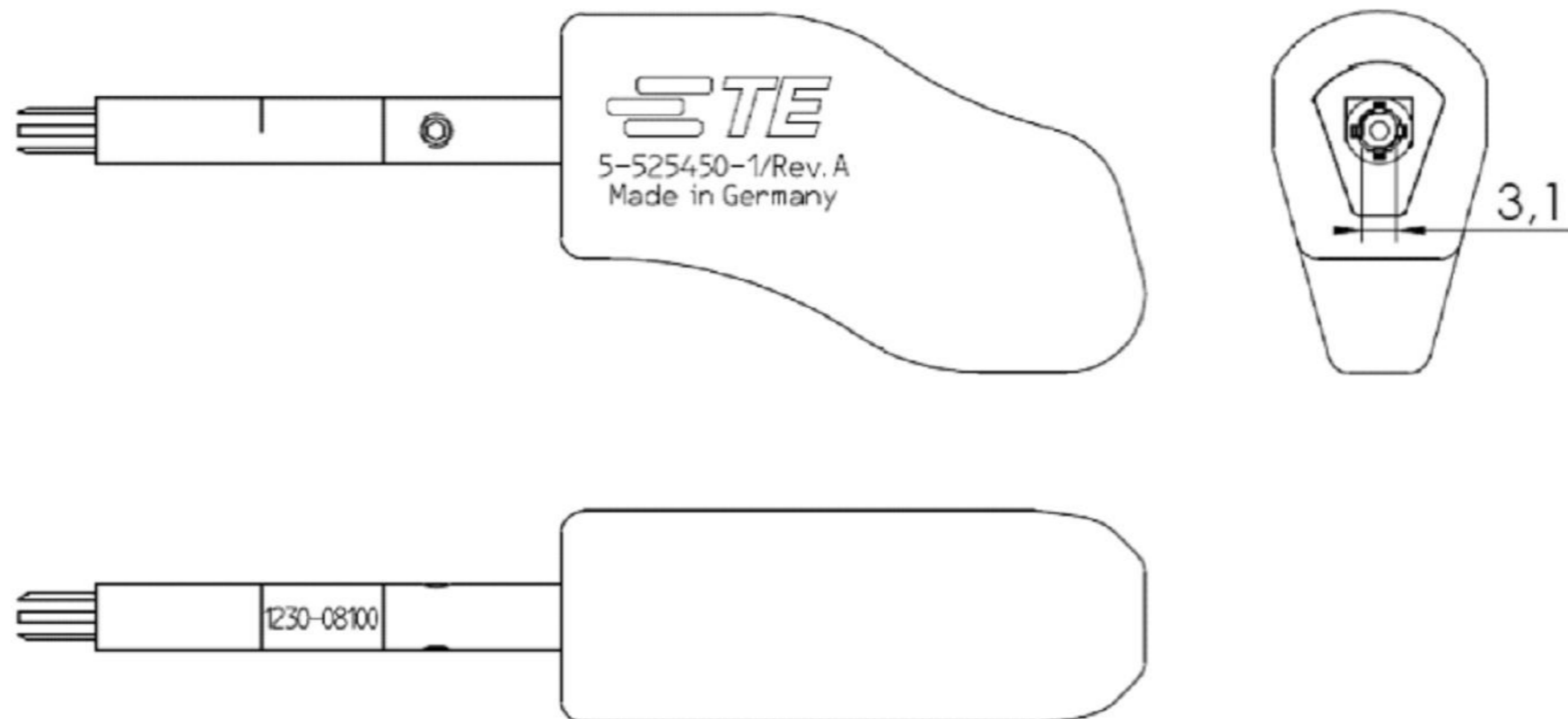

Application range / Anwendungsbereich

MKR/MKS 1.5mm Kontakt / MKR/MKS 1.5mm Contact

THIS DRAWING IS A CONTROLLED DOCUMENT.

DWN R. Germann 18 JUL 2014

CHK R. Germann 18 JUL 2014

APVD -

PRODUCT SPEC -

APPLICATION SPEC -

WEIGHT 25g

Customer Drawing

STE TE Connectivity

NAME
EXTRACTION TOOL
Entriegelungswerkzeug

SIZE A3 CAGE CODE - DRAWING NO. C-5-525450-1 RESTRICTED TO -

SCALE - SHEET 1 OF 1 REV A

DIMENSIONS:

mm

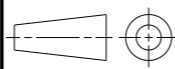

TOLERANCES UNLESS OTHERWISE SPECIFIED:

- 0 PLC ±
- 1 PLC ±
- 2 PLC ±
- 3 PLC ±
- 4 PLC ±
- ANGLES ±°

MATERIAL

-

FINISH

-