



Chipsmall Limited consists of a professional team with an average of over 10 year of expertise in the distribution of electronic components. Based in Hongkong, we have already established firm and mutual-benefit business relationships with customers from,Europe,America and south Asia,supplying obsolete and hard-to-find components to meet their specific needs.

With the principle of “Quality Parts,Customers Priority,Honest Operation,and Considerate Service”,our business mainly focus on the distribution of electronic components. Line cards we deal with include Microchip,ALPS,ROHM,Xilinx,Pulse,ON,Everlight and Freescale. Main products comprise IC,Modules,Potentiometer,IC Socket,Relay,Connector.Our parts cover such applications as commercial,industrial, and automotives areas.

We are looking forward to setting up business relationship with you and hope to provide you with the best service and solution. Let us make a better world for our industry!



Contact us

Tel: +86-755-8981 8866 Fax: +86-755-8427 6832

Email & Skype: info@chipsmall.com Web: www.chipsmall.com

Address: A1208, Overseas Decoration Building, #122 Zhenhua RD., Futian, Shenzhen, China



PRODUCT NUMBER

SEE NOTE 1

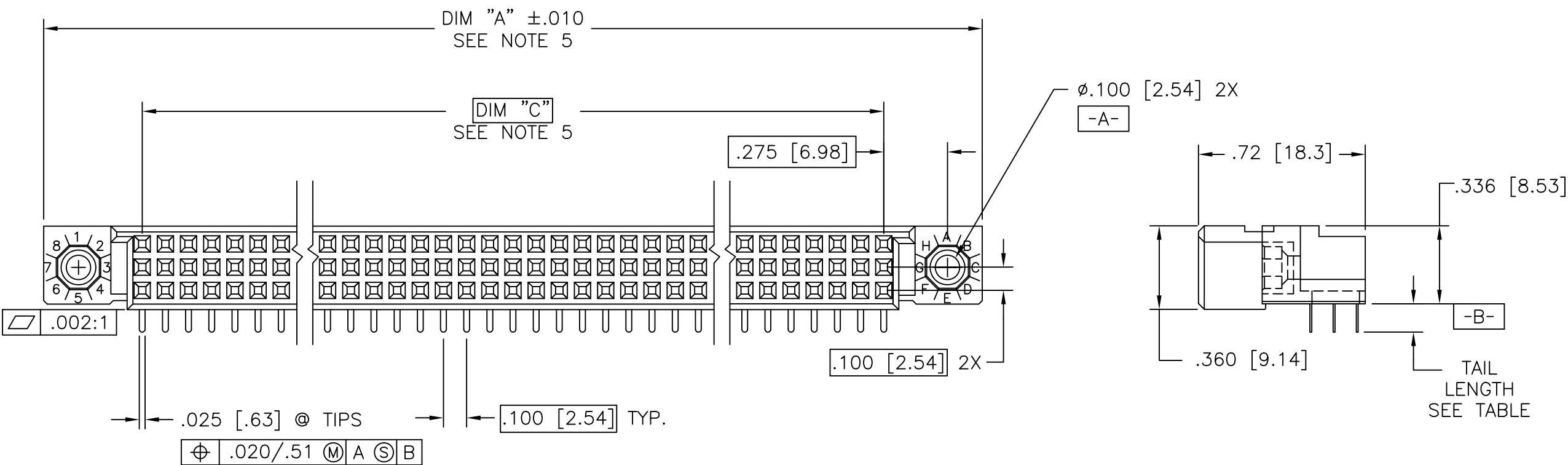
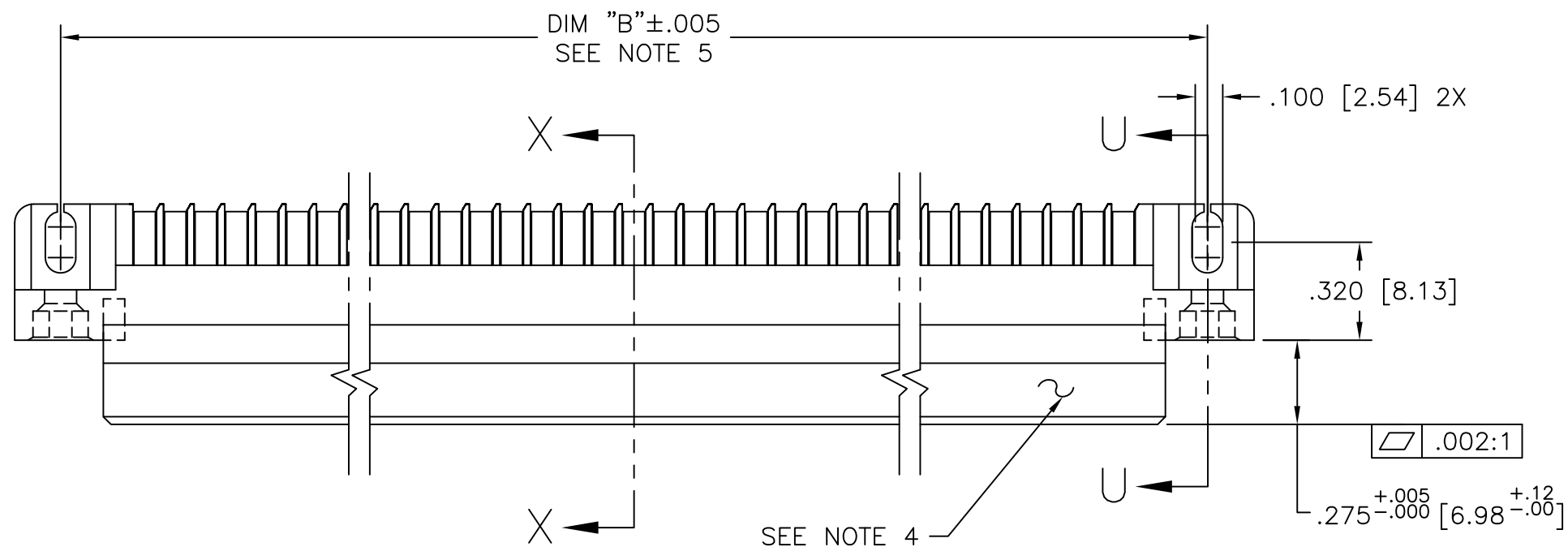

mat'l. code NOTE 3		surface ISO 1302 ✓		tolerance ISO 406 ISO 1101		projection INCH/MM		product family HPC	
ltr	ecn no	dr	date	tolerances unless otherwise specified		scale 1:1		title 3 ROW R/A RECEPTACLE SOLDER TAIL, 0 GUIDE PIN	
U	ELX-I-25169	MJA	10/19/16	angles	linear				
V	ELX-I-26924	MJA	05/06/17						
-	-	-	-	σ±2					
P	M06-0255	AEA	7/06/06	dr	D. SHEAFFER	1/04/90		dwg no 50000	
R	M07-0331	AGS	7/18/07	enr	S. CLARK	1/04/90		sheet 1 of 4 size A3	
S	M07-0183	MHT	7/02/08	chr	M JACOB	05/06/17		type Product Customer Drawing	
T	M08-0280	AGS	30/09/08	appd	BIJU K PAUL	05/06/17			
sheet	revision	V	U	U	T				
index	sheet	1	2	3	4				

PRODUCT NUMBER
SEE TABLE

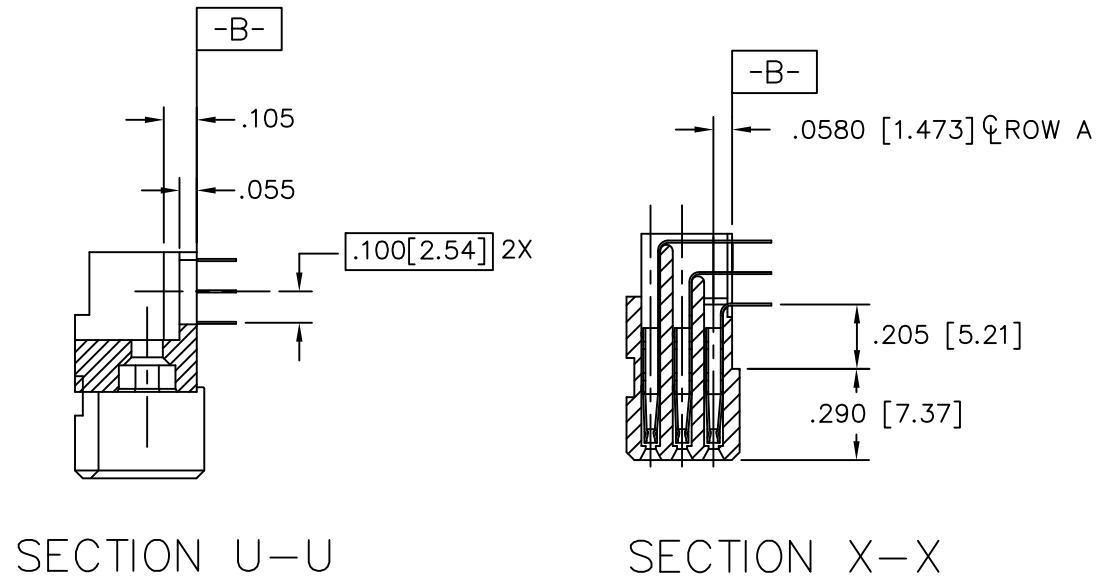

NOTES:
 ① PRODUCT NUMBERING CODE:
 50000 - X YYY Z LF
 LEAD FREE (OPTIONAL)
 TAIL LENGTH (SEE TABLE)
 NO. OF POSITIONS (SEE NOTE 2)
 PLATING (SEE TABLE)
 BASE NUMBER

PRODUCT NUMBERING CODE FOR
 SELECT LOAD PART NUMBERS:
 50000 - XXYYYY LF
 LEAD FREE (OPTIONAL)
 SEQUENCE NUMBER
 ALWAYS 'XX'
 BASE NUMBER

- ② THIS PRODUCT IS CONFIGURED IN SIZES OF 6 THRU 80 COLUMNS IN INCREMENTS OF ONE. i.e.: 6,7,8,9.....79,80.
- ③ HOUSING MATERIAL: GLASS AND MINERAL FILLED THERMOPLASTIC. FLAME RETARDANT PER UL94V-O. COLOR:BLACK CONTACT MATERIAL: BeCu
- ④ COMPANY NAME, PART NUMBER AND LOT CODE TO APPEAR ON THIS SURFACE PER BUS-12-108.
- ⑤ LENGTH FORMULAS:
 DIM A = $.100/2.54 \times \text{NO. OF COLUMNS} + .75/19.1$
 DIM B = $.100/2.54 \times \text{NO. OF COLUMNS} + .450/11.43$
 DIM C = $.100/2.54 \times \text{NO. OF COLUMNS} - .100/2.54$
- ⑥ PRODUCT WITH "LF" SUFFIX MEETS EUROPEAN UNION DIRECTIVES AND OTHER COUNTRY REGULATIONS AS DESCRIBED IN GS-22-008.
7. THIS HOUSING WILL WITHSTAND EXPOSURE TO 260° C PEAK TEMPERATURE FOR 10-30 SECONDS IN A CONVECTION, INFRA-RED OR VAPOR PHASE REFLOW OVEN.
- ⑧ PLATING OPTIONS:
 MAY BE EITHER GOLD OR GXT PLATED AT MANUFACTURE'S OPTION

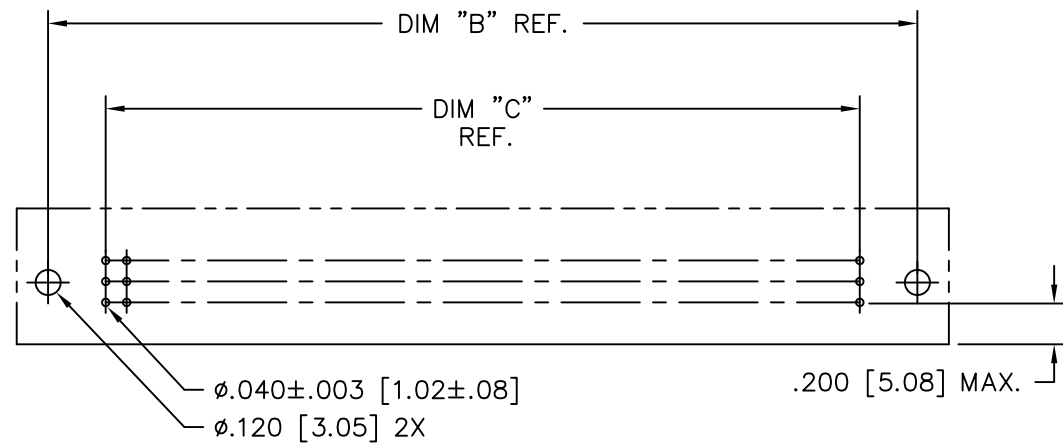

RECOMMENDED PCB LAYOUT
 (ALL HOLES LOCATED ON .100 [2.54] GRID UNLESS OTHERWISE SPECIFIED)

mat'l. code NOTE 3		surface ISO 1302 ✓	tolerance ISO 406 ISO 1101	projection 	product family HPC
ltr	ecn no	dr	date	tolerances unless otherwise specified	title 3 ROW R/A RECEPTACLE SOLDER TAIL, 0 GUIDE PIN
U				angles linear .XX ±.01/.X±0.3 .XXX ±.005/.XX±0.13 .XXXX ±.0020/.XXX±0.051	
				INCH/MM	dwg no 50000
				scale 1:1	
		dr	D. SHEAFFER	1/04/90	sheet 2 of 4 size A3
		enr	S. CLARK	1/04/90	type Product Customer Drawing
		chr	M JACOB	05/06/17	
		appd	BIJU K PAUL	05/06/17	
sheet index	revision sheet				

PRODUCT NUMBER NOTE 1	NUMBER OF POSITIONS NOTE 2	TAIL LENGTH	SOLDER TAIL PLATING	CONTACT PLATING (NOTE 8)
50000-1YYYYE	YYY	.125±.010/3.18±0.25	TIN-LEAD	30u"/0.76um Au
50000-1YYYYELF	YYY	.125±.010/3.18±0.25	TIN	30u"/0.76um Au
50000-1YYYYF	YYY	.145±.010/3.68±0.25	TIN-LEAD	30u"/0.76um Au
50000-1YYYYH	YYY	.180±.010/4.57±0.25	TIN-LEAD	30u"/0.76um Au
50000-1YYYYHLF	YYY	.180±.010/4.57±0.25	TIN	30u"/0.76um Au
50000-1YYYYZ	YYY	.220±.010/5.59±0.25	TIN-LEAD	30u"/0.76um Au
50000-3YYYYE	YYY	.125±.010/3.18±0.25	TIN-LEAD	50u"/1.27um Au
50000-3YYYYF	YYY	.145±.010/3.68±0.25	TIN-LEAD	50u"/1.27um Au
50000-3YYYYH	YYY	.180±.010/4.57±0.25	TIN-LEAD	50u"/1.27um Au
50000-3YYYYZ	YYY	.220±.010/5.59±0.25	TIN-LEAD	50u"/1.25um Au
50000-5YYYYE	YYY	.125±.010/3.18±0.25	TIN-LEAD	30u"/0.76um GXT
50000-5YYYYELF	YYY	.125±.010/3.18±0.25	TIN	30u"/0.76um GXT
50000-5YYYYF	YYY	.145±.010/3.68±0.25	TIN-LEAD	30u"/0.76um GXT
50000-5YYYYFLF	YYY	.145±.010/3.68±0.25	TIN	30u"/0.76um GXT
50000-5YYYYH	YYY	.180±.010/4.57±0.25	TIN-LEAD	30u"/0.76um GXT
50000-5YYYYHLF	YYY	.180±.010/4.57±0.25	TIN	30u"/0.76um GXT
50000-5YYYYZ	YYY	.220±.010/5.59±0.25	TIN-LEAD	30u"/0.76um GXT
50000-5YYYYZLF	YYY	.220±.010/5.59±0.25	TIN	30u"/0.76um GXT

Amphenol
FCi

Copyright AFci

mat'l. code NOTE 3		surface ISO 1302 ✓	tolerance ISO 406 ISO 1101	projection 	product family HPC
ltr	ecn no	dr	date	tolerances unless otherwise specified	title 3 ROW R/A RECEPTACLE SOLDER TAIL, 0 GUIDE PIN
U				linear .XX ±.01/XX±0.3 .XXX ±.005/XX±0.13 .XXXX ±.0020/XXX±0.051	
				angles σ±2°	
				dr D. SHEAFFER 1/04/90	scale 1:1
				enr S. CLARK 1/04/90	Amphenol FCi
				chr M JACOB 10/19/16	
				appd BIJU K PAUL 10/19/16	dwg no 50000
sheet index	revision sheet				sheet 3 of 4 size A3
					type Product Customer Drawing

PRODUCT NUMBER
SEE TABLE

50000-XX001 OR 50000-XX001LF ONLY

	55	50				45				40				36	
<u>C</u>	C	C	C	C	C	C	C	C	C	C	C	C	C	C	
<u>B</u>		B	B	B	B	B	B	B	B	B	B	B	B	B	
<u>A</u>	A	A	A	A	A	A	A	A	A	A	A	A	A	A	

35	30				25				20				15				10				5	1					
C	C	C	C	C	C	C	C	C	C	C	C	C	C	C	C	C	C	C	C	C	C	C	C	C	C	C	
A	A	A	A	A	A	A	A	A	A	A	A	A	A	A	A	A	A	A	A	A	A	A	A	A	A	A	A

NOTES FOR 50000-XX001 OR 50000-XX001LF ONLY:

1. ALL POSITIONS ARE LOADED AS SHOWN.
2. COLUMN 1, ROW A IS DESIGNATED AS SIGNAL TERM. 1, AS VIEWED FROM THE MATING FACE.
3. SIGNAL DATA FOR 50000-XX001 OR 50000-XX001LF
 SIZE 3 X 55
 TOTAL NUMBER OF POSITIONS: 165
 TOTAL NUMBER OF POSITIONS LOADED: 107

ITEM KEY	QTY.	TAIL LENGTH
A	45	.180±.010/4.57±.25
B	17	.180±.010/4.57±.25
C	45	.180±.010/4.57±.25

mat'l. code		surface		tolerance		projection		product family	
NOTE 3		ISO 1302 ✓		ISO 406 ISO 1101				HPC	
ltr	ecn no	dr	date	tolerances unless otherwise specified		INCH/MM		title	
T				angles	linear	scale 1:1		3 ROW R/A RECEPTACLE SOLDER TAIL, 0 GUIDE PIN	
				σ±2'	.XX ±.01/XX±.03 .XXX ±.005/XX±.013 .XXX ±.0020/XXX±.0051			dwg no	
				dr	D. SHEAFFER	1/04/90			sheet 4 of 4 size
				enr	S. CLARK	1/04/90			50000 A3
				chr	S. CLARK	1/04/90			
				appd	S. CLARK	1/04/90			type Product Customer Drawing
sheet index	revision sheet								