



Chipsmall Limited consists of a professional team with an average of over 10 year of expertise in the distribution of electronic components. Based in Hongkong, we have already established firm and mutual-benefit business relationships with customers from,Europe,America and south Asia,supplying obsolete and hard-to-find components to meet their specific needs.

With the principle of “Quality Parts,Customers Priority,Honest Operation,and Considerate Service”,our business mainly focus on the distribution of electronic components. Line cards we deal with include Microchip,ALPS,ROHM,Xilinx,Pulse,ON,Everlight and Freescale. Main products comprise IC,Modules,Potentiometer,IC Socket,Relay,Connector.Our parts cover such applications as commercial,industrial, and automotives areas.

We are looking forward to setting up business relationship with you and hope to provide you with the best service and solution. Let us make a better world for our industry!



## Contact us

Tel: +86-755-8981 8866 Fax: +86-755-8427 6832

Email & Skype: [info@chipsmall.com](mailto:info@chipsmall.com) Web: [www.chipsmall.com](http://www.chipsmall.com)

Address: A1208, Overseas Decoration Building, #122 Zhenhua RD., Futian, Shenzhen, China



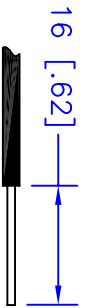

STRIP LENGTH: 16mm

NOTES:

1. ROHS COMPLIANT
2. -40°C TO 85°C OPERATING TEMPERATURE
3. SUITABLE FOR POF WITH Ø2.2mm BUFFER AND Ø1.0mm OPTICAL CORE
4. TIA 604.1 (FOCIS 1)
5. MAXIMUM TORQUE: 8in-lbs

INSTRUCTIONS:

1. STRIP A 16mm LENGTH OF JACKET OFF OF FIBER.
2. SLIP BOOT OVER CABLE.
3. APPLY EPOXY TO INSIDE OF SMA CONNECTOR AND BARE FIBER.
4. INSERT BARE FIBER INTO SMA CONNECTOR; ROTATE FIBER DURING INSERTION TO EVENLY DISTRIBUTE EPOXY.
5. CRIMP CONNECTOR TO CABLE ABOVE RETENTION RIDGES AND SLIP BOOT OVER CONNECTOR BODY TO FINISH INSTALLATION. ALLOW EPOXY TO CURE BEFORE POLISHING.



METRIC

REV		DESCRIPTION	REVISIONS			
ECO	DATE	DWN	APVD			
B	ADDED BOOT INFORMATION	0036	09/29/09	BB	KS	

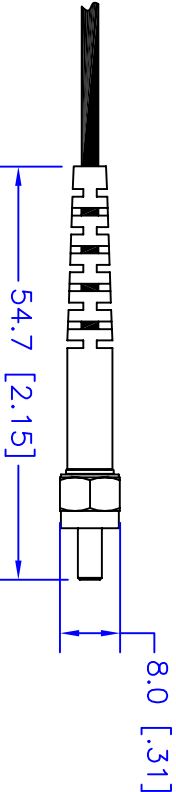
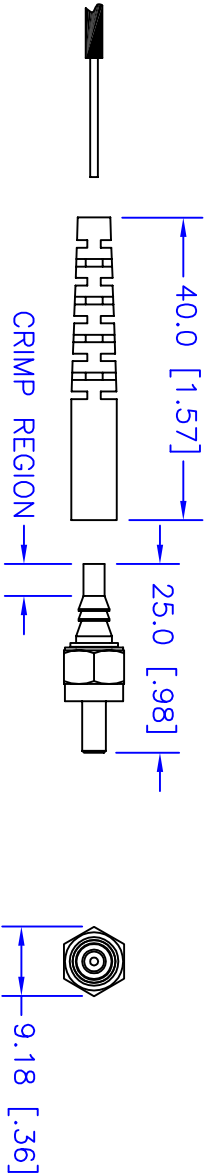
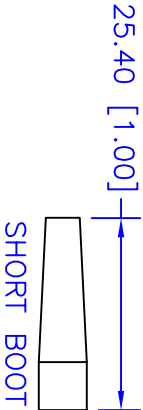

RECOMMENDED EPOXY:  
EPO-TEK 301

CRIMP TOOL: IF 370046  
USE 2.5 [0.10] HEX CRIMP

UNLESS OTHERWISE SPECIFIED	PRODUCT
DIMENSIONS	MATERIAL
MILLIMETERS [IN.]	303 STAINLESS

TOLERANCES	SURFACE
0 PLC: ±1	3.2
1 PLC: ±.25	TEXTURE: V
2 PLC: ±.127	
3 PLC: ±.025	
4 PLC: ±.013	
ANGLE: ±1/2°	

REMOVE BURRS AND SHARP EDGES	CHECKED BY
FLATNESS .005 MM PER MM	STOTZ
ALL DIMENSIONS AFTER FINISH	DATE
	09/29/09

NAME	INDUSTRIAL FIBER OPTICS
TEMP.	TEMPE, AZ 85281
SIZE	51 0053
SCALE	W/STANDARD BLACK BOOT
PART NUMBER	51 0054
REV	W/STANDARD RED BOOT
	51 0056
	W/STANDARD BLUE BOOT
	51 0057
	W/STANDARD YELLOW BOOT
	51 0058
	W/STANDARD WHITE BOOT
	51 0062
	W/SHORT BLACK BOOT

SMA WITH BOOT

DO NOT SCALE	DO NOT SCALE	SHEET	1	OF	1
A	1:1	51 0053	B		