



Chipsmall Limited consists of a professional team with an average of over 10 year of expertise in the distribution of electronic components. Based in Hongkong, we have already established firm and mutual-benefit business relationships with customers from,Europe,America and south Asia,supplying obsolete and hard-to-find components to meet their specific needs.

With the principle of “Quality Parts,Customers Priority,Honest Operation,and Considerate Service”,our business mainly focus on the distribution of electronic components. Line cards we deal with include Microchip,ALPS,ROHM,Xilinx,Pulse,ON,Everlight and Freescale. Main products comprise IC,Modules,Potentiometer,IC Socket,Relay,Connector.Our parts cover such applications as commercial,industrial, and automotives areas.

We are looking forward to setting up business relationship with you and hope to provide you with the best service and solution. Let us make a better world for our industry!



Contact us

Tel: +86-755-8981 8866 Fax: +86-755-8427 6832

Email & Skype: info@chipsmall.com Web: www.chipsmall.com

Address: A1208, Overseas Decoration Building, #122 Zhenhua RD., Futian, Shenzhen, China



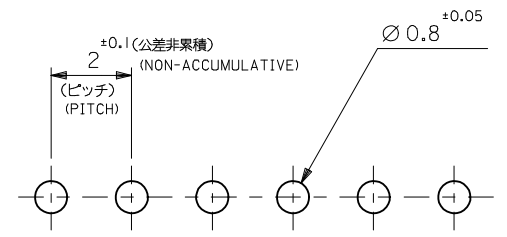
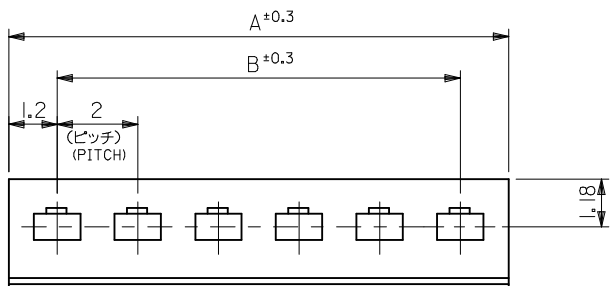
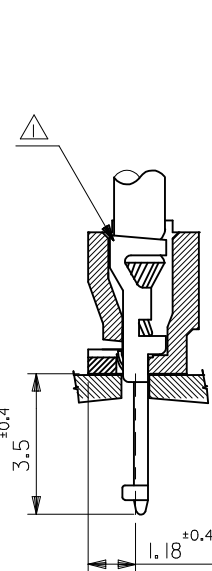
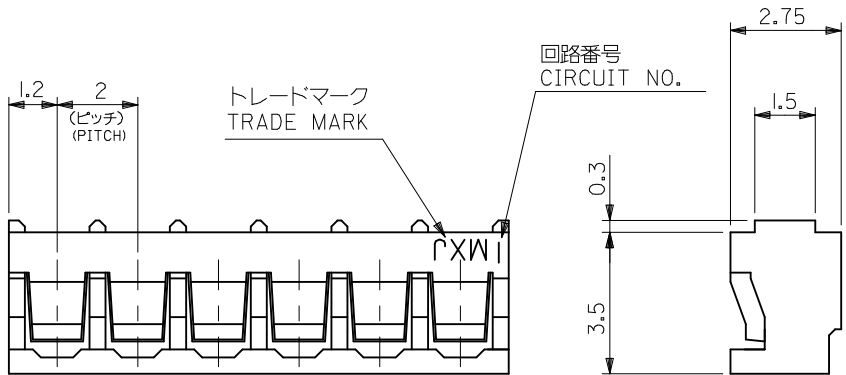
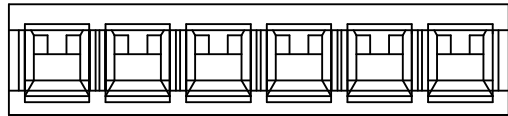

基板取付穴推奨寸法

(基板厚: t=1~1.6mm)
 RECOMMENDED PC BOARD
 HOLE DIMENSION
 (THICKNESS: t=1~1.6mm)

注記
 NOTE

- △ 適合ターミナル: 50034 8*00
 APPLICABLE TERMINAL: 50034 8*00
- 2. 材料 ハウジング: ポリアミド, UL94V-0
 色: ナチュラル(白)
 MATERIAL HOUSING: POLYAMIDE, UL94V-0
 COLOR: NATURAL(WHITE)
- 3. ELV 及び RoHS 適合品
 ELV AND RoHS COMPLIANT.

28	30.4	51015	1500	15
26	28.4	↑	1400	14
24	26.4		1300	13
22	24.4		1200	12
20	22.4		1100	11
18	20.4		1000	10
16	18.4		0900	9
14	16.4		0800	8
12	14.4		0700	7
10	12.4		0600	6
8	10.4		0500	5
6	8.4		0400	4
4	6.4		0300	3
2	4.4		0200	2
B	A	ORDER No.		極致 NO. OF CKT

REVISED EC NO: J2012-0968 DRWN: KWASHIO 2012/01/18 CHKD: KASAKAWA 2013/04/09 APPR: Y0110 2013/04/10	GENERAL TOLERANCES (UNLESS SPECIFIED)		DIMENSION STYLE MM ONLY		SCALE 8:1	DESIGN UNITS METRIC	THIRD ANGLE PROJECTION
	10 UNDER	±0.2	DRAWN BY HIJIMA	DATE 1996/05/28	TITLE 2.0 BOARD IN CONN HSG		
	10 OVER 30 UNDER	±0.25	CHECKED BY MFUKUSHIMA	DATE 1996/05/28	MATERIAL NO. SEE CHART		
	30 OVER	±0.3	APPROVED BY	DATE	DOCUMENT NO. SD-51015-**-00		
	ANGULAR ±3 °		DRAFT WHERE APPLICABLE MUST REMAIN WITHIN DIMENSIONS		SHEET NO. 1 OF 1		MATERIAL NO. SEE CHART