



Chipsmall Limited consists of a professional team with an average of over 10 year of expertise in the distribution of electronic components. Based in Hongkong, we have already established firm and mutual-benefit business relationships with customers from,Europe,America and south Asia,supplying obsolete and hard-to-find components to meet their specific needs.

With the principle of “Quality Parts,Customers Priority,Honest Operation,and Considerate Service”,our business mainly focus on the distribution of electronic components. Line cards we deal with include Microchip,ALPS,ROHM,Xilinx,Pulse,ON,Everlight and Freescale. Main products comprise IC,Modules,Potentiometer,IC Socket,Relay,Connector.Our parts cover such applications as commercial,industrial, and automotives areas.

We are looking forward to setting up business relationship with you and hope to provide you with the best service and solution. Let us make a better world for our industry!



## Contact us

Tel: +86-755-8981 8866 Fax: +86-755-8427 6832

Email & Skype: info@chipsmall.com Web: www.chipsmall.com

Address: A1208, Overseas Decoration Building, #122 Zhenhua RD., Futian, Shenzhen, China



LOC	DIST	REVISIONS			
GP	00	REV	DESCRIPTION	DATE	BY
E		1	REVISED PER ECO-12-021104	22JAN2013	CJV

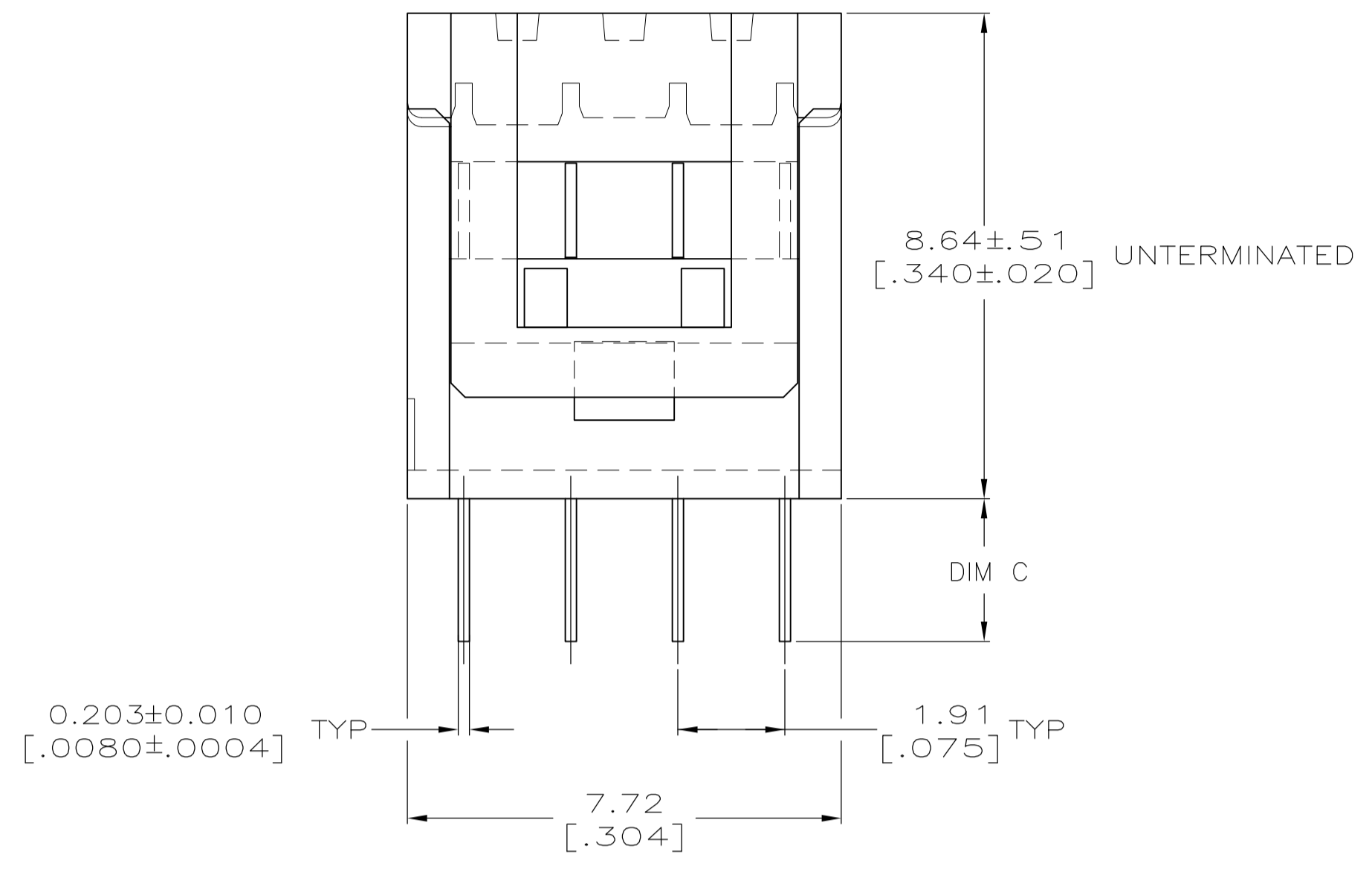
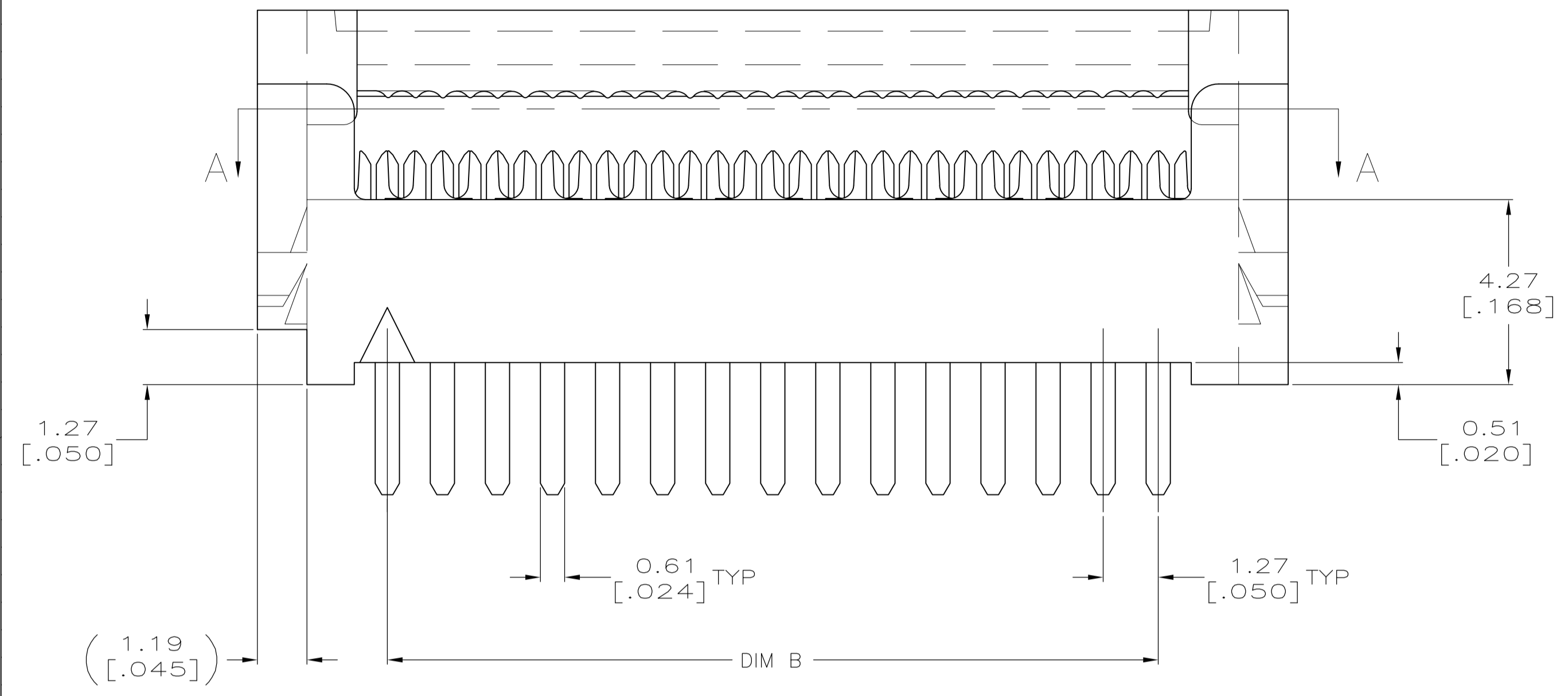

- △ HOUSING: UL RATED 94V-0 LCP THERMOPLASTIC, COLOR BLACK.  
COVER: UL RATED 94V-0 POLYESTER MOLDING COMPOUND, COLOR BLACK.
- △ CONTACTS: COPPER ALLOY.
- △ CONTACTS: 0.00254 [.000100] MIN MATTE TIN OVER 0.00127 [.000050] MIN NICKEL.
- △ POSITION 1 INDICATOR, OMITTED FOR PART NUMBER 2-5111595-1.
- △ VOID CORES MAY OR MAY NOT BE PRESENT BETWEEN ANY 2 ROWS OF CONTACTS.

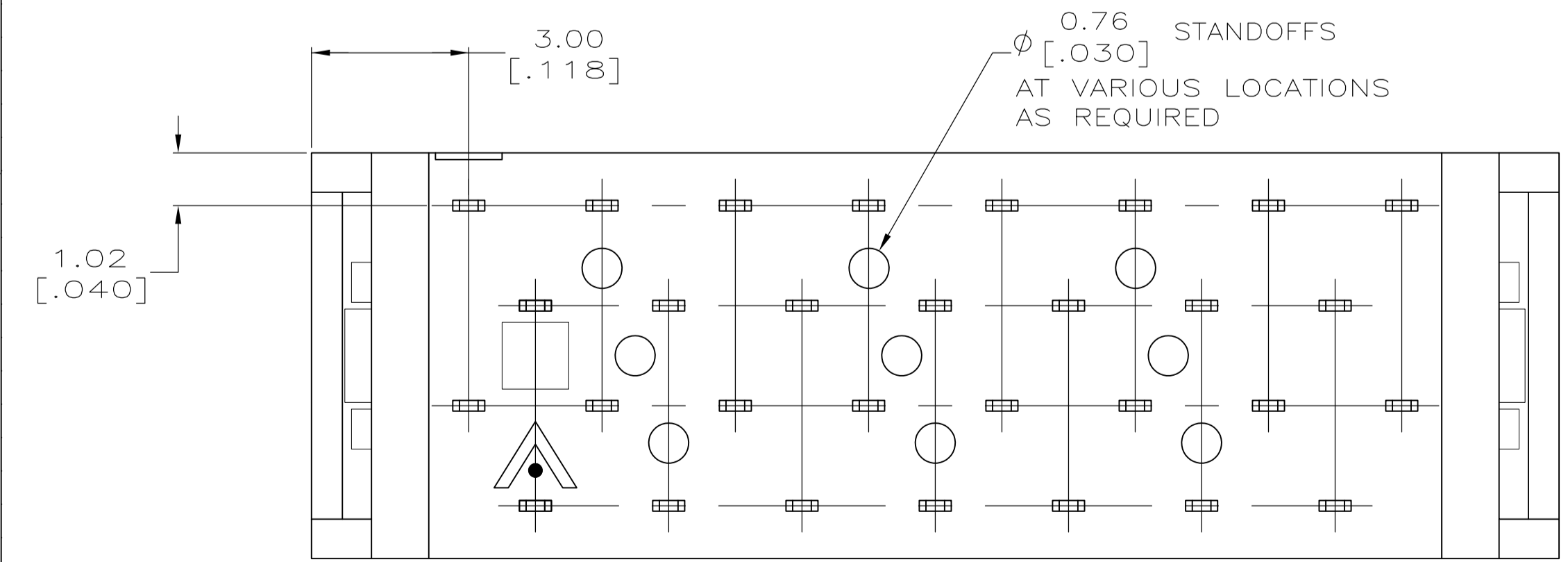
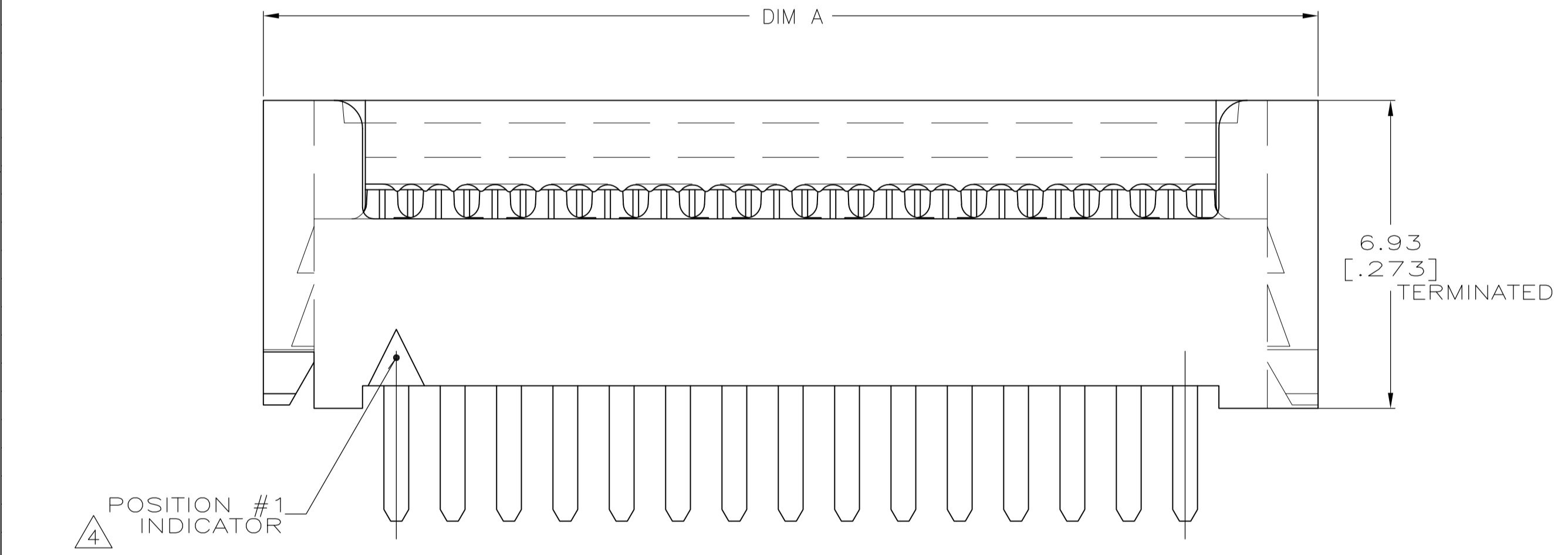

PRELIMINARY	#1	3.30 [.130]	30.48 [1.200]	36.47 [1.436]	50	2-5111595-5
	#1	3.30 [.130]	5.08 [.200]	11.07 [.436]	10	2-5111595-4
	#2	3.30 [.130]	49.53 [1.950]	55.52 [2.186]	80	2-5111595-2 △
	#2	2.54 [.100]	41.91 [1.650]	47.90 [1.886]	68	2-5111595-1
	#2	2.54 [.100]	16.51 [.650]	22.50 [.886]	28	2-5111595-0
	#2	2.54 [.100]	41.91 [1.650]	47.90 [1.886]	68	1-5111595-9
	#1	2.54 [.100]	27.94 [1.100]	33.93 [1.336]	46	1-5111595-7
	#2	2.54 [.100]	62.23 [2.450]	68.22 [2.686]	100	1-5111595-6
	#2	2.54 [.100]	49.53 [1.950]	55.52 [2.186]	80	1-5111595-5
	#2	2.54 [.100]	44.45 [1.750]	50.44 [1.986]	72	1-5111595-4
	#2	2.54 [.100]	39.37 [1.550]	45.36 [1.786]	64	1-5111595-3
	#2	2.54 [.100]	36.83 [1.450]	42.82 [1.686]	60	1-5111595-2
	#1	2.54 [.100]	30.48 [1.200]	36.47 [1.436]	50	1-5111595-1
	#2	2.54 [.100]	26.67 [1.050]	32.66 [1.286]	44	1-5111595-0
	#2	2.54 [.100]	24.13 [.950]	30.12 [1.186]	40	5111595-9
	#1	2.54 [.100]	20.32 [.800]	26.31 [1.036]	34	5111595-8
	#1	2.54 [.100]	17.78 [.700]	23.77 [.936]	30	5111595-7
	#1	2.54 [.100]	15.24 [.600]	21.23 [.836]	26	5111595-6
	#2	2.54 [.100]	13.97 [.550]	19.96 [.786]	24	5111595-5
	#2	2.54 [.100]	11.43 [.450]	17.42 [.686]	20	5111595-4
	#2	2.54 [.100]	8.89 [.350]	14.88 [.586]	16	5111595-3
	#1	2.54 [.100]	7.62 [.300]	13.61 [.536]	14	5111595-2
	#1	2.54 [.100]	5.08 [.200]	11.07 [.436]	10	5111595-1
	PCB LAYOUT	C	B	A	POSN	PART NO

THIS DRAWING IS A CONTROLLED DOCUMENT. DIMENSIONING AND TOLERANCING PER ASME Y14.5M-2009.

STE TE Connectivity

AMPMODU® SYSTEM 50, CONNECTOR, PADDLEBOARD

108-1109

114-25040

00779-5111595

SCALE 10:1 SHEET 1 OF 2 REV E

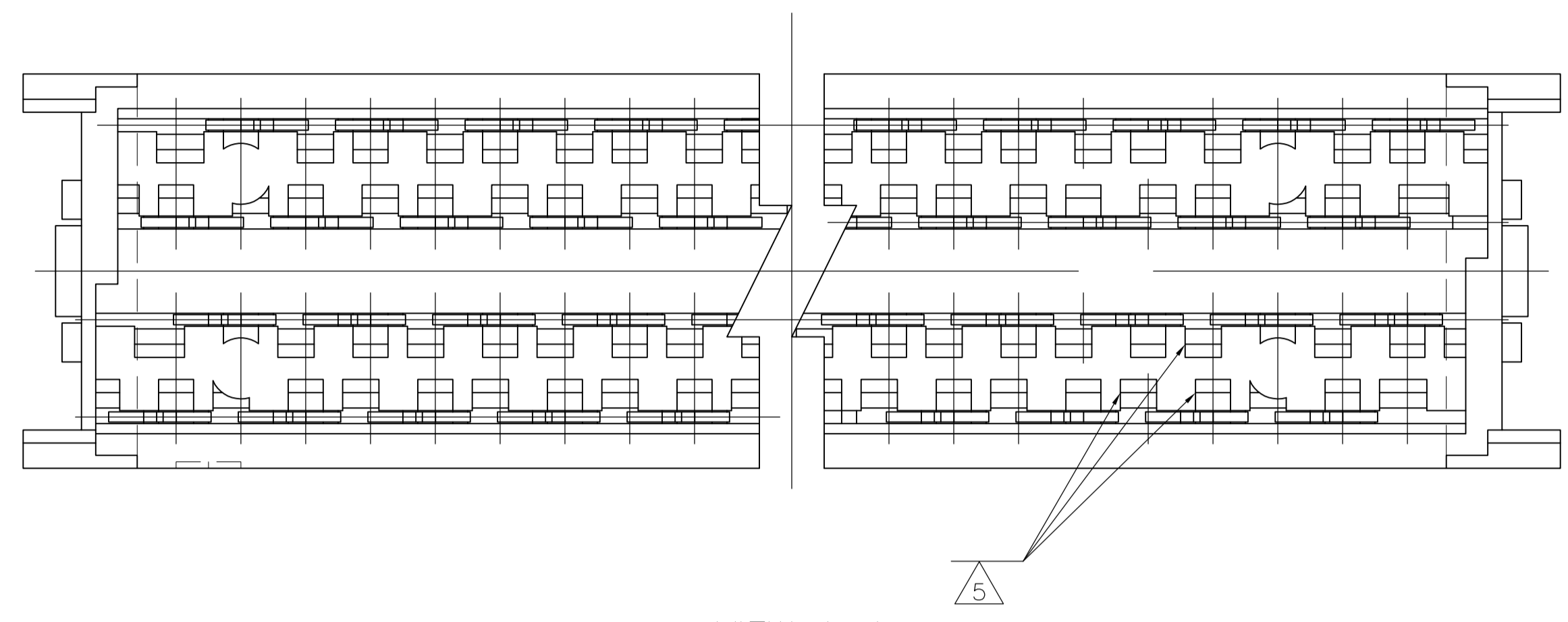

VIEW A-A  
(COVER REMOVED FOR CLARITY)

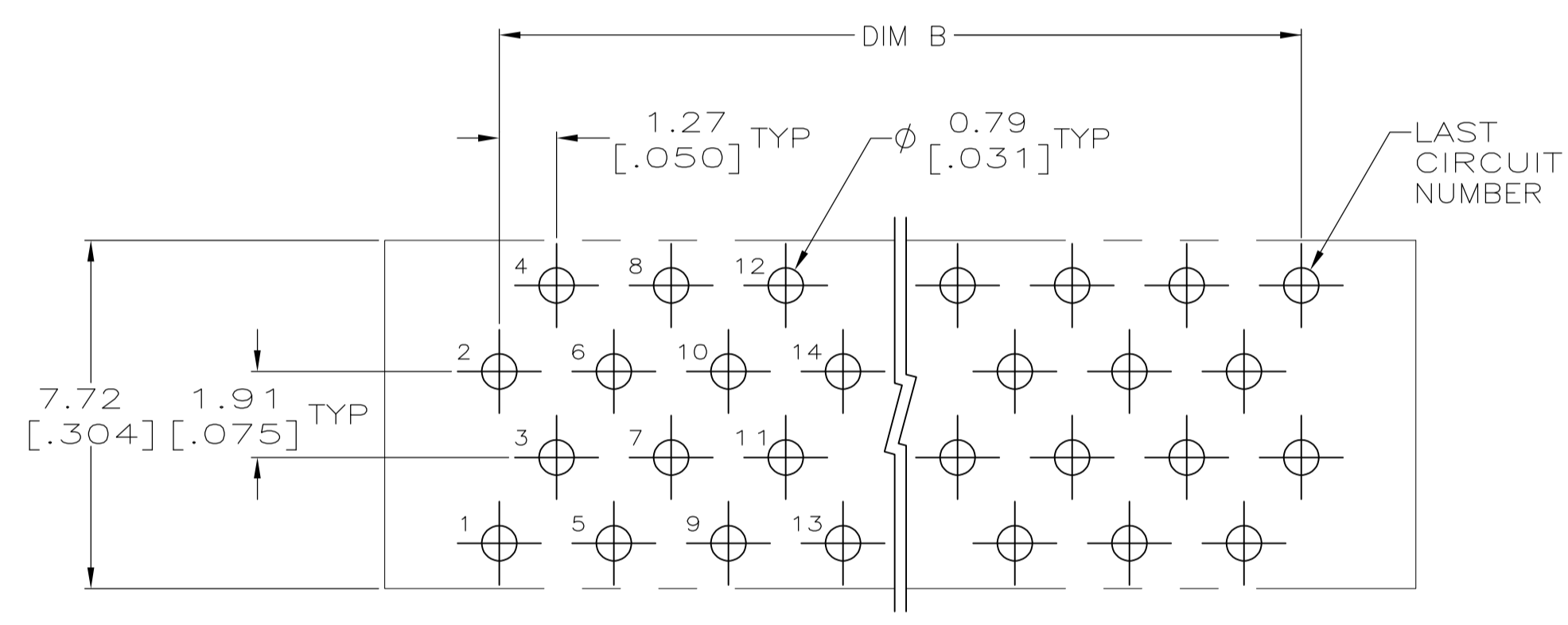

PRINTED CIRCUIT BOARD HOLE LAYOUT #2

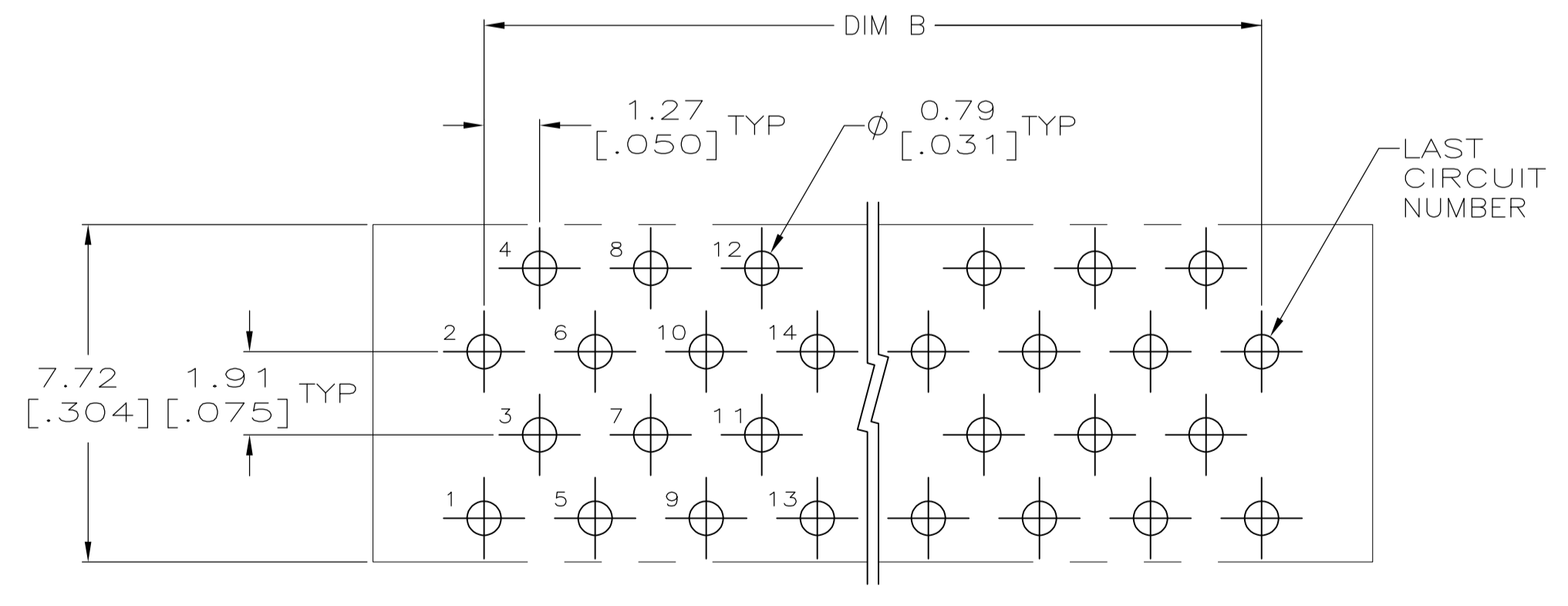

PRINTED CIRCUIT BOARD HOLE LAYOUT #1

THIS DRAWING IS A CONTROLLED DOCUMENT. DIMENSIONING AND TOLERANCING PER ASME Y14.5M-2009		DIN G. ATTADIA 26NOV04	TE Connectivity
DIMENSIONS: mm [INCHES]		CIR C. ROHDE 26NOV04	
TOLERANCES UNLESS OTHERWISE SPECIFIED:		APPD M. WALMSLEY 26NOV04	NAME AMPMODU SYSTEM 50, CONNECTOR, PADDLEBOARD
<ul style="list-style-type: none"> <li>0. PLC ± -</li> <li>1. PLC ± -</li> <li>2. PLC ± -</li> <li>3. PLC ± -</li> <li>4. PLC ± -</li> <li>ANGLES ± -</li> </ul>		APPLICATION SPEC	SIZE A1
MATERIAL SEE SHEET 1	FINISH SEE SHEET 1	WEIGHT -	CAGE CODE 00779
CUSTOMER DRAWING		DRAWING NO 5111595	RESTRICTED TO -
		SCALE 10:1	SHEET 2 OF 2