



Chipsmall Limited consists of a professional team with an average of over 10 year of expertise in the distribution of electronic components. Based in Hongkong, we have already established firm and mutual-benefit business relationships with customers from,Europe,America and south Asia,supplying obsolete and hard-to-find components to meet their specific needs.

With the principle of “Quality Parts,Customers Priority,Honest Operation,and Considerate Service”,our business mainly focus on the distribution of electronic components. Line cards we deal with include Microchip,ALPS,ROHM,Xilinx,Pulse,ON,Everlight and Freescale. Main products comprise IC,Modules,Potentiometer,IC Socket,Relay,Connector.Our parts cover such applications as commercial,industrial, and automotives areas.

We are looking forward to setting up business relationship with you and hope to provide you with the best service and solution. Let us make a better world for our industry!



Contact us

Tel: +86-755-8981 8866 Fax: +86-755-8427 6832

Email & Skype: info@chipsmall.com Web: www.chipsmall.com

Address: A1208, Overseas Decoration Building, #122 Zhenhua RD., Futian, Shenzhen, China



LOC		DIST		REVISIONS			
GP	00	P	LTR	DESCRIPTION	DATE	DWN	APVD
		0		RELEASED PER PPR 095-05	15MAR06	JG	DG

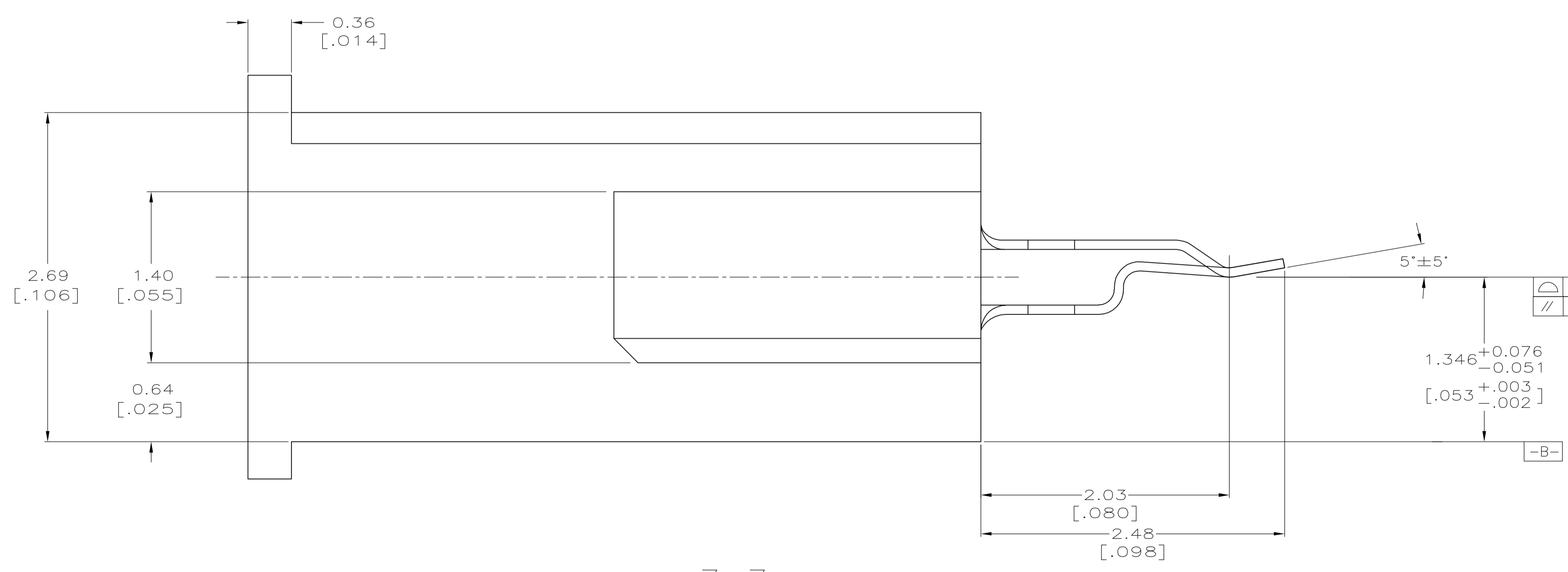
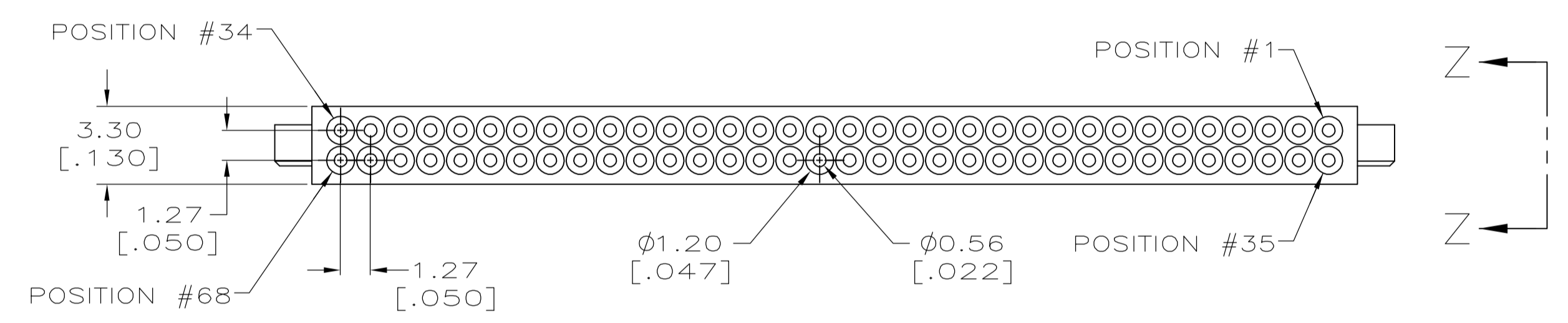
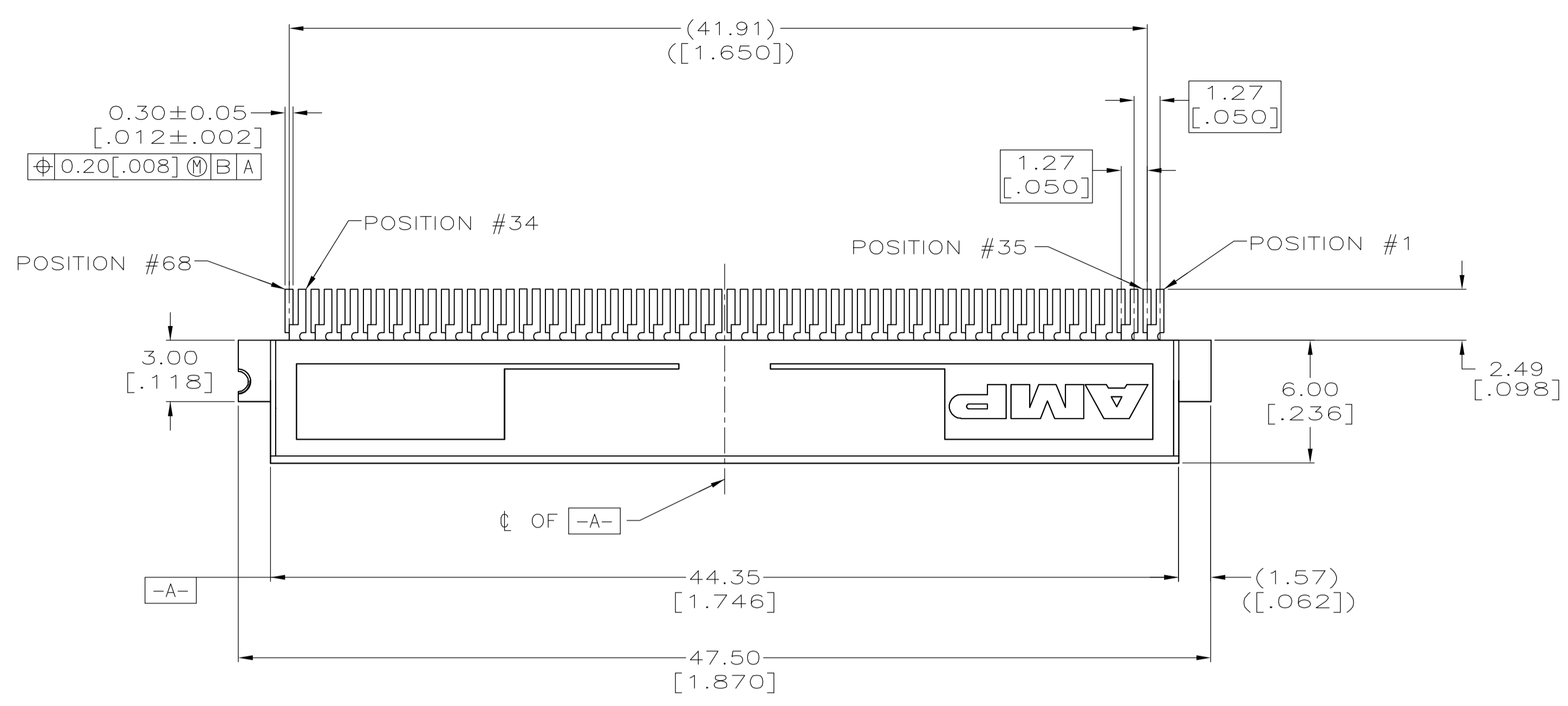

VIEW Z-Z
SCALE 40:1

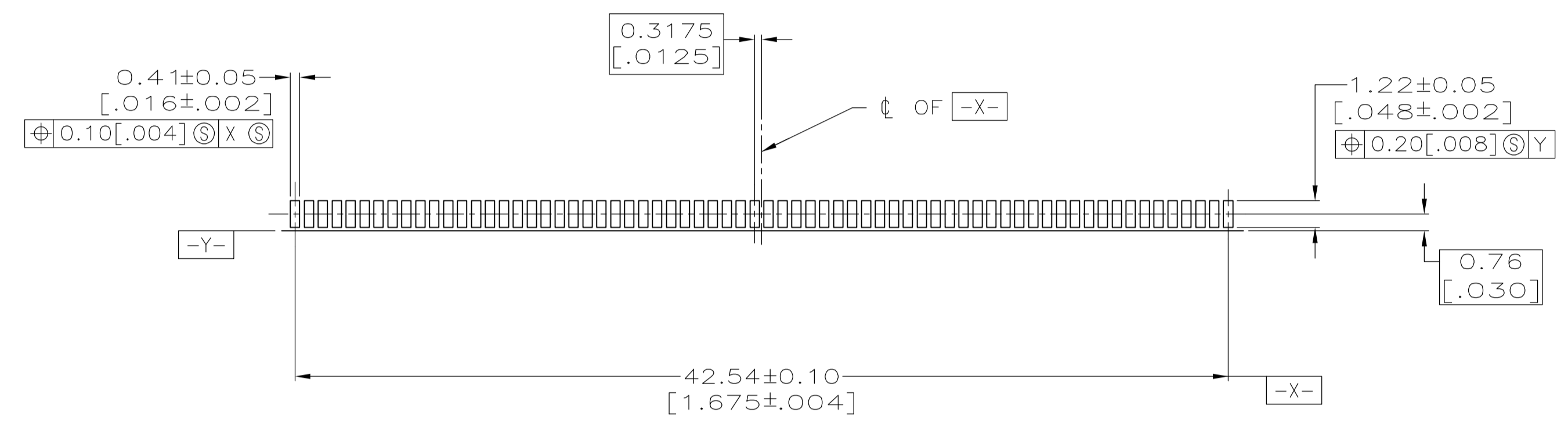

RECOMMENDED PC BOARD LAYOUT

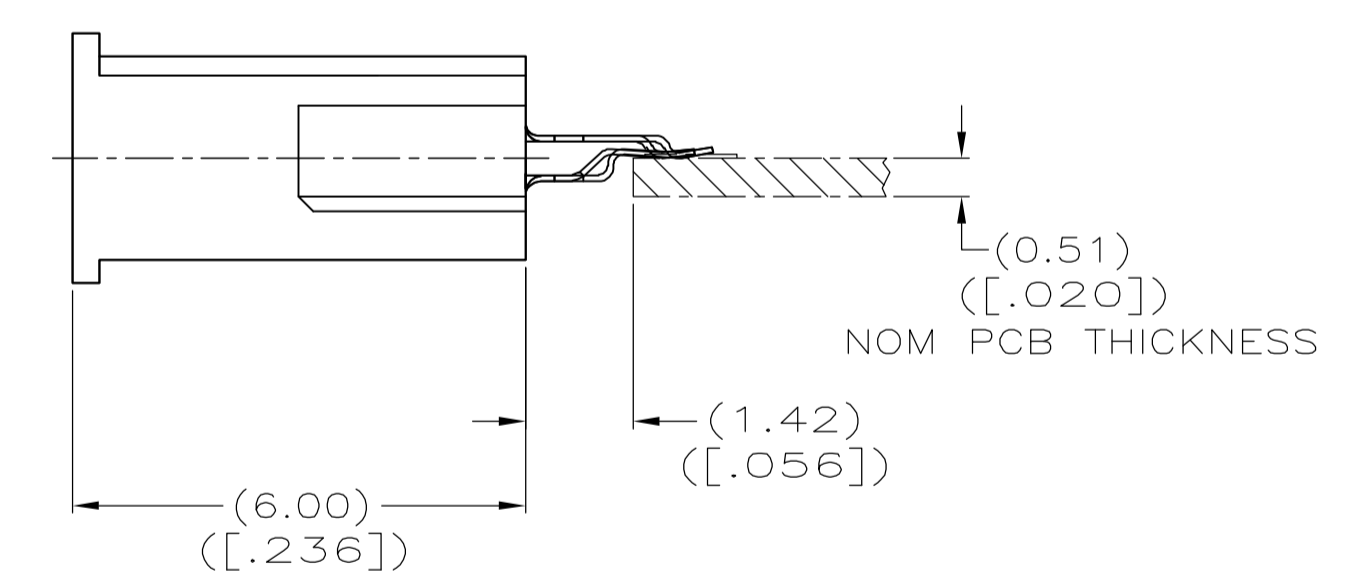

RECOMMENDED PC BOARD LOCATION
SCALE: 10:1

- ① HOUSING: LCP, GLASS FILLED, COLOR BLACK.
- ② CONTACTS: BERYLLIUM COPPER.
- ③ CONTACTS: 0.00076[.000030] MINIMUM GOLD ON MATING AREA, 0.00254[.000100] MINIMUM TIN ON SOLDER TAILS, ALL OVER 0.00127[.000050] MINIMUM NICKEL.
- ④ DIMENSION IN REFERENCE TO LOWEST POINT OF EACH LEAD.
- ⑤ POINT OF CONTACT 2.3[.091] REF FROM MATING FACE.
- ⑥ APPLIES TO ALL SOLDER TAILS.
- ⑦ PACKAGED IN 72mm WIDE TAPE AND PLASTIC REEL.

5146547-1
PART NUMBER

THIS DRAWING IS A CONTROLLED DOCUMENT.		DIN J GERACE 15MAR06		Tyco Electronics Corporation Harrisburg, PA 17105-3608	
DIMENSIONS: mm[INCHES]		CIK D GORENC 15MAR06		APVD M WALMSLEY 15MAR06	NAME
TOLERANCES UNLESS OTHERWISE SPECIFIED:		0 PLC ± - 1 PLC ± - 2 PLC ± - 3 PLC ± 0.13[.005] 4 PLC ± ± 0.30° ANGLES ± ± 0.30°		APPLICATION SPEC	
MATERIAL		FINISH		SIZE	A1
				WEIGHT	000779
				CUSTOMER DRAWING	5146547
				SCALE	5:1
				SHEET	1 of 1
				REV	0