



Chipsmall Limited consists of a professional team with an average of over 10 year of expertise in the distribution of electronic components. Based in Hongkong, we have already established firm and mutual-benefit business relationships with customers from,Europe,America and south Asia,supplying obsolete and hard-to-find components to meet their specific needs.

With the principle of “Quality Parts,Customers Priority,Honest Operation,and Considerate Service”,our business mainly focus on the distribution of electronic components. Line cards we deal with include Microchip,ALPS,ROHM,Xilinx,Pulse,ON,Everlight and Freescale. Main products comprise IC,Modules,Potentiometer,IC Socket,Relay,Connector.Our parts cover such applications as commercial,industrial, and automotives areas.

We are looking forward to setting up business relationship with you and hope to provide you with the best service and solution. Let us make a better world for our industry!



## Contact us

Tel: +86-755-8981 8866 Fax: +86-755-8427 6832

Email & Skype: [info@chipsmall.com](mailto:info@chipsmall.com) Web: [www.chipsmall.com](http://www.chipsmall.com)

Address: A1208, Overseas Decoration Building, #122 Zhenhua RD., Futian, Shenzhen, China



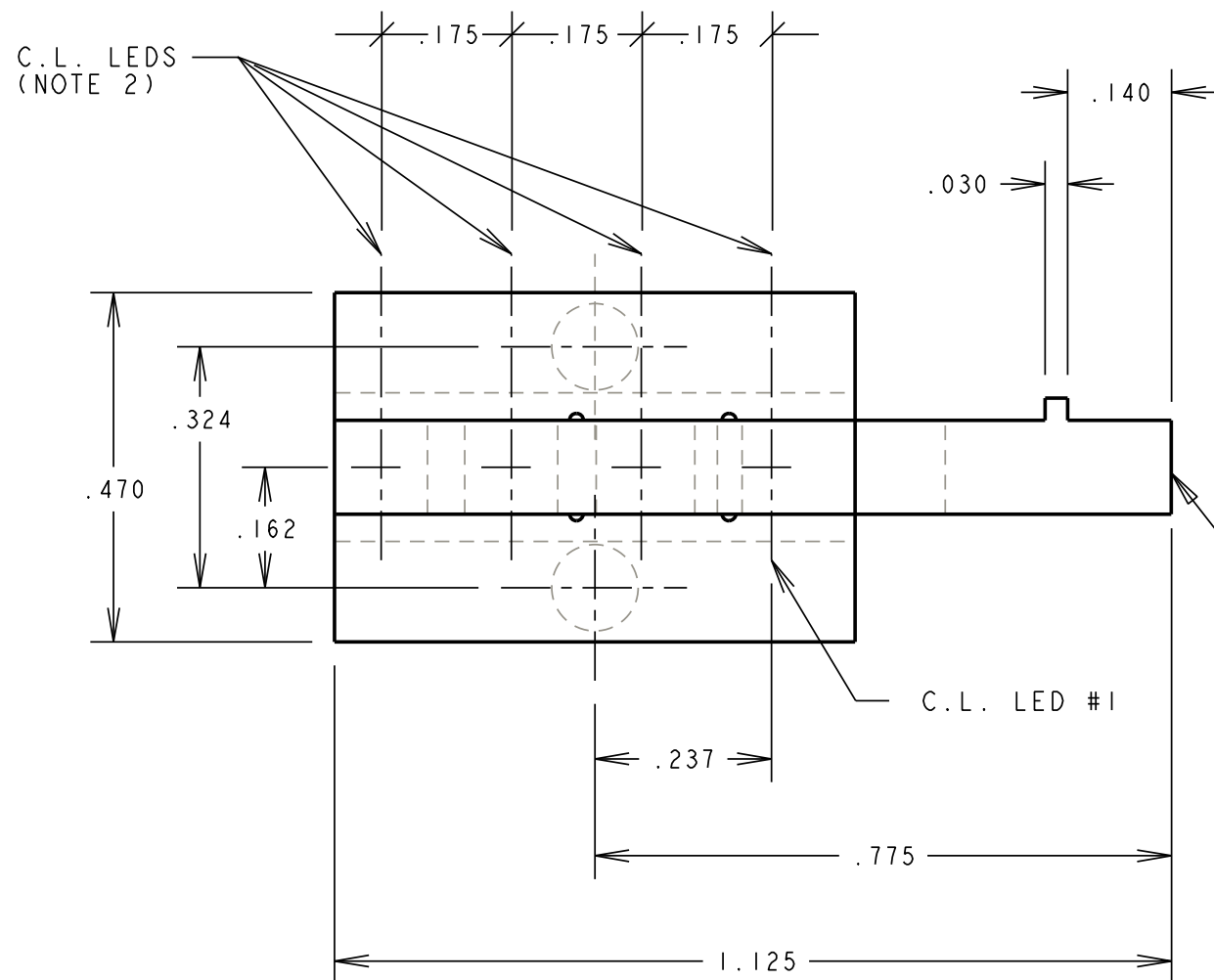

CHARMILLE #24 FINISH;  
FRONT (4) SURFACES ONLY

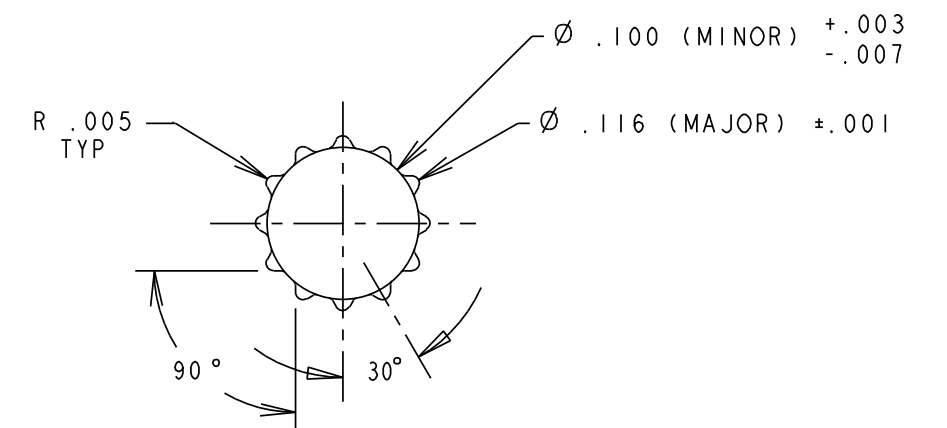
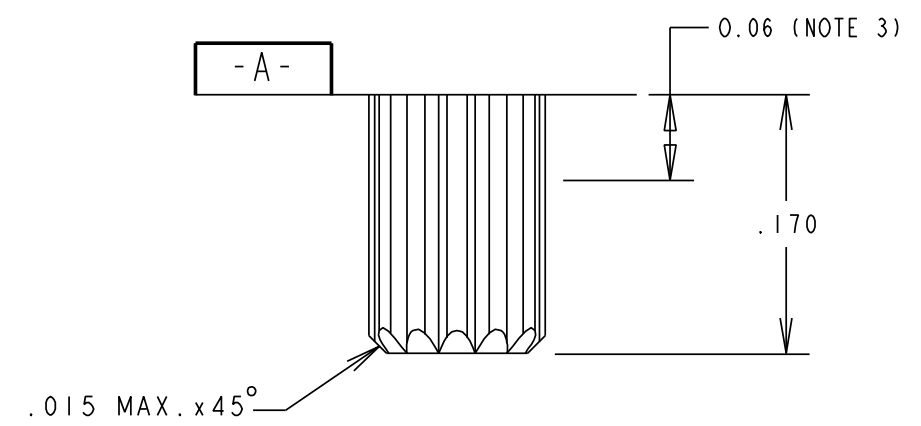
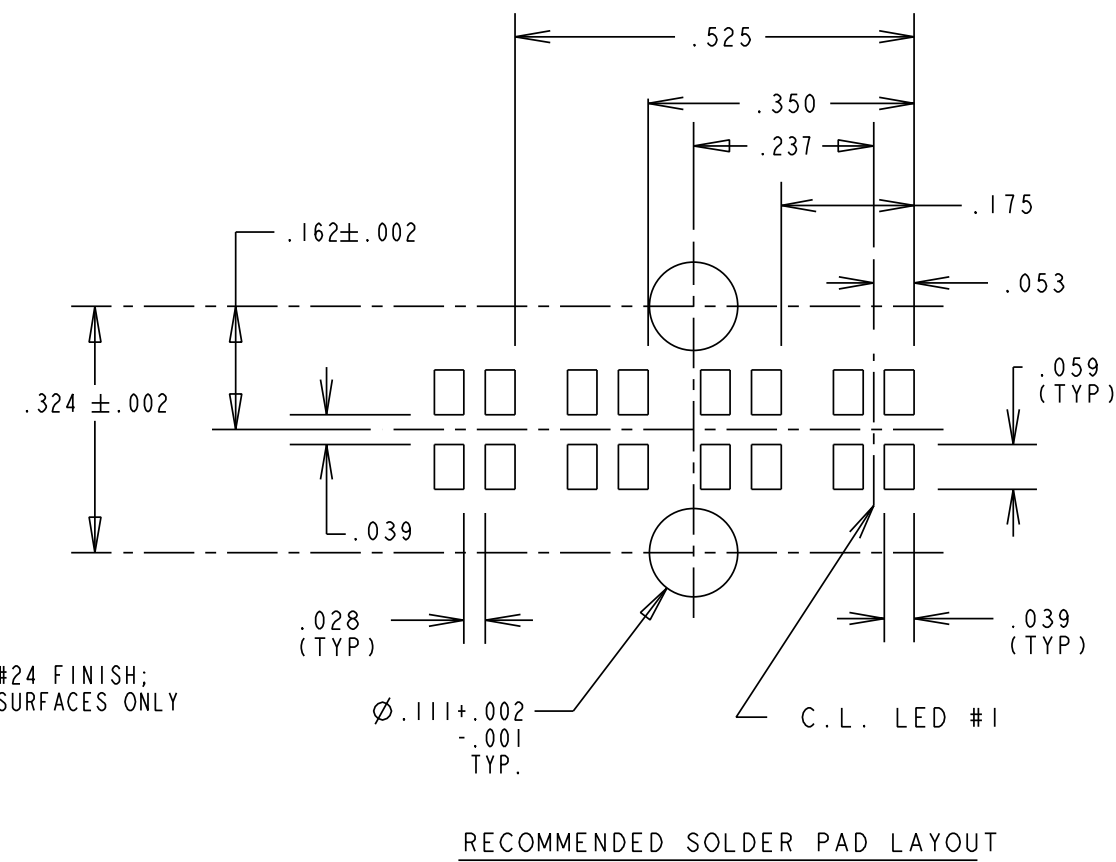

DETAIL "A"

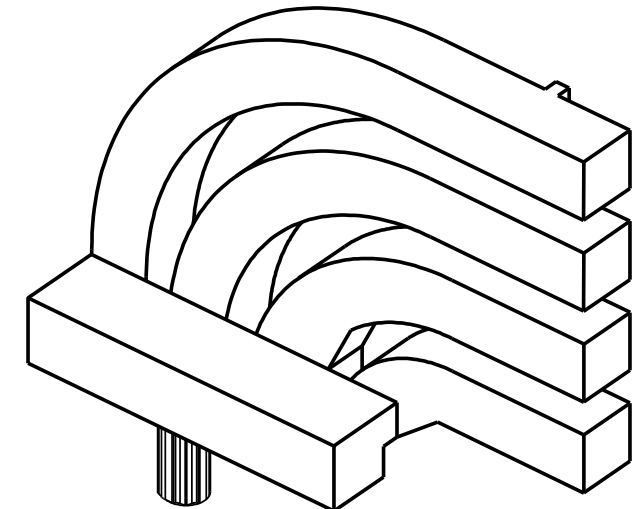

NOTES:

1. COMPONENT TO BE MOLDED IN A WATER CLEAR TRANSMISSIVE POLYCARBONATE.
2. RECOMMENDED PLACEMENT OF LED.
3.  $\varnothing .116 \pm .001$  TO BE MAINTAINED FROM SURFACE -A- TO .06.
4. DIALIGHT PART NO. 515-1023

REV.	ECN NO.	REVISIONS	DRN.	CKD.	APP.	DATE
D		126/.123 WAS .126(MAX); RE-DIMENSIONED "FLANGE TO PIPE EDGES RELATIONSHIP" FROM TOP CORNERS; ADDED MOLDING DRAFT (BOTH SIDES)"; .350 WAS .252; .515 WAS .514; DELETED R .450 SPHERICAL RADII.	MC		M.C.	12-17-93
E		ADDED HOLE DIMS IN PAD LAYOUT, NOTE 3, AND .06 (NOTE 3) AND $\varnothing .116 \pm .001$ WAS $\varnothing .115 \pm .001$	MC		L.R.	8-27-96
F		ADDED CHANNELS FOR SHIELD INSERT.	TC	DC	A.V.	2-15-99

THIS DRAWING AND THE CONTENTS HEREIN ARE CONFIDENTIAL AND THE SOLE PROPERTY OF DIALIGHT. REPRODUCTION OF THIS DRAWING OR CONSTRUCTION OF ANY PARTS WITHIN THIS DRAWING ARE FORBIDDEN WITHOUT THE WRITTEN CONSENT OF DIALIGHT.		
SCALE: 4:1	DRAWING NUMBER	REV
ALL DIM'S IN: INCHES (MM)	C-15820	F
TOLERANCES: UNLESS OTHERWISE SPECIFIED	TITLE	
FRACTIONS: $\pm 1/64$	QUADLEVEL LIGHTPIPE	
DECIMALS (.XX): $\pm .01$	MATERIAL	
DECIMALS (.XXX): $\pm .005$		
ANGLES: $\pm 1^\circ$		
FINISH:		
FSCM 83330	SHEET OF	FAMILY TABLES: