



Chipsmall Limited consists of a professional team with an average of over 10 year of expertise in the distribution of electronic components. Based in Hongkong, we have already established firm and mutual-benefit business relationships with customers from,Europe,America and south Asia,supplying obsolete and hard-to-find components to meet their specific needs.

With the principle of “Quality Parts,Customers Priority,Honest Operation,and Considerate Service”,our business mainly focus on the distribution of electronic components. Line cards we deal with include Microchip,ALPS,ROHM,Xilinx,Pulse,ON,Everlight and Freescale. Main products comprise IC,Modules,Potentiometer,IC Socket,Relay,Connector.Our parts cover such applications as commercial,industrial, and automotives areas.

We are looking forward to setting up business relationship with you and hope to provide you with the best service and solution. Let us make a better world for our industry!



## Contact us

Tel: +86-755-8981 8866 Fax: +86-755-8427 6832

Email & Skype: info@chipsmall.com Web: www.chipsmall.com

Address: A1208, Overseas Decoration Building, #122 Zhenhua RD., Futian, Shenzhen, China



THIS DRAWING IS UNPUBLISHED. RELEASED FOR PUBLICATION  
 © COPYRIGHT BY TYCO ELECTRONICS CORPORATION. ALL INTERNATIONAL RIGHTS RESERVED.

LOC		DIST		REVISIONS			
P	LTR	DESCRIPTION	DATE	DWN	APVD		
AF	50						
	J	REVISED PER ECR-10-024831	02MAR11	HMR	GJ		

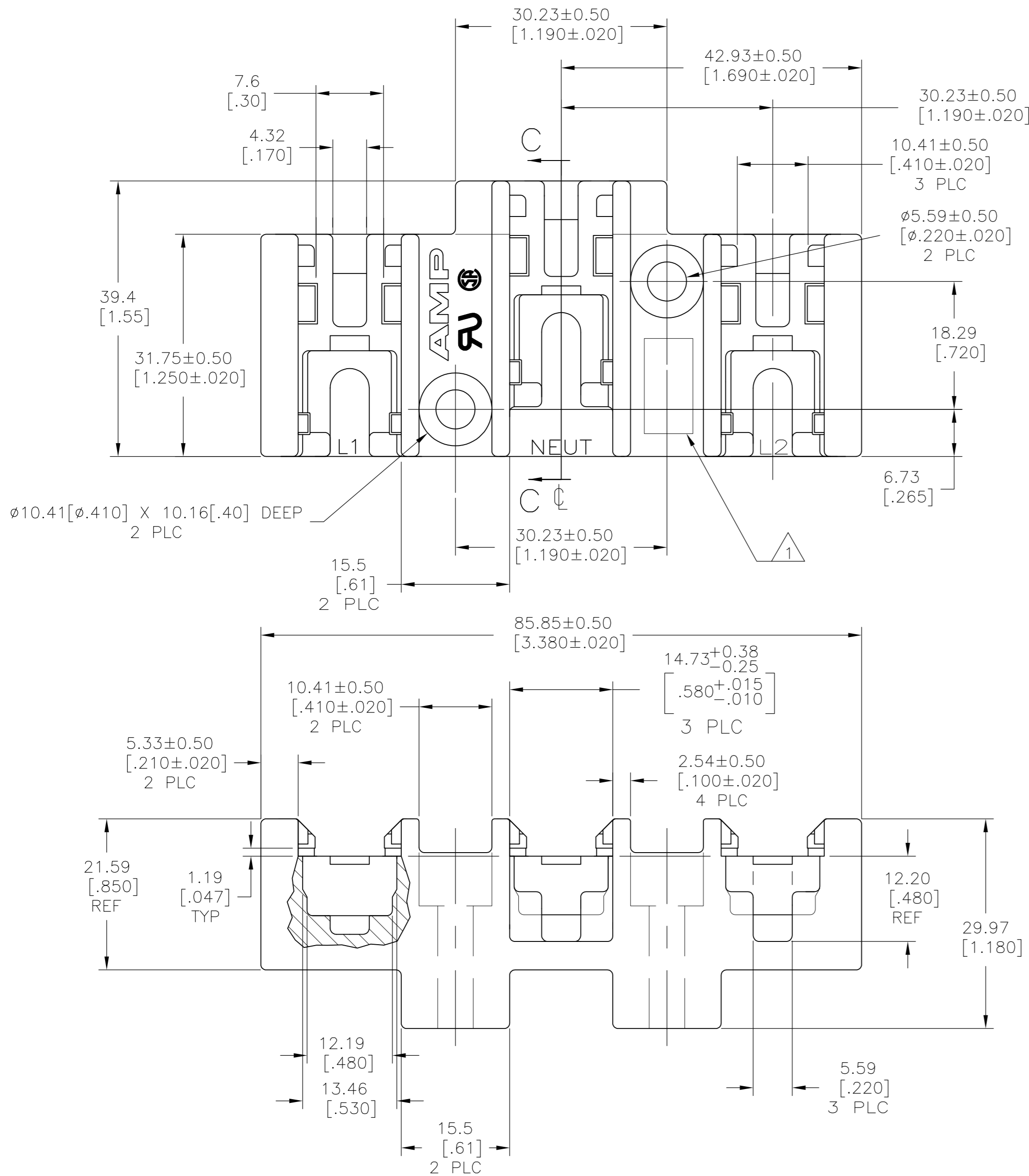

- 1 MARKED WITH NO. WB17X 5095, LOCATED APPROX IN AREA SHOWN.
- 2 OBSOLETE PARTS: OBSOLETE CIS STREAMLINING PER D.RENAUD/D.SINISI

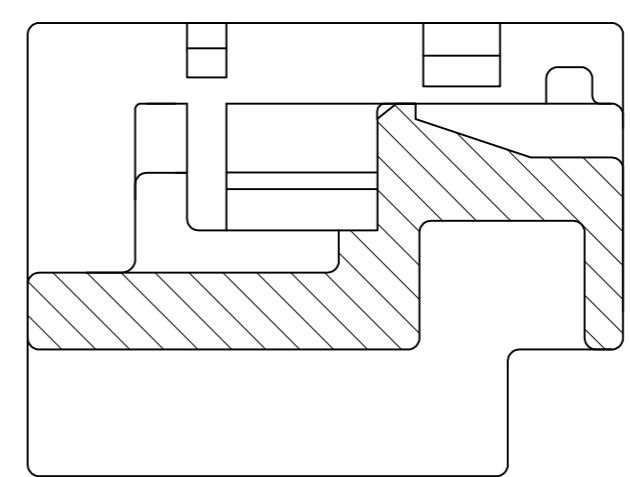

2 SUPERCEDED BY 520942-1	520942-2
1	520942-1
PART NO	

THIS DRAWING IS A CONTROLLED DOCUMENT.		DWN	JR RUTH	8/23/88	Tyco Electronics Corporation Harrisburg, PA 17105-3608		
DIMENSIONS: mm [INCHES]		CHK	MS FEHER	8/24/88			
TOLERANCES UNLESS OTHERWISE SPECIFIED:		APVD	RP FRANTZ	8/29/88	NAME		
0 PLC ± - 1 PLC ± 0.5 [.02] 2 PLC ± 0.25 [.010] 3 PLC ± - 4 PLC ± - ANGLES ± -		PRODUCT SPEC		108-1191			
MATERIAL PHENOLIC		FINISH BLACK		APPLICATION SPEC		114-2087	
		WEIGHT	-		SIZE	A2	
		CUSTOMER DRAWING		CAGE CODE	00779	DRAWING NO	
				C=520942		RESTRICTED TO	
				SCALE	2:1	SHEET	
				1 of 1		REV	
				J			