



Chipsmall Limited consists of a professional team with an average of over 10 year of expertise in the distribution of electronic components. Based in Hongkong, we have already established firm and mutual-benefit business relationships with customers from,Europe,America and south Asia,supplying obsolete and hard-to-find components to meet their specific needs.

With the principle of "Quality Parts,Customers Priority,Honest Operation,and Considerate Service",our business mainly focus on the distribution of electronic components. Line cards we deal with include Microchip,ALPS,ROHM,Xilinx,Pulse,ON,Everlight and Freescale. Main products comprise IC,Modules,Potentiometer,IC Socket,Relay,Connector.Our parts cover such applications as commercial,industrial, and automotives areas.

We are looking forward to setting up business relationship with you and hope to provide you with the best service and solution. Let us make a better world for our industry!



## Contact us

Tel: +86-755-8981 8866 Fax: +86-755-8427 6832

Email & Skype: info@chipsmall.com Web: www.chipsmall.com

Address: A1208, Overseas Decoration Building, #122 Zhenhua RD., Futian, Shenzhen, China



## Model 5218 & Assembly Instructions Triaxial Male 3 Lung Connector To Cable

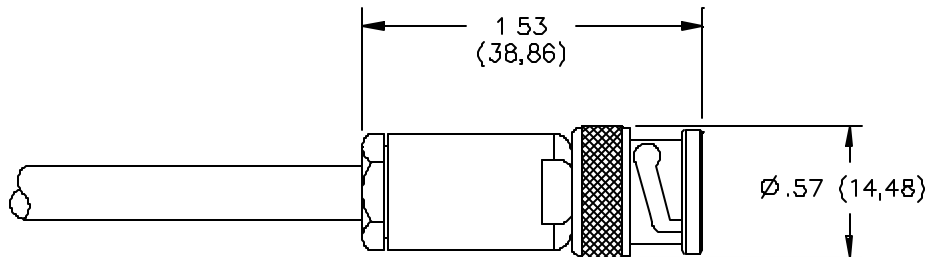

### FEATURES:

- Fits Belden triaxial 9222 .242" O.D.

### MATERIALS:

Body and Fittings: Brass, Tarnish Resistant Plating  
Center Contact: Male: Brass, Tarnish Resistant Plating  
Female: Gold Plated Beryllium Copper  
Outer Contact: Gold Plated Beryllium Copper  
Dielectric: PTFE

### RATINGS:

Voltage: 500 VRMS  
Impedance: 50 Ohms  
Temperature: -65° C. (-85° F.) to +165° C. (+329° F.)  
Frequency Range: DC to 500MHz

### ORDERING INFORMATION: Model 5218

All dimensions are in inches and metric. All specifications are to the latest revisions. Specifications are subject to change without notice.  
Registered trademarks are the property of their respective companies. Made in USA

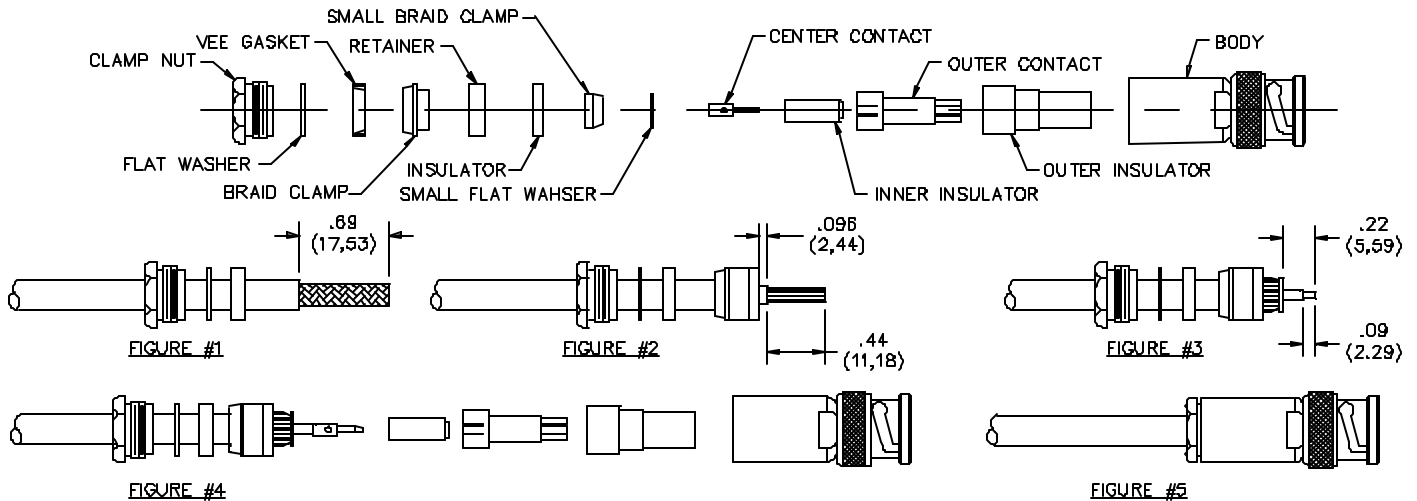

### FIGURE #1

Slide clamp nut, flat washer and Vee gasket over cable.  
Strip outer jacket or cable.

### FIGURE #2

Comb braid forward.  
Slide braid clamp over braid and against outer cable jacket. Fold braid back over braid clamp, trim even with base of braid clamp.  
Assemble retainer and insulator over inner jacket.  
Trim inner jacket.

### FIGURE #3

Place small braid clamp over inner braid and against inner jacket, comb out inner braid and fold inner braid back over small braid clamp, trim inner braid even with base of small braid clamp.  
Assemble washer over dielectric against inner braid.  
Trim inner dielectric and center conductor.

### FIGURE #4

Solder center contact to center conductor.  
Place inner insulator, outer contact and outer insulator over center contact and insert into body.  
Slide clamp nut, washer and Vee gasket forward, thread assembly into body and tighten.

### FIGURE #5

Completed assembly shown.

All dimensions are in inches and metric. All specifications are to the latest revisions. Specifications are subject to change without notice.  
Registered trademarks are the property of their respective companies. Made in USA

Sales: 800-490-2361 Fax: 888-403-3360  
Technical Assistance: 800-241-2060

PomonaACCESS 90111 (800) 444-6785 or (425) 446-6010  
More drawings available at [www.pomonaelectronics.com](http://www.pomonaelectronics.com)