



Chipsmall Limited consists of a professional team with an average of over 10 year of expertise in the distribution of electronic components. Based in Hongkong, we have already established firm and mutual-benefit business relationships with customers from,Europe,America and south Asia,supplying obsolete and hard-to-find components to meet their specific needs.

With the principle of "Quality Parts,Customers Priority,Honest Operation,and Considerate Service",our business mainly focus on the distribution of electronic components. Line cards we deal with include Microchip,ALPS,ROHM,Xilinx,Pulse,ON,Everlight and Freescale. Main products comprise IC,Modules,Potentiometer,IC Socket,Relay,Connector.Our parts cover such applications as commercial,industrial, and automotives areas.

We are looking forward to setting up business relationship with you and hope to provide you with the best service and solution. Let us make a better world for our industry!



## Contact us

Tel: +86-755-8981 8866 Fax: +86-755-8427 6832

Email & Skype: info@chipsmall.com Web: www.chipsmall.com

Address: A1208, Overseas Decoration Building, #122 Zhenhua RD., Futian, Shenzhen, China



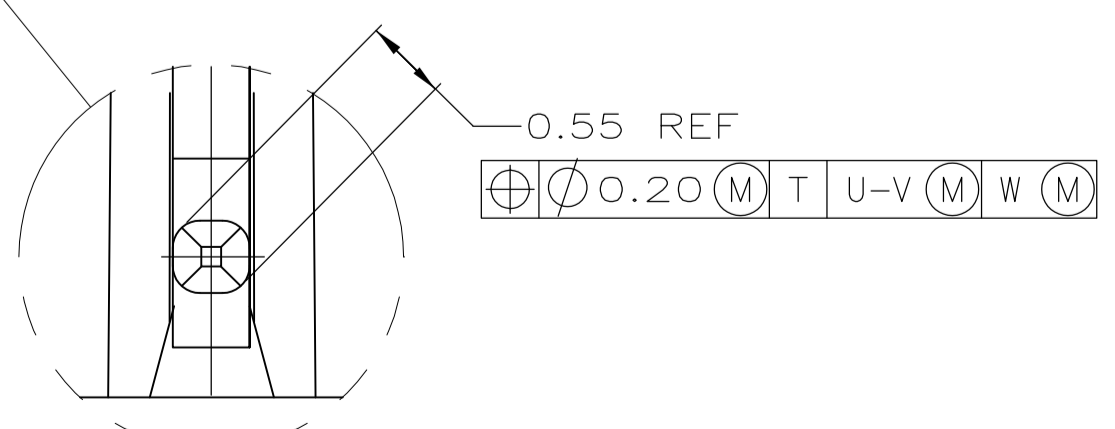
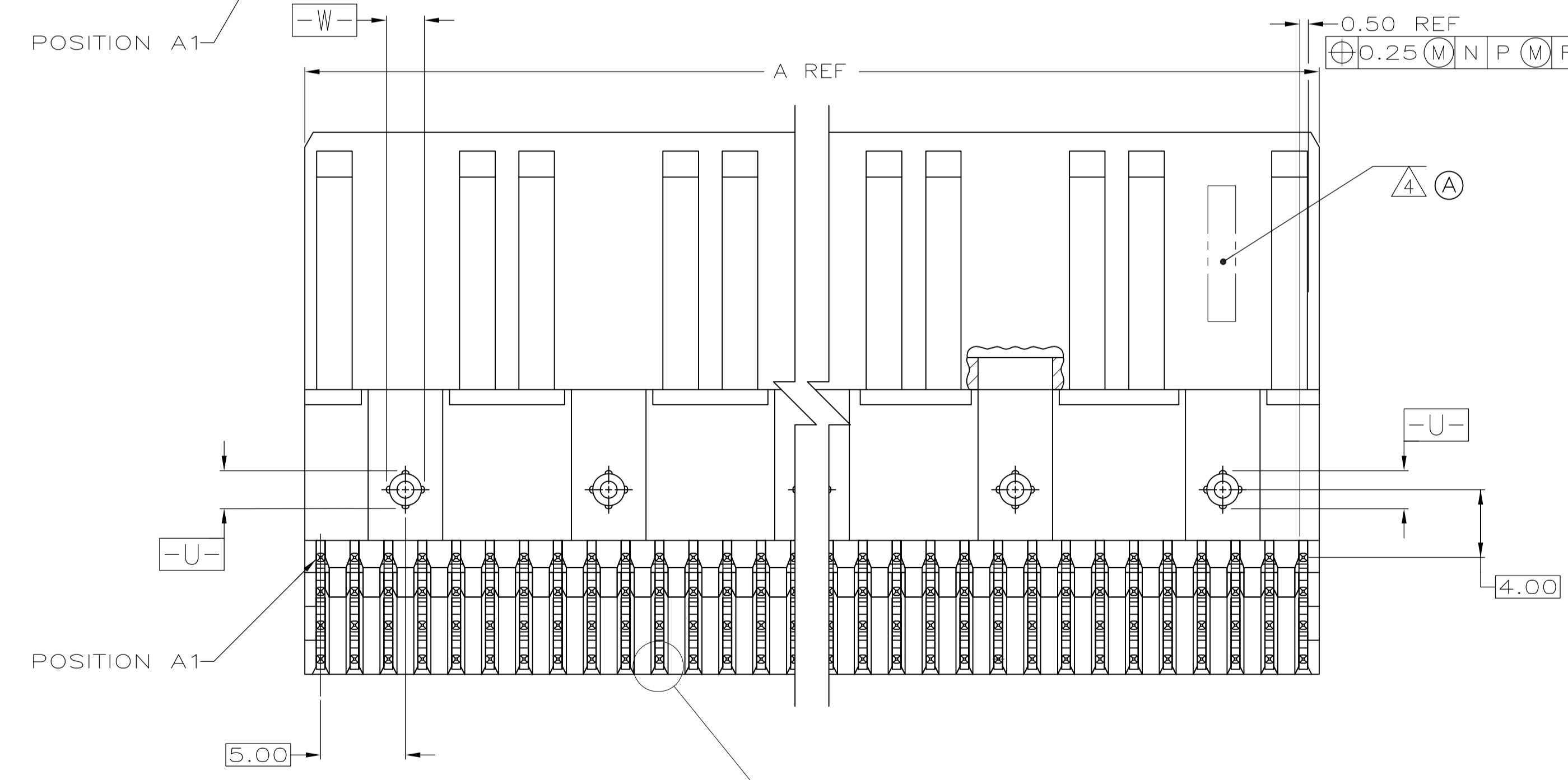
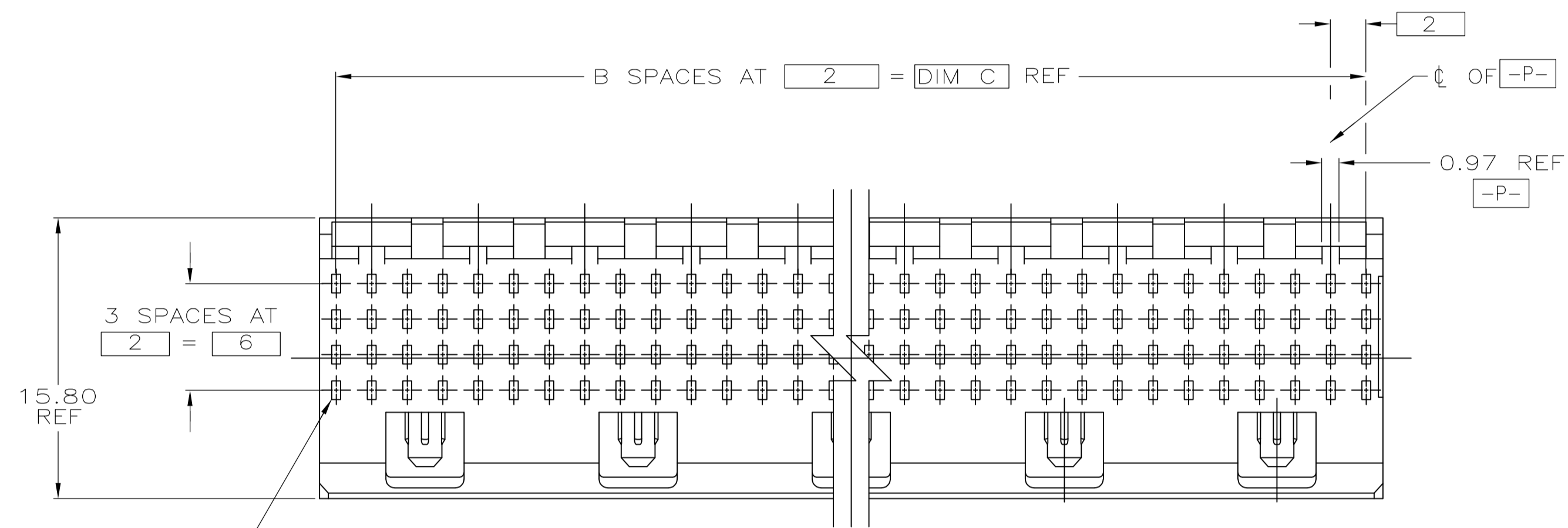
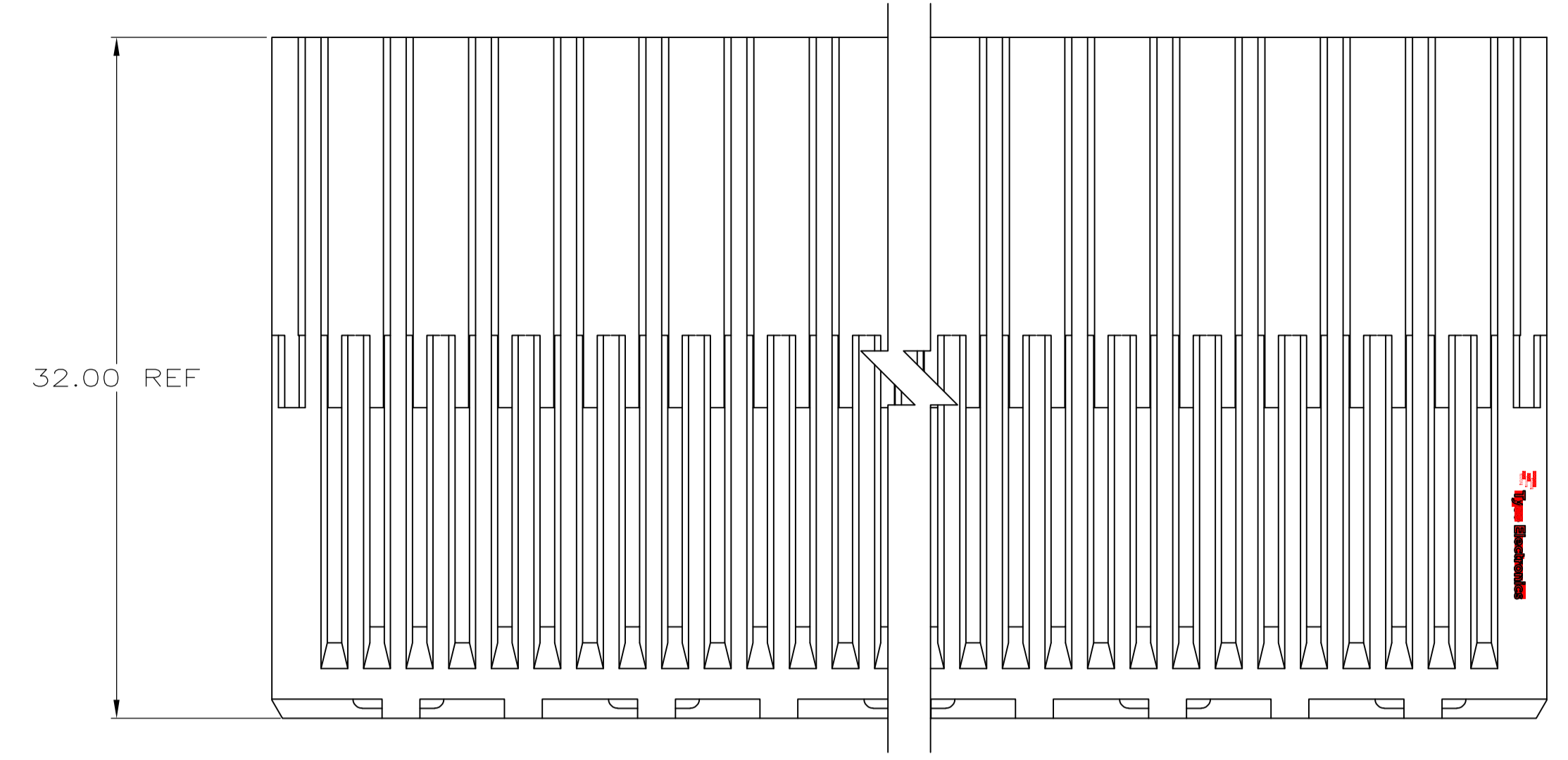

SCALE 20:1

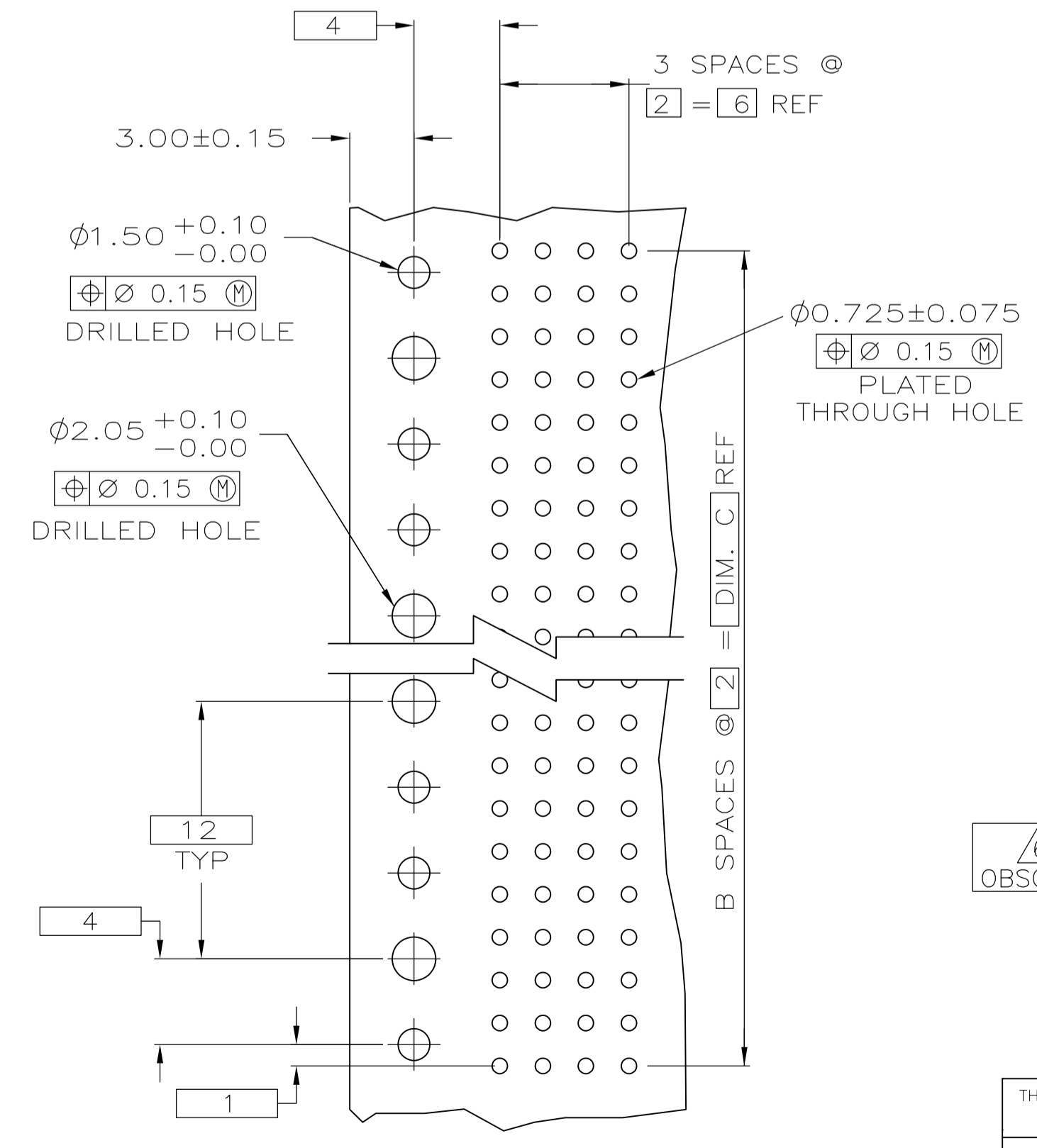
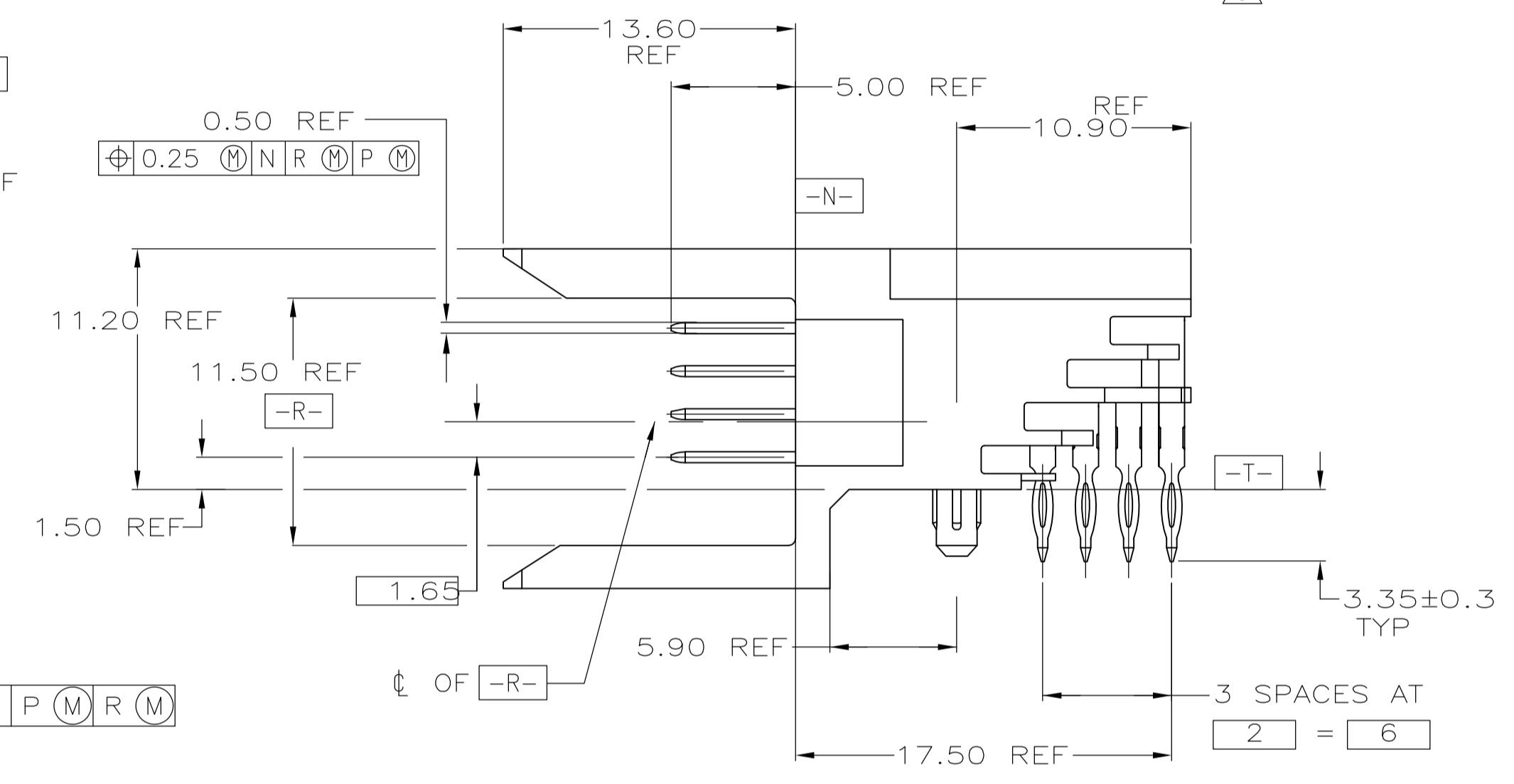

RECOMMENDED CIRCUIT PATTERN PER IPC-D300 TYPE II, CLASS C (COMPONENT SIDE)

- △ HOUSING MATERIAL: LIQUID CRYSTAL POLYMER  
COLOR: NATURAL.
- △ CONTACT MATERIAL: PHOSPHOR BRONZE PER UNS  
ALLOY NO. C51100, TEMPER: H04.
- △ CONTACT FINISH:(C)  
UNDERPLATE (ENTIRE CONTACT):  
0.00127 MIN NICKEL PER SAE-AMS-QQ-N-290  
ON MATING SURFACES:  
CONFORMS TO ALL TESTING SPECIFIED FOR TELCORDIA  
UNCONTROLLED ENVIRONMENT.  
ON LEADS:  
0.0005 MIN MATTE TIN PER ASTM B 545 OVER UNDERPLATE.  
LUBRICATION (MIN MATING SURFACES):  
SURFACE CONDITIONER AFTER PLATING.
- Ⓐ △ PART MARKING PER TE SPEC 115-9009 LOCATED APPROXIMATELY AS SHOWN BETWEEN RIBS/SLOTS ON EITHER SIDE OF HOUSING AT MANUFACTURER'S DISCRETION.
- △ PART TO BE MARKED WITH DATE CODE ONLY.
- △ OBSOLETE PARTS: OBSOLETE CIS STREAMLINING PER D.RENAUD/D.SINISI

OBSOLETE	FINISH			NO OF POSN	PART NUMBER
	C	B	A		
	58	29	59.88	120	5223514-6
	70	35	71.88	144	5223514-5
	94	47	95.88	192	5223514-4
	46	23	47.88	96	5223514-3
	22	11	23.88	48	5223514-2
	10	5	11.88	24	5223514-1

THIS DRAWING IS A CONTROLLED DOCUMENT.

DIMENSIONS:	TOLERANCES UNLESS OTHERWISE SPECIFIED:	DIN B MCMMASTER 14DEC04	Tyco Electronics Corporation
mm	0.15 ± -	14DEC04	Harrisburg, PA 17105-3608
1.50 ± 0.10	± -	14DEC04	ASSEMBLY, PIN, SIGNAL, RIGHT ANGLE, 4 ROW, Z-PACK 2mm FB
2.05 ± 0.10	± 0.13		SIZE CAGE CODE DRAWING NO
0.725 ± 0.075	± -		A1 00779 C=5223514
0.15 ± -	± -		RESTRICTED TO
0.15 ± -	± -		WEIGHT
0.15 ± -	± -		SCALE 4:1 SHEET 1 OF 1 REV B
0.15 ± -	± -		CUSTOMER DRAWING