



Chipsmall Limited consists of a professional team with an average of over 10 year of expertise in the distribution of electronic components. Based in Hongkong, we have already established firm and mutual-benefit business relationships with customers from,Europe,America and south Asia,supplying obsolete and hard-to-find components to meet their specific needs.

With the principle of "Quality Parts,Customers Priority,Honest Operation,and Considerate Service",our business mainly focus on the distribution of electronic components. Line cards we deal with include Microchip,ALPS,ROHM,Xilinx,Pulse,ON,Everlight and Freescale. Main products comprise IC,Modules,Potentiometer,IC Socket,Relay,Connector.Our parts cover such applications as commercial,industrial, and automotives areas.

We are looking forward to setting up business relationship with you and hope to provide you with the best service and solution. Let us make a better world for our industry!



## Contact us

Tel: +86-755-8981 8866 Fax: +86-755-8427 6832

Email & Skype: info@chipsmall.com Web: www.chipsmall.com

Address: A1208, Overseas Decoration Building, #122 Zhenhua RD., Futian, Shenzhen, China



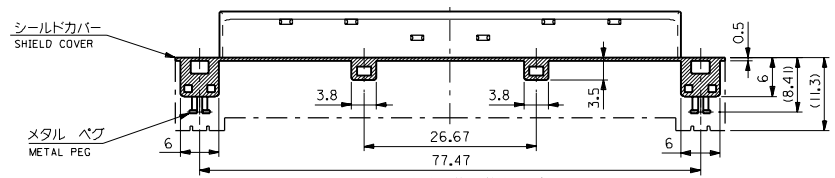
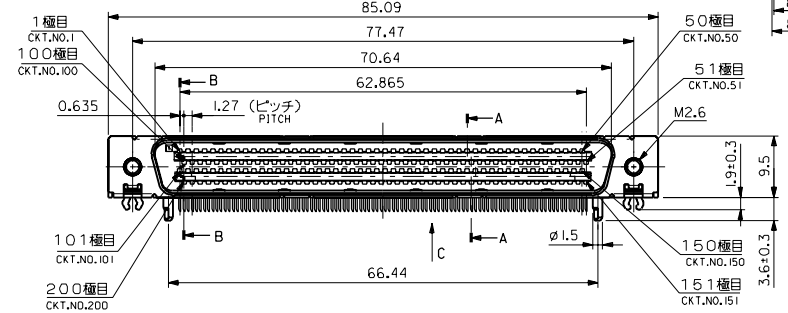
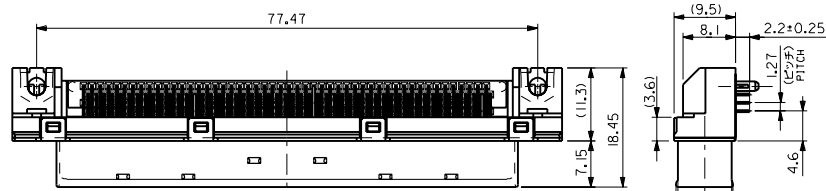

シールド底面詳細 (矢視 C)  
DIMENSION OF SHIELD (VIEW C)

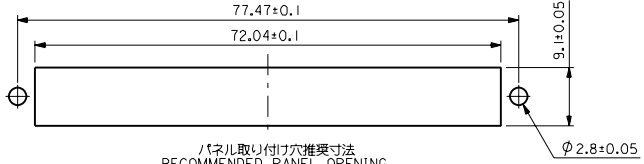

パネル取り付け推奨寸法  
RECOMMENDED PANEL OPENING

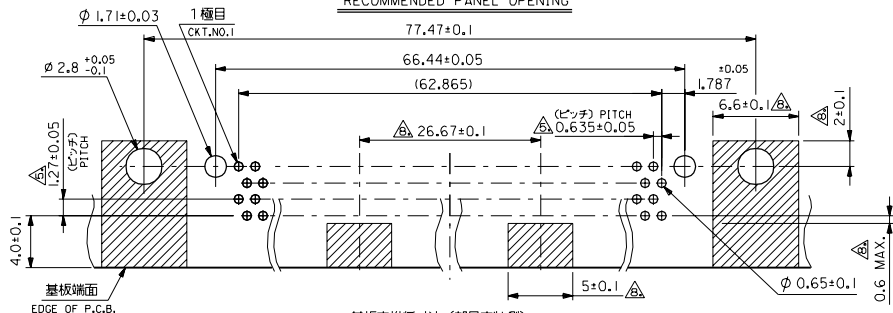

基板穴推奨寸法 (部品実装側)  
RECOMMENDED P.C.B. LAYOUT (COMPONENT SIDE)  
SCALE:4-1

注) NOTES

1. 材質 MATERIAL  
 ノブリング : ガラス入り耐熱樹脂, 白色, UL94V-0  
 G.F.HEAT RESISTANT PLASTIC, WHITE, UL94V-0  
 ガイドプレート : ガラス入り耐熱樹脂, 白色, UL94V-0  
 G.F.HEAT RESISTANT PLASTIC, WHITE, UL94V-0  
 ターミナル : りん青銅  
 TERMINAL : PHOSPHOR BRONZE  
 シールドカバー : 鋼材  
 SHIELD COVER : STEEL  
 メタル ペグ : 鋼材  
 METAL PEG : STEEL
  2. ターミナル メッキ仕様 TERMINAL PLATING  
 金メッキ : 0.76 μm MIN. (接点部) (CONTACT AREA)  
 GOLD  
 TIN-LEAD : 1.0 μm MIN. (半田付け部) (SOLDER AREA)  
 ニッケルメッキ : 2.0 μm MIN. (下地メッキ) (UNDER PLATING)  
 NICKEL
  3. シールド メッキ仕様 SHIELD COVER PLATING  
 ニッケルメッキ : 2.0 μm MIN.  
 NICKEL
  4. メタルペグ メッキ仕様 METAL PEG PLATING  
 TIN-LEAD : 1.0 μm MIN.
- △ 公差非累積 TOLERANCES : NON CUMULATIVE  
 △ 適用極 : 10, 102, 149, 150, 151, 152, 199, 200 APPLIES TO CKT. No.s \*10, 102, 149, 150, 151, 152, 199, 200  
 7. 取り付けパネル厚さ : 1.5 mm MAX. RECOMMENDED PANEL THICKNESS  
 △ パターン禁止エリア NO FOOT PRINT AREA

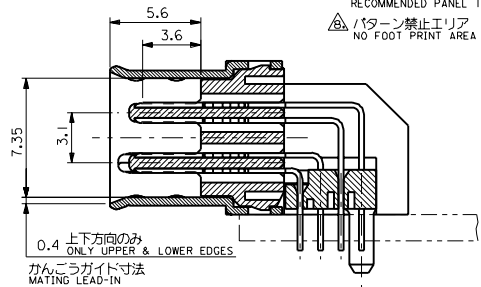

断面 A-A  
SECTION A-A  
SCALE:5-1

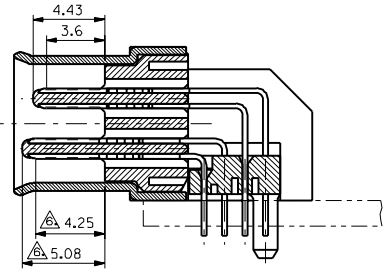

断面 B-B  
SECTION B-B  
SCALE:5-1

材料 MATERIAL		注参照 SEE NOTES		MOLEX JAPAN CO., LTD. 日本モレックス株式会社
仕上げ FINISH		注参照 SEE NOTES		
適用電線範囲 WIRE RANGE		—		REVISE ONLY ON CAD SYSTEM
被覆径径 INS. RANGE		—		TITLE 名称
DRIVEN BY		CHK'D BY		I.27 I/O B TO B CONN. PLUG ASS'Y
DRAWN BY		CHK'D BY		
新機作成 RELEASED		17/02/01		DWG. NO.
REVISED		17/02/01		SD-52539-2001
REVISION RECORD		REV. 内容		REV
APPROD BY		尺 1/2		A
SCALE		2-1		