



Chipsmall Limited consists of a professional team with an average of over 10 year of expertise in the distribution of electronic components. Based in Hongkong, we have already established firm and mutual-benefit business relationships with customers from,Europe,America and south Asia,supplying obsolete and hard-to-find components to meet their specific needs.

With the principle of “Quality Parts,Customers Priority,Honest Operation,and Considerate Service”,our business mainly focus on the distribution of electronic components. Line cards we deal with include Microchip,ALPS,ROHM,Xilinx,Pulse,ON,Everlight and Freescale. Main products comprise IC,Modules,Potentiometer,IC Socket,Relay,Connector.Our parts cover such applications as commercial,industrial, and automotives areas.

We are looking forward to setting up business relationship with you and hope to provide you with the best service and solution. Let us make a better world for our industry!



## Contact us

Tel: +86-755-8981 8866 Fax: +86-755-8427 6832

Email & Skype: [info@chipsmall.com](mailto:info@chipsmall.com) Web: [www.chipsmall.com](http://www.chipsmall.com)

Address: A1208, Overseas Decoration Building, #122 Zhenhua RD., Futian, Shenzhen, China



## 5306 Series T-1 3/4 Right Angle LED Assembly

### Description and Features

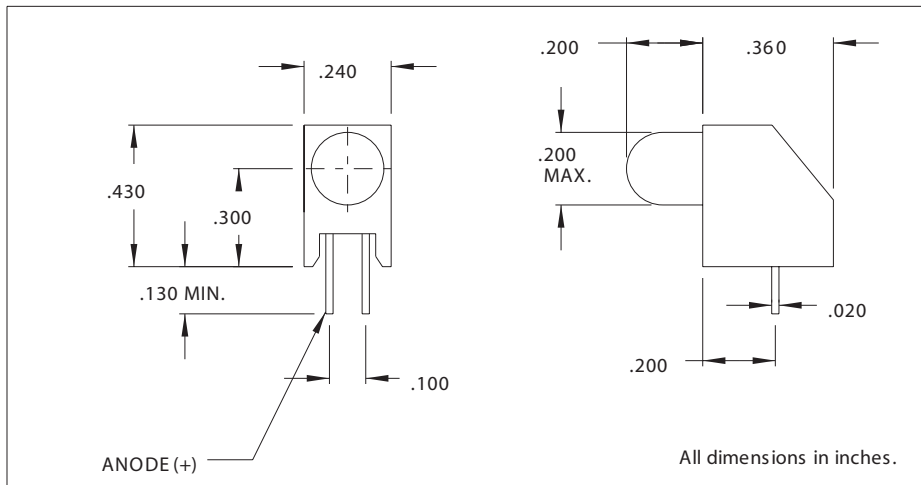

#### Features

- Block mounting, low profile design, and height and spacing alignment saves assembly cost and time.
- Super Brite LEDs
- Built-in resistor operates directly off 5V supply without external resistor.
- Standoffs prevent flux entrapment.
- RoHS Compliant

Housing: Black Nylon, UL94V-O

Alternate LEDs are also available in this package as a standard variation.

## Electro-Optical Characteristics and Ratings

Part Number	Color	Typ. Intensity (mcd)	Rated Current (mA)	Continuous Forward Current Max. (mA)	Forward Voltage Typ. (V)	Forward Voltage Max. (V)	Peak Forward Current @ 1ms-300pps (A)	Reverse Break-down Voltage Min. (V)	Peak Wavelength (nm)
5306H1	Red	6.3	10	60	2.0	3.0	1.0	5	650
5306H3	Amber	10	10	60	2.0	3.0	1.0	5	608
5306H5	Green	10	10	60	2.2	3.0	.09	5	563
5306H7	Yellow	6.3	10	60	2.1	3.0	1.0	5	585
5306H1LC	Red	2.3	2.0	7	1.8	2.2	.007	5	635
5306H5LC	Green	2.3	2.0	7	1.8	2.2	.007	5	565
5306H7LC	Yellow	2.1	2.0	7	1.9	2.7	.007	5	583
5306H1-5V	Red	8	10	15	5	7.5	-	5	635
5306H3-5V	Amber	8	10	15	5	7.5	-	5	583
5306H5-5V	Green	8	10	15	5	7.5	-	5	565