



Chipsmall Limited consists of a professional team with an average of over 10 year of expertise in the distribution of electronic components. Based in Hongkong, we have already established firm and mutual-benefit business relationships with customers from,Europe,America and south Asia,supplying obsolete and hard-to-find components to meet their specific needs.

With the principle of “Quality Parts,Customers Priority,Honest Operation,and Considerate Service”,our business mainly focus on the distribution of electronic components. Line cards we deal with include Microchip,ALPS,ROHM,Xilinx,Pulse,ON,Everlight and Freescale. Main products comprise IC,Modules,Potentiometer,IC Socket,Relay,Connector.Our parts cover such applications as commercial,industrial, and automotives areas.

We are looking forward to setting up business relationship with you and hope to provide you with the best service and solution. Let us make a better world for our industry!



Contact us

Tel: +86-755-8981 8866 Fax: +86-755-8427 6832

Email & Skype: info@chipsmall.com Web: www.chipsmall.com

Address: A1208, Overseas Decoration Building, #122 Zhenhua RD., Futian, Shenzhen, China





5390 Series T-1 3/4 Right Angle LED Assembly

DESCRIPTION AND FEATURES

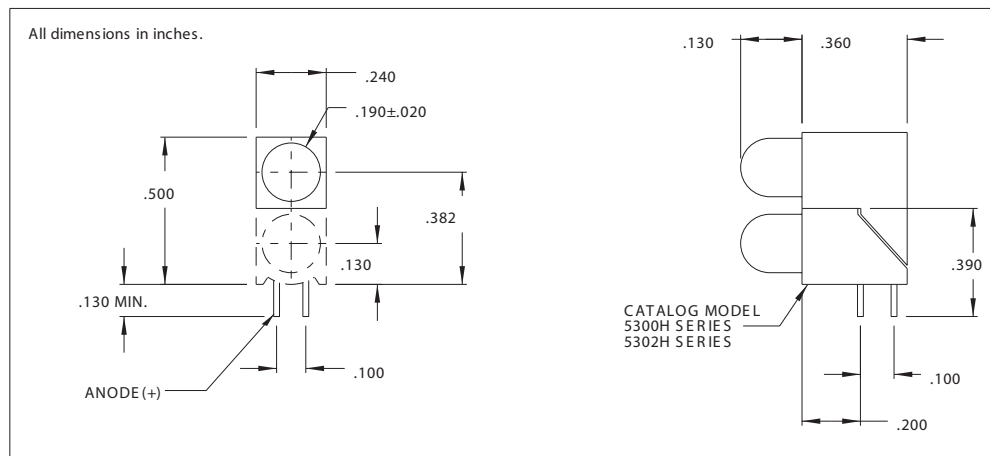

Note: 5390 Series piggy-back block slides onto 5300H block, must be pre-assembled before inserting in PC board.

Features

- Piggy back mounts on 5300E and H Series; 5307H, 5308H, 5640E and H Series.
- Easy installation-slides onto 5300 series blocks.
- Allows 2 LEDs in the same board area required for a single LED.
- Diffused lens provides high contrast ratio, high light output.

Housing: Black Nylon

Alternate LEDs are also available in this package as a standard variation.

ELECTRO-OPTICAL CHARACTERISTICS AND RATINGS

Part Number	Color	Typ. Intensity (mcd)	Rated Current (mA)	Continuous Forward Current Max. (mA)	Forward Voltage Typ. (V)	Forward Voltage Max. (V)	Reverse Break-down Voltage Min. (V)	Peak Wavelength (nm)
5390H1	Red	6.3	10	60	2.0	3.0	5	650
5390H3	Amber	10	10	60	2.0	3.0	5	608
5390H5	Green	10	10	60	2.2	3.0	5	563
5390H7	Yellow	6.3	10	60	2.1	3.0	5	585
5390H1LC	Red	2.3	2.0	7	1.8	2.2	5	635
5390H5LC	Green	2.3	2.0	7	1.8	2.2	5	565
5390H7LC	Yellow	2.1	2.0	7	1.9	2.7	5	585
5390H1-5V	Red	8	10	15	5	7.5	5	635
5390H3-5V	Amber	8	10	15	5	7.5	5	583
5390H5-5V	Green	8	12	15	5	7.5	5	565