



Chipsmall Limited consists of a professional team with an average of over 10 year of expertise in the distribution of electronic components. Based in Hongkong, we have already established firm and mutual-benefit business relationships with customers from,Europe,America and south Asia,supplying obsolete and hard-to-find components to meet their specific needs.

With the principle of “Quality Parts,Customers Priority,Honest Operation,and Considerate Service”,our business mainly focus on the distribution of electronic components. Line cards we deal with include Microchip,ALPS,ROHM,Xilinx,Pulse,ON,Everlight and Freescale. Main products comprise IC,Modules,Potentiometer,IC Socket,Relay,Connector.Our parts cover such applications as commercial,industrial, and automotives areas.

We are looking forward to setting up business relationship with you and hope to provide you with the best service and solution. Let us make a better world for our industry!



Contact us

Tel: +86-755-8981 8866 Fax: +86-755-8427 6832

Email & Skype: info@chipsmall.com Web: www.chipsmall.com

Address: A1208, Overseas Decoration Building, #122 Zhenhua RD., Futian, Shenzhen, China



THIS DRAWING IS UNPUBLISHED. RELEASED FOR PUBLICATION
 © COPYRIGHT - By - ALL RIGHTS RESERVED.

| LOC | | DIST | | REVISIONS | | | |
|-----|-----|---------------------------|--|-----------|-----|------|--|
| P | LTR | DESCRIPTION | | DATE | DWN | APVD | |
| | V2 | REVISED PER ECO-11-004917 | | 11MAR11 | RK | HMR | |

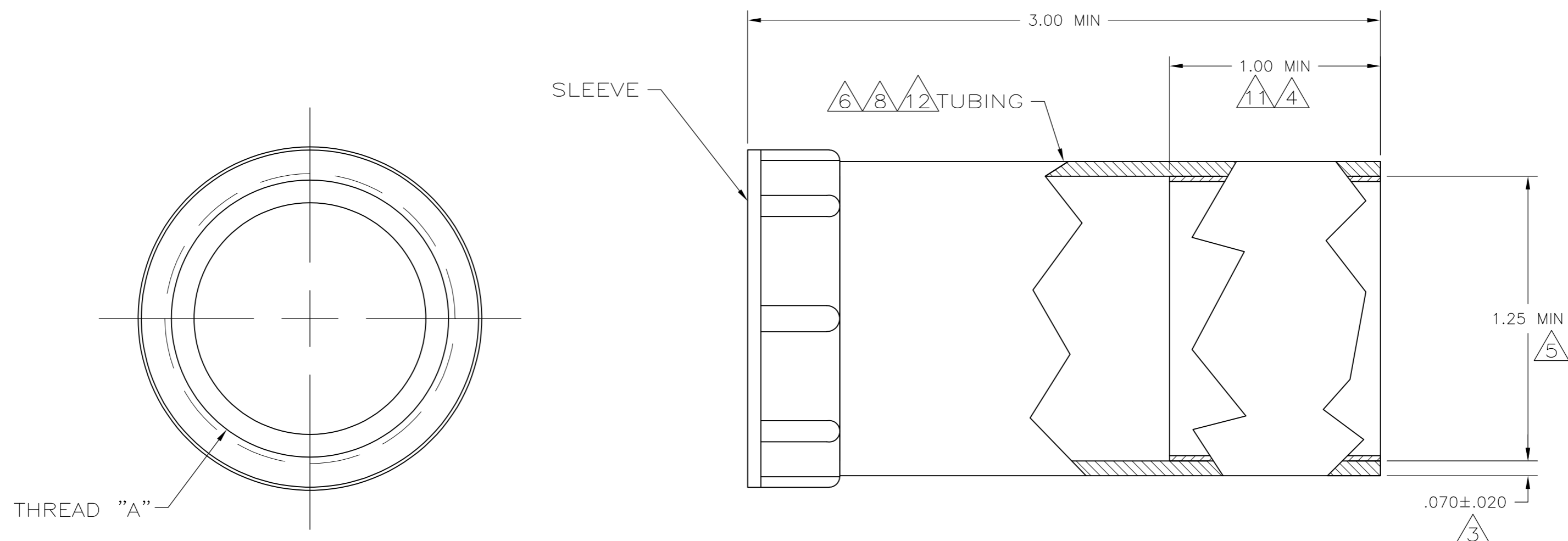

- NOTES:**
- 1 POLYOLEFIN, BLACK.
 - 2 NYLON, BLACK.
 - 3 NOMINAL WALL THICKNESS, EXPANDED.
 - 4 LENGTH OF SEALANT.
 - 5 EXPANDED INSIDE DIAMETER.
 - 6 12.70[.500] MAXIMUM RECOVERED INSIDE DIAMETER.
 - 7. ASSEMBLY WILL PASS 0.0703 KG PER SQ CENTIMETER [ONE POUND PER SQ IN.] WATER PRESSURE TEST.
 - 8 121°C [250°F] SHRINK TEMPERATURE.
 - 9. -55°C TO 110°C [-67°F TO 230°F] OPERATING TEMPERATURE.
 - 10. THIS PART WILL ACCOMODATE $\phi 13.97 - \phi 31.75$ [$\phi .550 - \phi 1.250$] CABLE RANGE.
 - 11 NO SEALANT APPLIED.
 - 12 ACTUAL SHAPE MAY VARY DUE TO PROCESS VARIANCE.
 - 13 OBSOLETE PARTS: OBSOLETE CIS STREAMLINING PER D.RENAUD/D.SINISI

| | | | |
|-------------|----|-------------------|-------------|
| 13 OBSOLETE | 11 | 1 7/16-18 UNEF-2B | 54012-6 |
| 13 OBSOLETE | 11 | 1 3/8-18 UNEF-2B | 54012-5 |
| | | 1 7/16-18 UNEF-2B | 54012-4 |
| 13 OBSOLETE | | 1 3/16-18 UNEF-2B | 54012-3 |
| | | 1 3/8-18 UNEF-2B | 54012-1 |
| | | THREAD "A" | PART NUMBER |

| | | | | |
|--|--|----------------------------------|---|---------------------|
| THIS DRAWING IS A CONTROLLED DOCUMENT. | | DWN C.REIFSNYDER 10 APR 96 | TE TE Connectivity | |
| DIMENSIONS: INCHES | | CHK R.STONE 15 APR 95 | | |
| TOLERANCES UNLESS OTHERWISE SPECIFIED: | | APVD T.A.WETZEL 03 MAY 96 | NAME STRAIN RELIEF ASSY, SHELL SIZE 23, CPC | |
| 0 PLC ± - | | PRODUCT SPEC | SIZE A2 | |
| 1 PLC ± - | | APPLICATION SPEC | CAGE CODE 00779 | DRAWING NO 54012 |
| 2 PLC ± - | | WEIGHT | RESTRICTED TO | |
| 3 PLC ± - | | FINISH | SCALE 2:1 | |
| 4 PLC ± - | | | SHEET 1 of 1 | |
| ANGLES ± - | | CUSTOMER DRAWING | REV V2 | |