



Chipsmall Limited consists of a professional team with an average of over 10 year of expertise in the distribution of electronic components. Based in Hongkong, we have already established firm and mutual-benefit business relationships with customers from,Europe,America and south Asia,supplying obsolete and hard-to-find components to meet their specific needs.

With the principle of “Quality Parts,Customers Priority,Honest Operation,and Considerate Service”,our business mainly focus on the distribution of electronic components. Line cards we deal with include Microchip,ALPS,ROHM,Xilinx,Pulse,ON,Everlight and Freescale. Main products comprise IC,Modules,Potentiometer,IC Socket,Relay,Connector.Our parts cover such applications as commercial,industrial, and automotives areas.

We are looking forward to setting up business relationship with you and hope to provide you with the best service and solution. Let us make a better world for our industry!



## Contact us

Tel: +86-755-8981 8866 Fax: +86-755-8427 6832

Email & Skype: info@chipsmall.com Web: www.chipsmall.com

Address: A1208, Overseas Decoration Building, #122 Zhenhua RD., Futian, Shenzhen, China



| ASSEMBLY NUMBER | LED COLOR                    | DIM. "A" | DIM. "B" | DIM. "C" | LUM. INT. (MUNIMOD) | V <sub>F</sub> (MAX) (V) | I <sub>F</sub> (MAX) (mA) | A <sub>VIEW</sub> (mm) | TEST. COND. | I <sub>F</sub> (MAX) @ 5V(μA) |
|-----------------|------------------------------|----------|----------|----------|---------------------|--------------------------|---------------------------|------------------------|-------------|-------------------------------|
| 550-0204        | GREEN DIFFUSED               | .135     | .020     | .043     | 3.5                 | 2.8                      |                           | 560                    | 20mA        | 100                           |
| 550-0304        | YELLOW DIFFUSED              | .135     | .020     | .043     | 3.5                 | 2.8                      |                           | 585                    | 20mA        | 100                           |
| 550-0404        | RED DIFFUSED                 | .135     | .020     | .043     | 3.5                 | 2.8                      |                           | 635                    | 20mA        | 100                           |
| 550-0504        | RED DIFFUSED 5 VOLT          | .197     | .025     | .050     | 1.0                 |                          | 20                        | 655                    | 5V          | 100                           |
| 550-0604        | RED DIFFUSED 12 VOLT         | .197     | .025     | .050     | 1.0                 |                          | 20                        | 655                    | 12V         | 100                           |
| 550-0704        | GREEN DIFFUSED 5 VOLT        | .197     | .025     | .050     | 2.0                 |                          | 15                        | 565                    | 5V          | 100                           |
| 550-0804        | YELLOW DIFFUSED 5 VOLT       | .197     | .025     | .050     | 2.0                 |                          | 15                        | 583                    | 5V          | 100                           |
| *550-1004       | BLUE NON-DIFF. WATER CLEAR   | .193     | .020     | .043     | 520                 | 4.0                      |                           | 470                    | 20mA        | 100                           |
| 550-1104        | RED TINTED DIFFUSED 2mA      | .197     | .018     | .040     | 1.2                 | 2.2                      |                           | 635                    | 2mA         | 50                            |
| 550-1204        | YELLOW TINTED DIFFUSED 2mA   | .197     | .018     | .040     | 2.2                 | 2.7                      |                           | 583                    | 2mA         | 50                            |
| 550-1304        | GREEN DIFFUSED 2mA           | .197     | .018     | .040     | 2.2                 | 2.2                      |                           | 565                    | 2mA         | 50                            |
| 550-2204        | GREEN DIFFUSED               | .190     | .020     | .043     | 3.6                 | 3.0                      |                           | 563                    | 10mA        |                               |
| 550-2304        | YELLOW DIFFUSED              | .190     | .020     | .043     | 2.2                 | 3.0                      |                           | 585                    | 10mA        | 100                           |
| 550-2404        | RED DIFFUSED                 | .190     | .020     | .043     | 2.2                 | 2.55                     |                           | 650                    | 10mA        | 100                           |
| 550-2504        | ORANGE DIFFUSED              | .197     | .018     | .040     | 4.0                 | 2.4                      |                           | 600                    | 10mA        | 100                           |
| 550-3004        | RED/GREEN BI-COLOR           | .190     | .020     | .043     | 14/9                | 2.4/2.8                  |                           | 660/565                | 20mA        | 100                           |
| 550-3104        | YEL/GREEN BI-COLOR           | .190     | .020     | .043     | 2.5                 | 2.8                      |                           | 585/565                | 20mA        | 100                           |
| 550-5104        | RED DIFFUSED                 | .190     | .020     | .043     | 17                  | 2.55                     |                           | 650                    | 20mA        | 10                            |
| 550-5204        | GREEN TINTED DIFFUSED        | .190     | .020     | .043     | 17                  | 3.0                      |                           | 563                    | 20mA        | 10                            |
| 550-5304        | YELLOW TINTED DIFFUSED       | .190     | .020     | .043     | 17                  | 3.0                      |                           | 585                    | 20mA        | 10                            |
| 550-5404        | AMBER TINTED DIFFUSED        | .190     | .020     | .043     | 17                  | 3.0                      |                           | 610                    | 20mA        | 10                            |
| 550-5504        | RED NON-DIFF. WATER CLEAR    | .197     | .018     | .040     | 80                  | 3.0                      |                           | 635                    | 20mA        | 100                           |
| 550-5604        | GREEN NON-DIFF. WATER CLEAR  | .197     | .018     | .040     | 80                  | 3.0                      |                           | 585                    | 20mA        | 100                           |
| 550-5704        | YELLOW NON-DIFF. WATER CLEAR | .197     | .018     | .040     | 80                  | 3.0                      |                           | 583                    | 20mA        | 100                           |
| 550-5804        | AMBER NON-DIFF. WATER CLEAR  | .190     | .024     | .050     | 60                  | 2.5                      |                           | 605                    | 20mA        |                               |

SEE NOTE 4

| REV. | ECN NO. | REVISIONS  | DRN. | CKD. | APP. | DATE   |
|------|---------|--|------|------|------|--------|
| A    |         | NEW RELEASE  | DC   | MC   | NO   | 5-3-00 |
| B    |         | ADDED P/N 550-1004. ADDED NOTE 4. NOTE 5 WAS 4. ADDED BACK VIEW. | JAV  |      |      |        |

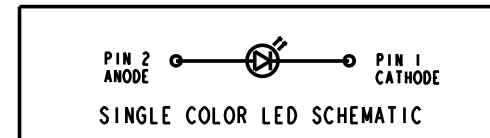
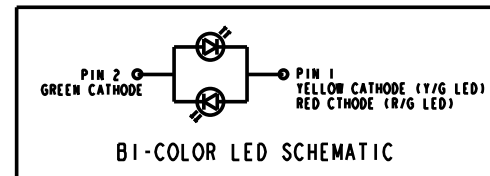
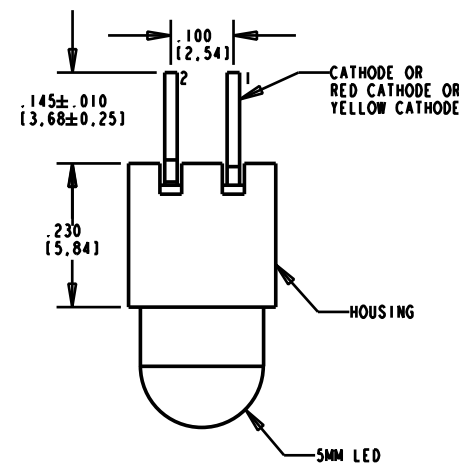

NOTES:

- LEADS TO FIT INTO HOLE PATTERN AS SHOWN.
- LED LEAD DIMENSIONS SHOWN ARE MEASURED AT HOUSING EXIT.
- PIN NUMBERS FOR REFERENCE ONLY, DESIGNATION NON-EXISTENT ON PARTS.
- ATTENTION: OBSERVE PRECAUTIONS FOR HANDLING ELECTROSTATIC SENSITIVE DEVICES. FOR EYE SAFETY DO NOT STARE DIRECTLY INTO THE LIGHT BEAM OF THESE LED DEVICES AT CLOSE RANGE.
- DIALIGHT PART NUMBER: 550-0204 THRU 550-5804

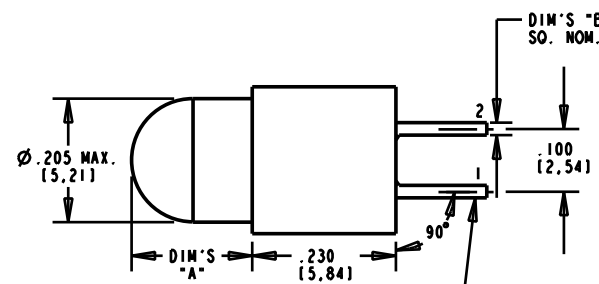
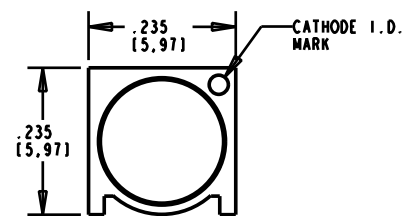

CATHODE LEAD FOR SINGLE COLOR  
RED CATHODE FOR  
RED/GRN BI-COLOR  
YELLOW CATHODE FOR  
YEL/GRN BI-COLOR

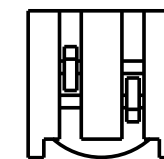
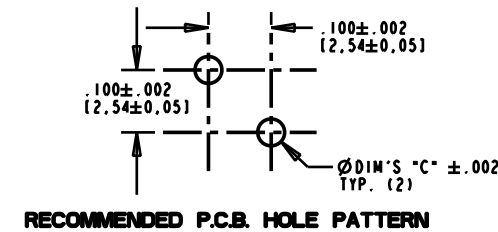

|   |   |                         |
|---|---|-------------------------|
| THIS DRAWING AND THE CONTENTS HEREIN ARE CONFIDENTIAL AND THE SOLE PROPERTY OF DIALIGHT. REPRODUCTION OF THIS DRAWING OR CONSTRUCTION OF ANY PARTS WITHIN THIS DRAWING ARE FORBIDDEN WITHOUT THE WRITTEN CONSENT OF DIALIGHT. |   |                         |
| SCALE: 5:1  | DRAWING NUMBER                            | REV                     |
| ALL DIM'S IN: INCHES (MM)   | C-16650                                   | B                       |
| TOLERANCES: UNLESS OTHERWISE SPECIFIED  | TITLE                                     |                         |
| FRACTIONS: ±1/64  | 5mm LED CBI, TOP VIEW                     |                         |
| DECIMALS (.XXX): ±.020  | MATERIAL                                  |                         |
| DECIMALS (.XXXX): ±.015   | Dialight                                  |                         |
| DECIMALS (.XXXXX): ±.0005   | 1501 ROUTE 34 SOUTH FARMINGDALE, NJ 07727 |                         |
| ANGLES: ±3°   | FSCN 83330                                | SHEET OF FAMILY TABLES: |