



Chipsmall Limited consists of a professional team with an average of over 10 year of expertise in the distribution of electronic components. Based in Hongkong, we have already established firm and mutual-benefit business relationships with customers from,Europe,America and south Asia,supplying obsolete and hard-to-find components to meet their specific needs.

With the principle of “Quality Parts,Customers Priority,Honest Operation,and Considerate Service”,our business mainly focus on the distribution of electronic components. Line cards we deal with include Microchip,ALPS,ROHM,Xilinx,Pulse,ON,Everlight and Freescale. Main products comprise IC,Modules,Potentiometer,IC Socket,Relay,Connector.Our parts cover such applications as commercial,industrial, and automotives areas.

We are looking forward to setting up business relationship with you and hope to provide you with the best service and solution. Let us make a better world for our industry!



## Contact us

Tel: +86-755-8981 8866 Fax: +86-755-8427 6832

Email & Skype: info@chipsmall.com Web: www.chipsmall.com

Address: A1208, Overseas Decoration Building, #122 Zhenhua RD., Futian, Shenzhen, China



## SURFACE MOUNT BATTERY CLIPS/CONTACTS

AVAILABLE ON TAPE AND REEL

- "Flow-Hole" SMT solder tail design for increased joint strength
- Tin-Nickel plating is ideal for lead free, high temperature soldering
- Matte Tin Plate for lower soldering temperatures ideal where other temperature sensitive components are being used



Refer to page 34 for Battery Contact Layout & Mounting Details

"AAAA" - "A27"

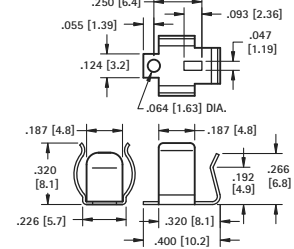

**MATERIAL:** .010 (.25) Spring Steel

TIN-NICKEL PLATE		MATTE TIN PLATE	
CAT. NO.	ON TAPE & REEL	CAT. NO.	ON TAPE & REEL
<b>50</b>	<b>50TR</b>	<b>550</b>	<b>550TR</b>

**Tape & Reel Spec's:** 24mm wide; 16mm pitch; 13 inch reel, (500 pieces per reel)

Pad Layout

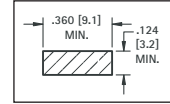

"AAA" - "N" - "A23"

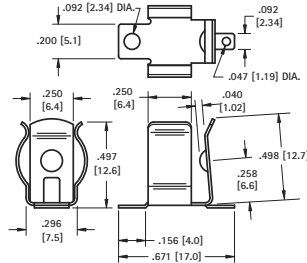

**MATERIAL:** .010 (.25) Spring Steel

TIN-NICKEL PLATE		MATTE TIN PLATE	
CAT. NO.	ON TAPE & REEL	CAT. NO.	ON TAPE & REEL
<b>55</b>	<b>55TR</b>	<b>555</b>	<b>555TR</b>

**Tape & Reel Spec's:** 32mm wide; 16mm pitch; 13 inch reel, (300 pieces per reel)

Pad Layout

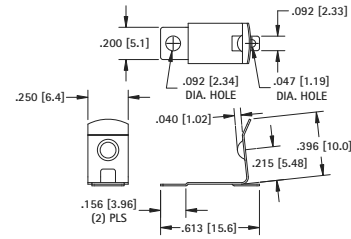
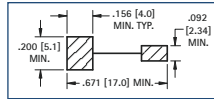

**MATERIAL:** .010 (.25) Spring Steel

TIN-NICKEL PLATE		MATTE TIN PLATE	
CAT. NO.	ON TAPE & REEL	CAT. NO.	ON TAPE & REEL
<b>56</b>	<b>56TR</b>	<b>556</b>	<b>556TR</b>

**Tape & Reel Spec's:** 32mm wide; 20mm pitch; 13 inch reel, (250 pieces per reel)

Pad Layout

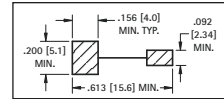

"AA" - "CR2" - "A"

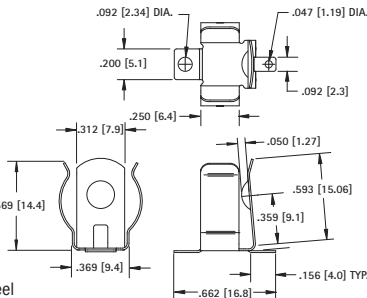

**MATERIAL:** .012 (.30) Spring Steel

TIN-NICKEL PLATE		MATTE TIN PLATE	
CAT. NO.	ON TAPE & REEL	CAT. NO.	ON TAPE & REEL
<b>53</b>	<b>53TR</b>	<b>553</b>	<b>553TR</b>

**Tape & Reel Spec's:** 32mm wide; 24mm pitch; 13 inch reel, (150 pieces per reel)

Pad Layout

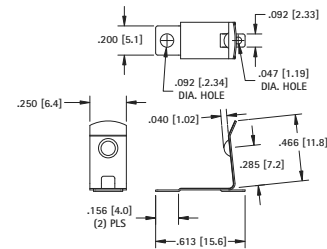
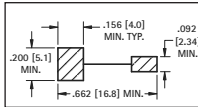

**MATERIAL:** .010 (.25) Spring Steel

TIN-NICKEL PLATE		MATTE TIN PLATE	
CAT. NO.	ON TAPE & REEL	CAT. NO.	ON TAPE & REEL
<b>57</b>	<b>57TR</b>	<b>557</b>	<b>557TR</b>

**Tape & Reel Spec's:** 32mm wide; 20mm pitch; 13 inch reel, (250 pieces per reel)

Pad Layout

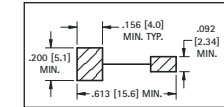

## SURFACE MOUNT LEAF-SPRING CONTACTS

AVAILABLE ON TAPE AND REEL

- Economical & reliable contacts are ideal for surface mount applications
- Unique spring tension contacts adjust to variations in battery length
- Reliable spring tension contacts assure low contact resistance
- SMT solder tail with "flow-hole" design for increased joint strength

"AAA" - "AAAA" - "A23" - "N"

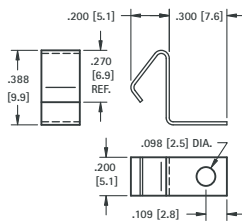

**MATERIAL:** .010 (.25) Spring Steel

TIN-NICKEL PLATE		MATTE TIN PLATE	
CAT. NO.	ON TAPE & REEL	CAT. NO.	ON TAPE & REEL
<b>5230</b>	<b>5230TR</b>	<b>5330</b>	<b>5330TR</b>

**Tape and Reel Spec's:** 24mm wide; 12mm pitch; 13 inch reel (400 pieces per reel)

"AA" - "CR2" - "A" - "9V"

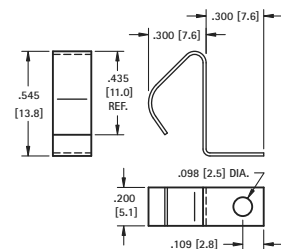

**MATERIAL:** .010 (.25) Spring Steel

TIN-NICKEL PLATE		MATTE TIN PLATE	
CAT. NO.	ON TAPE & REEL	CAT. NO.	ON TAPE & REEL
<b>5231</b>	<b>5231TR</b>	<b>5331</b>	<b>5331TR</b>

**Tape and Reel Spec's:** 32mm wide; 16mm pitch; 13 inch reel (250 pieces per reel)